

REV.	ECN NO OR DESCRIPTION	REVISED	DATE
C	修改與實物相符	EVEN	11/14-103

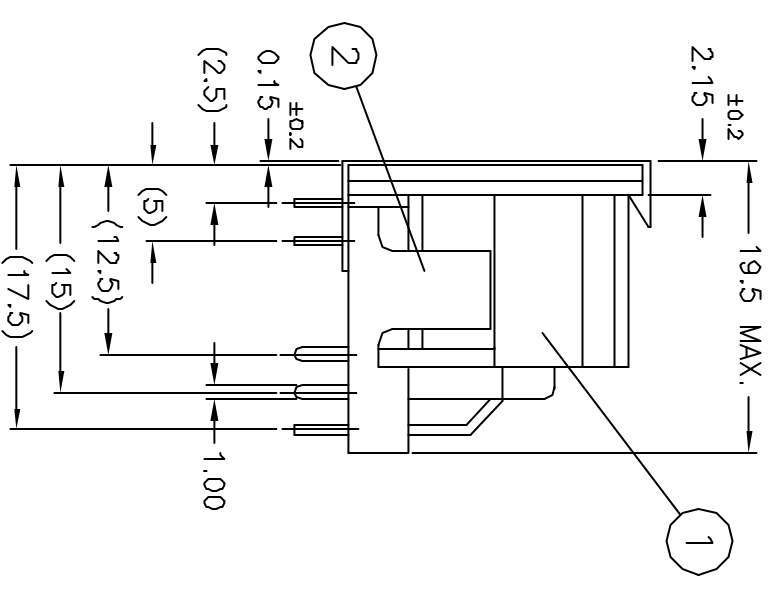
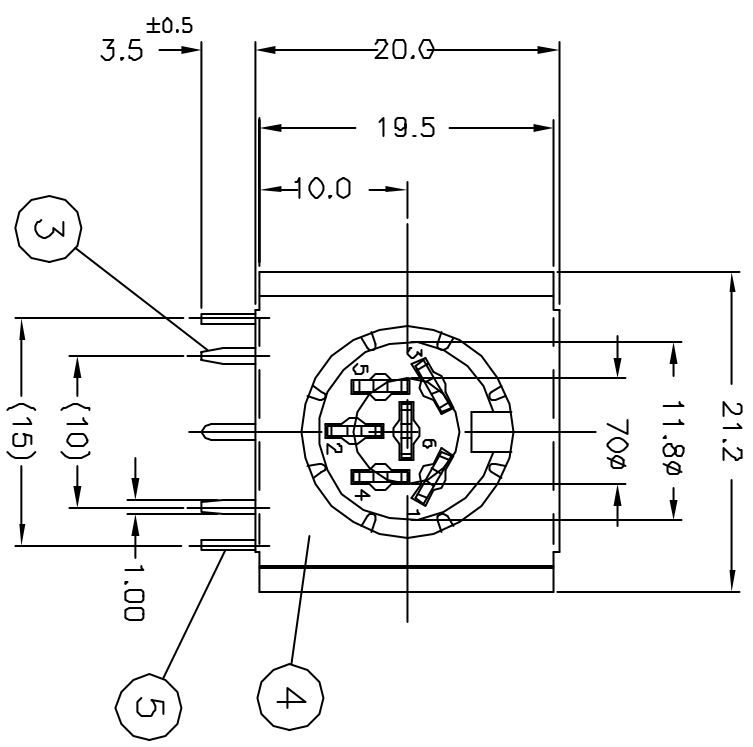
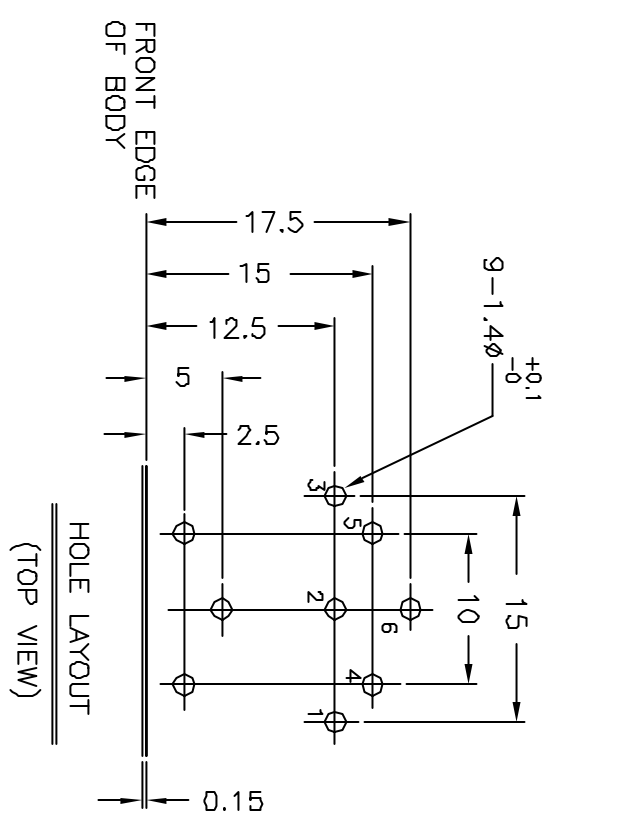

SPECIFICATIONS:

1. CURRENT CARRYING CAPACITY:
 - 1) AC: 100V 1A MAX.
 - 2) DC: 24V 2A MAX.
2. CONTACT RESISTANCE:
 - 1) INITIAL, BEFORE LIFE CYCLE TEST. CONTACTOR TO PLUG PIN: 20mΩ MAX. EARTH TERMINAL TO PLUG SHELL: 100mΩ MAX.
 - 2) AFTER LIFE CYCLE TEST. CONTACTOR TO PLUG PIN: 100mΩ MAX. EARTH TERMINAL TO PLUG SHELL: 150mΩ MAX.
3. INSULATION RESISTANCE:

BETWEEN ANY ADJACENT OPEN CONTACTS SHALL NOT BE LESS THAN 100MΩ AS SPECIFIED BELOW WITH AT 500V DC INSULATION RESISTANCE TEST.
4. DIELECTRIC STRENGTH:

A POTENTIAL OF 500V AC RMS. 50/60HZ SHALL BE APPLIED BETWEEN ANY OPEN CONTACTS FOR ONE MINUTE WITHOUT BREAKDOWN.
5. INSERTION FORCE: 5.0kg MAX.
6. WITHDRAWAL FORCE: 1.0kg MIN.
7. LIFE CYCLE TEST:

CONNECTOR SHALL BE SUBJECT TO 5,000 CYCLES AT 10 TO 20 CYCLES PER MINUTE WITH NO ELECTRICAL LOAD.

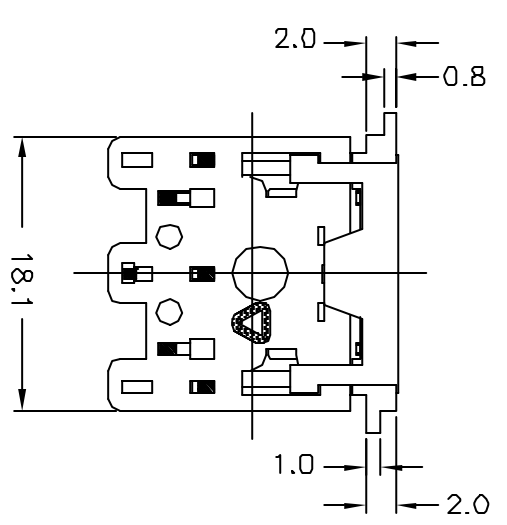

NO	DESCRIPTION	QTY	MATERIAL	PLATING & COLOR
1	BODY	1	PBT UL 94V-0	BLACK COLOR
2	COVER	1	PBT UL 94V-0	BLACK COLOR
3	EARTH TERMINAL	1	PHOSPHOR BRONZE 0.25t	TIN ALLOY PLATING
4	SHIELDING PLATE	1	PHOSPHOR BRONZE 0.15t	TIN ALLOY PLATING
5	CONTACT TERMINAL	6	BRASS 0.7t	TIN ALLOY PLATING

UNLESS OTHERWISE SPECIFIED TOLERANCES

DECIMALS:	ANGLES:
X : ±0.3	X : ±2°
X.X : ±0.2	X.X : ±1°
X.XX : ±0.1	

Singatron Enterprise Co., Ltd.
信音企業股份有限公司

TITLE: 6P 240° DIN CONNECTOR

DWN	DEN 11/14-103	PART NO.	2DJ-0196PSA2
CHKD	SM 11/18-103	SCALE:	2/1
APVD	AMRY 11/19-103	SIZE:	A3
		SHEET:	1 OF 1
		REV:	C