

LOC		DIST		REVISIONS					
FT		0		P	LTR	DESCRIPTION	DATE	DWN	APVD
				B		REVISED EC 0638-0746-04	04OCT2004	SW	HW
				C		REVISED PER ECO-06-2703	24FEB2006	SS	DC

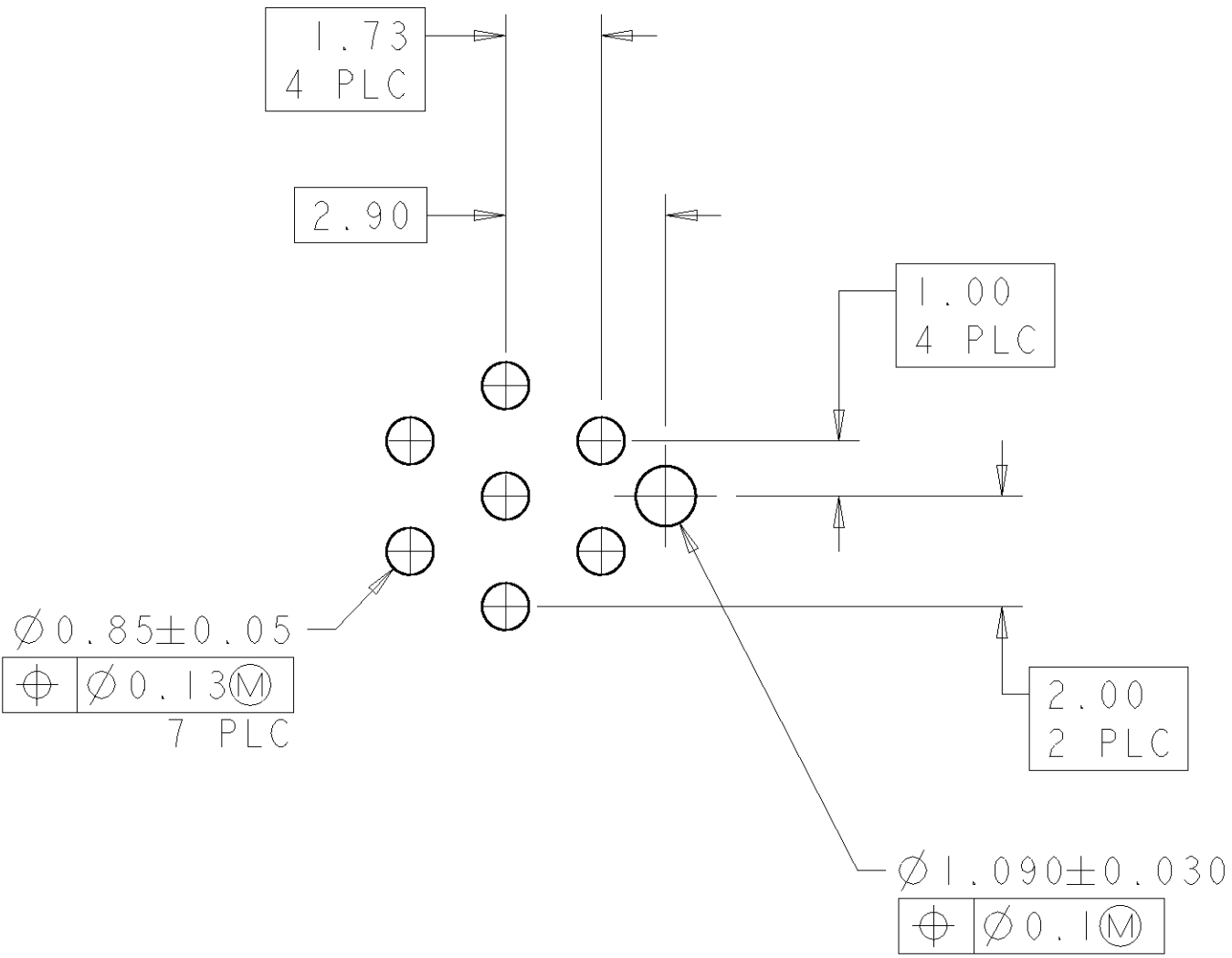
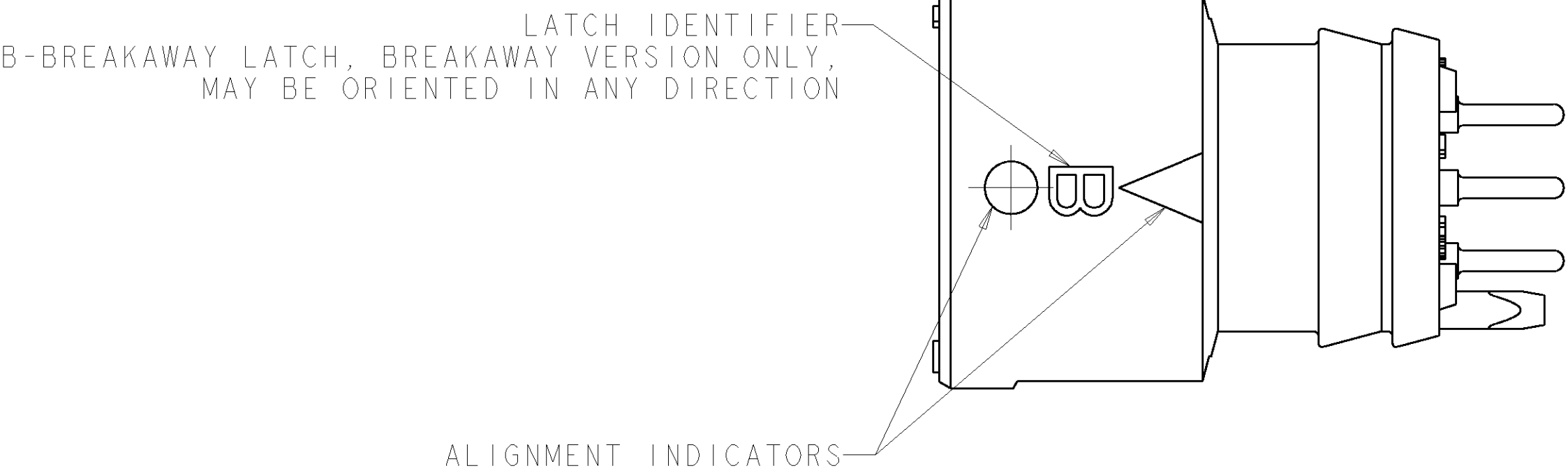

SUGGESTED PRINTED CIRCUIT BOARD LAYOUT

2	1, 7.	TIN OVER NICKEL	30°	WHITE	BREAKAWAY	3-1445323-1
2	1, 7.	TIN OVER NICKEL	0°	BLACK	POSITIVE	3-1445323-0
3	2, 3, 7.	TIN OVER NICKEL	30°	WHITE	BREAKAWAY	2-1445323-9
3	2, 3, 7.	TIN OVER NICKEL	0°	BLACK	POSITIVE	2-1445323-8
4	2, 3, 5, 6.	TIN OVER NICKEL	30°	WHITE	BREAKAWAY	2-1445323-7
4	2, 3, 5, 6.	TIN OVER NICKEL	0°	BLACK	POSITIVE	2-1445323-6
5	2, 3, 4, 5, 6.	TIN OVER NICKEL	30°	WHITE	BREAKAWAY	2-1445323-5
5	2, 3, 4, 5, 6.	TIN OVER NICKEL	0°	BLACK	POSITIVE	2-1445323-4
6	1, 2, 3, 5, 6, 7.	TIN OVER NICKEL	30°	WHITE	BREAKAWAY	2-1445323-3
6	1, 2, 3, 5, 6, 7.	TIN OVER NICKEL	0°	BLACK	POSITIVE	2-1445323-2
7	ALL	TIN OVER NICKEL	30°	WHITE	BREAKAWAY	2-1445323-1
7	ALL	TIN OVER NICKEL	0°	BLACK	POSITIVE	2-1445323-0
2	1, 7.	TIN-LEAD OVER NICKEL	30°	WHITE	BREAKAWAY	1-1445323-2
2	1, 7.	TIN-LEAD OVER NICKEL	0°	BLACK	POSITIVE	1-1445323-1
3	2, 3, 7.	TIN-LEAD OVER NICKEL	30°	WHITE	BREAKAWAY	1-1445323-0
3	2, 3, 7.	TIN-LEAD OVER NICKEL	0°	BLACK	POSITIVE	1445323-09
4	2, 3, 5, 6.	TIN-LEAD OVER NICKEL	30°	WHITE	BREAKAWAY	1445323-08
4	2, 3, 5, 6.	TIN-LEAD OVER NICKEL	0°	BLACK	POSITIVE	1445323-07
5	2, 3, 4, 5, 6.	TIN-LEAD OVER NICKEL	30°	WHITE	BREAKAWAY	1445323-06
5	2, 3, 4, 5, 6.	TIN-LEAD OVER NICKEL	0°	BLACK	POSITIVE	1445323-05
6	1, 2, 3, 5, 6, 7.	TIN-LEAD OVER NICKEL	30°	WHITE	BREAKAWAY	1445323-04
6	1, 2, 3, 5, 6, 7.	TIN-LEAD OVER NICKEL	0°	BLACK	POSITIVE	1445323-03
7	ALL	TIN-LEAD OVER NICKEL	30°	WHITE	BREAKAWAY	1445323-02
7	ALL	TIN-LEAD OVER NICKEL	0°	BLACK	POSITIVE	1445323-01

QTY	CIRCUITS LOADED	FINISH	A	COLOR	LATCH	PART NUMBER
CONTACTS			HOUSING			

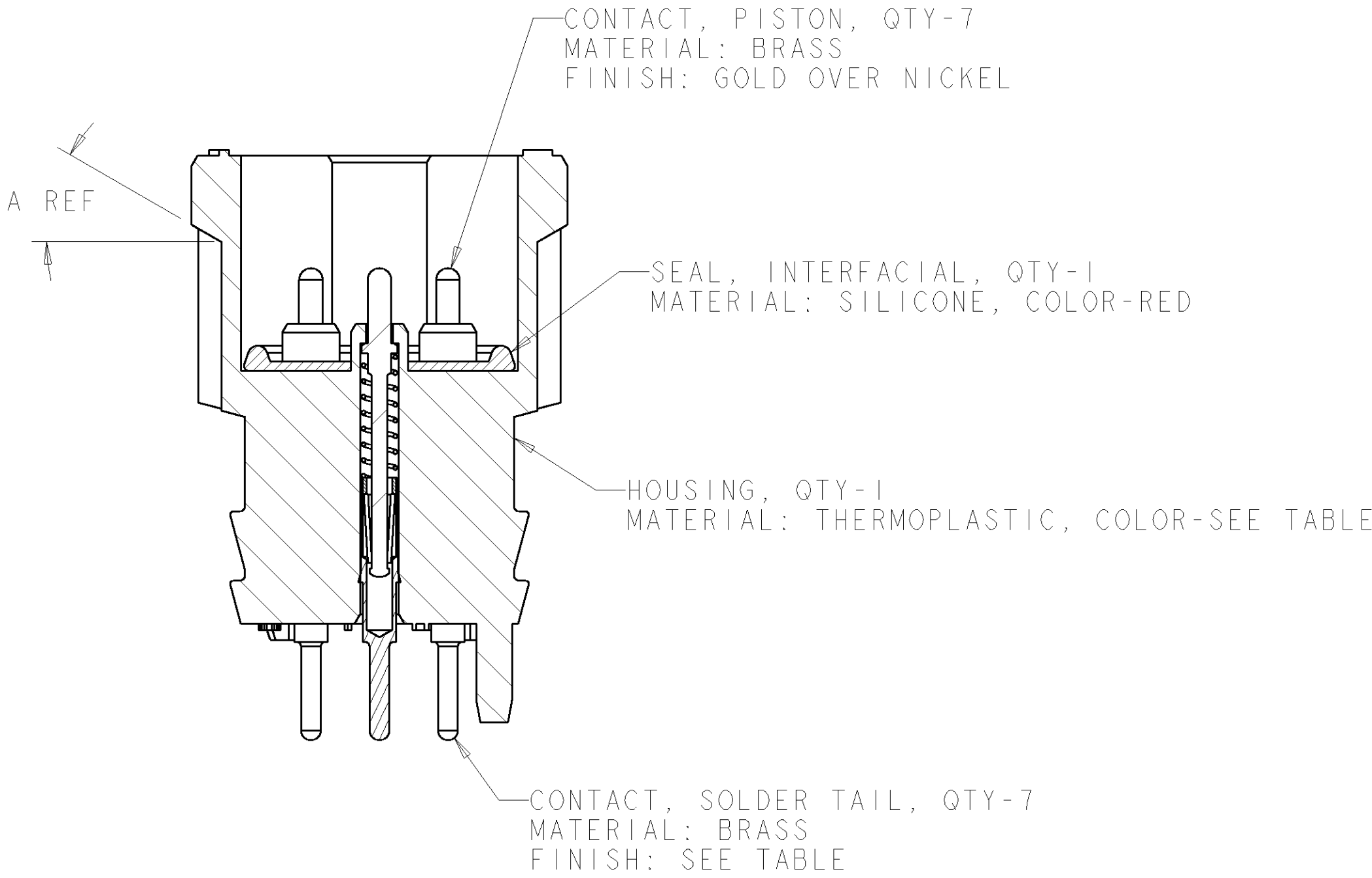
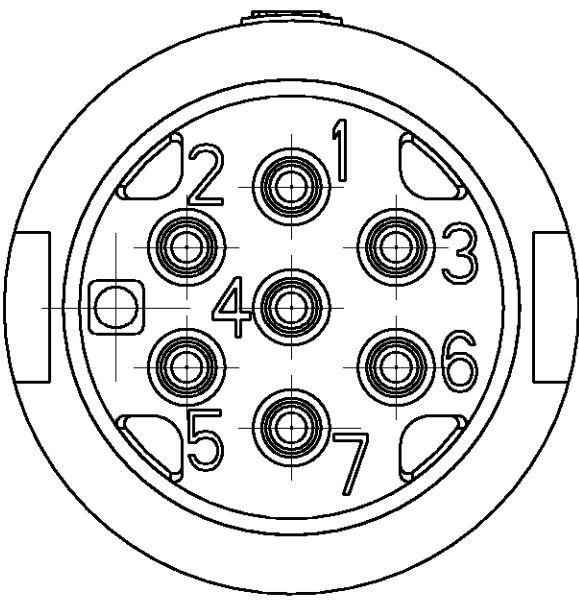
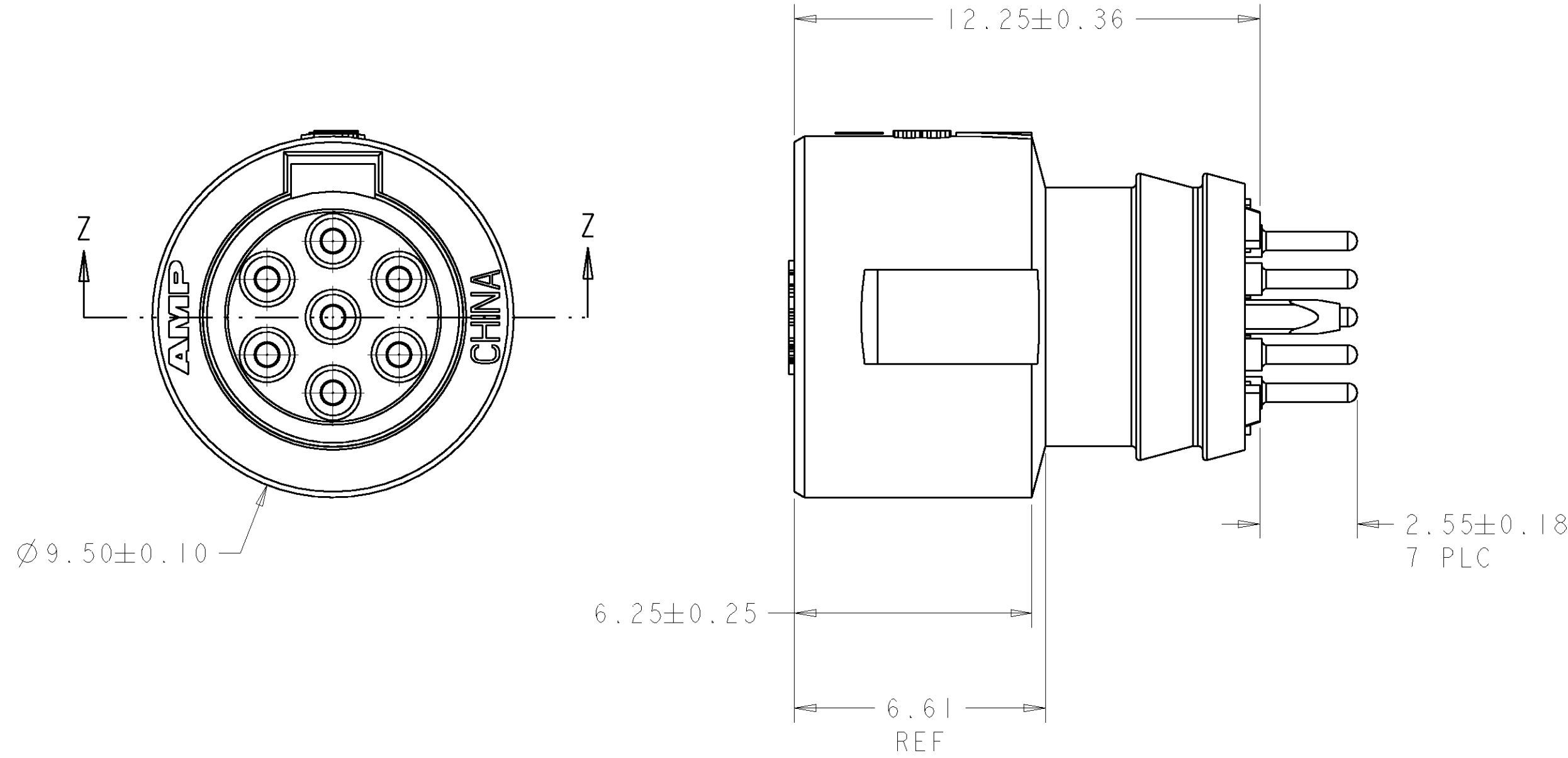

THIS DRAWING IS UNPUBLISHED. IT IS THE PROPERTY OF TYCO ELECTRONICS CORPORATION. IT IS LOANED TO YOU BY TYCO ELECTRONICS CORPORATION. IT IS TO BE USED FOR THE PURPOSES OF THE CONTRACTING ORGANIZATION AND NOT TO BE REPRODUCED OR COPIED IN ANY MANNER WITHOUT THE WRITTEN PERMISSION OF TYCO ELECTRONICS CORPORATION.		DWN G. DOWDY 27JUL2004	15FEB2001	<b>tyco</b> Electronics		Tyco Electronics Harrisburg, PA 17105-3608	
DIMENSIONS: mm		CHK H. WAKEEM 27JUL2004	APVD H. WAKEEM 27JUL2004	NAME		RECEPTACLE ASSEMBLY, 7 POSITION, SPRING PROBE, SOLDER TAIL, MICRO CPC	
TOLERANCES UNLESS OTHERWISE SPECIFIED: 9 PLC ± 1 PLC ±0.13 3 PLC ± 4 PLC ± ANGLES ±		PRODUCT SPEC		APPLICATION SPEC		SIZE CASE CODE DRAWING NO	
MATERIAL SEE CALLOUT		WEIGHT		CUSTOMER DRAWING		RESTRICTED TO	
SEE CALLOUT		A100779C=1445323		SCALE 8:1		SHEET 1 OF 1	
						REV C	