

| REV. | TECH. NO. | DATE | BY | DESCRIPTION |
|------|-----------|------|----|-------------|
|      |           |      |    |             |
|      |           |      |    |             |
|      |           |      |    |             |

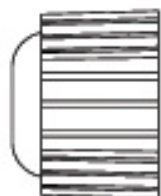

⑤



④

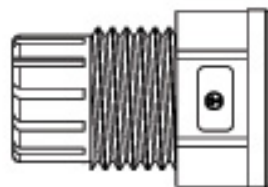

③



②

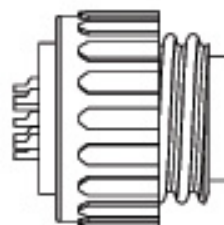

①



Pin Assignments  
Front View 前視圖

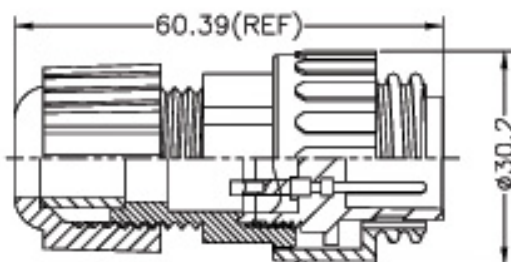

Note:

- \* Ⓞ Important Dimension.  
(Ⓞ 為重點尺寸)
- \* Waterproof Rate: IP67
- \* Connector: Black, Nylon+GF
- \* Pin: Copper Alloy, Gold Plated
- \* Seals for Cable OD:  $\phi 5.5\text{mm} \sim \phi 10.8\text{mm}$   
(防水墊圈限用線徑:  $\phi 5.5\text{mm} \sim \phi 10.8\text{mm}$ )
- \* One Set Unassembled in One PE Bag  
(每一組未組裝, 放置於一個PE袋, 并封口)

|           |               |
|-----------|---------------|
| UNIT : mm |               |
| TOLERANCE |               |
| X         | $\pm 0.25$    |
| XX        | $\pm 0.1$     |
| XXX       | $\pm 0.05$    |
| ANGLES    | $\pm 1^\circ$ |

|       |                          |                     |
|-------|--------------------------|---------------------|
| TITLE | 6+PE Power Connector(8A) |                     |
| SCALE | Free                     | SHEET 1 of 1        |
| REV.  | 01                       | SIZE A4             |
|       |                          | Ⓞ : Inspection Item |

**ASSMANN**  
Electronic Components

|         |                     |             |             |      |            |
|---------|---------------------|-------------|-------------|------|------------|
| ITEM NO | A-P07BMMA-S180-WP-R | DRAWN BY    | Lin Li Qing | DATE | 2006/06/19 |
| DWG NO  |                     | CHECKED BY  | Ling        | DATE | 2006/06/24 |
|         |                     | APPROVED BY | Robert Hsu  | DATE | 2006/06/28 |