

THIS DRAWING IS UNPUBLISHED. RELEASED FOR PUBLICATION
 © COPYRIGHT BY TYCO ELECTRONICS CORPORATION. ALL RIGHTS RESERVED.

LOC	DIST	REVISIONS			
P	LTR	DESCRIPTION	DATE	DWN	APVD
0		FZ00-0011-05, FIRST RELEASED	18JAN05	JL	WK
01		HSG PROFILE ERROR, ECR-07-016162	10JUL07	JL	WK

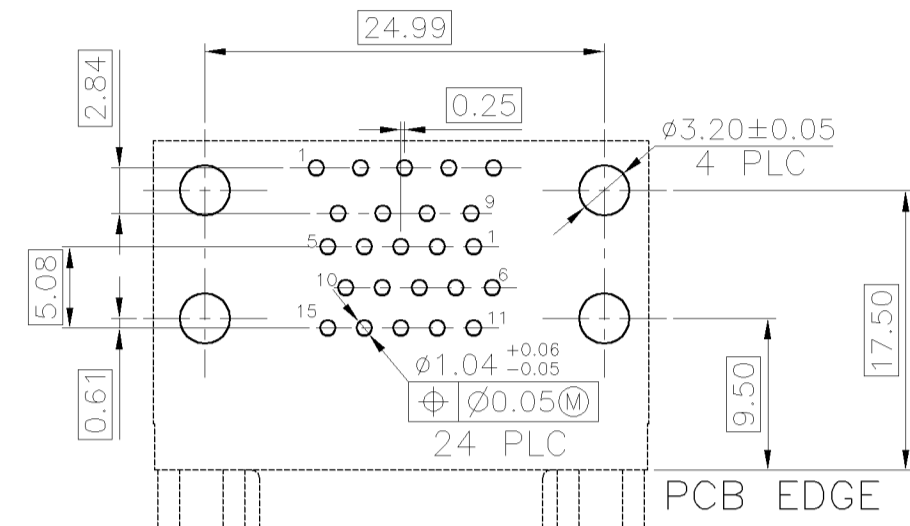
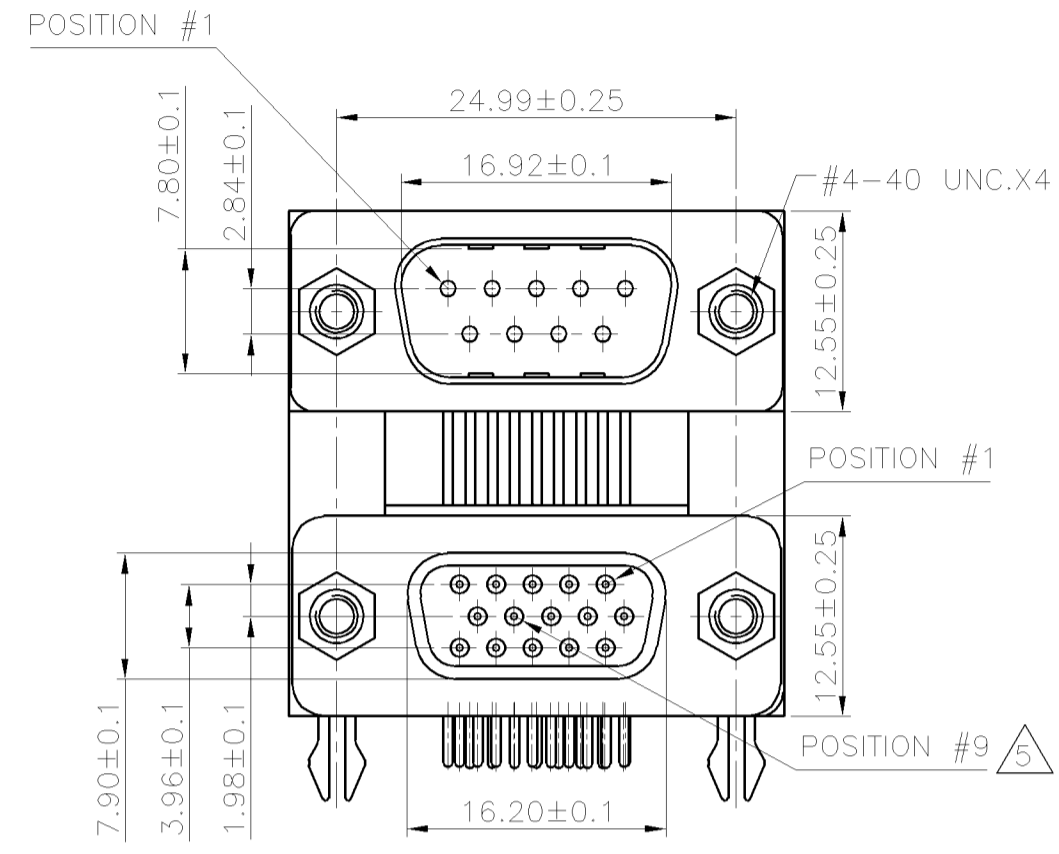

RECOMMENDED PCB LAYOUT

- NOTES:
- MATERIAL:
 HOUSING: THERMOPLASTIC(PBT), UL94V-0.
 PLUG: 9 POS. BLACK.
 RECEPTACLE: 15 POS. BLUE.
 CONTACT:
 PLUG: BRASS.
 RECEPTACLE: PHOSPHOR BRONZE.
 SHELL: STEEL.
 BRACKET: STEEL.
 BOARDLOCK: BRASS.
 SCREW: BRASS.
 - FINISH:
 CONTACT: GOLD(SEE TABLE) PLATED ON CONTACT AREA,
 2.54um[100u"] MIN. BRIGHT TIN PLATED ON SOLDER TAILS,
 1.27um[50u"] MIN. NICKEL UNDERPLATED OVERALL.
 SHELL: 1.52um[60u"] MIN. BRIGHT TIN PLATED.
 BRACKET: 1.52um[60u"] MIN. BRIGHT TIN PLATED.
 BOARDLOCK: 1.52um[60u"] MIN. BRIGHT TIN PLATED.
 SCREW: 0.88um[35u"] MIN. NICKEL PLATED.
 - WAVE SOLDER CAPABLE TO 265°C.
 PER TYCO SPEC. 109-202, CONDITION B.
 - THREADED INSERTS AND SCREWLOCKS MUST WITHSTAND
 5 kg-cm MAX. TORQUE.
- ⚠ CONTACT #9 RECESSED 1.27mm[.080] FROM OTHER CONTACTS ON MATING FACE PLANE.

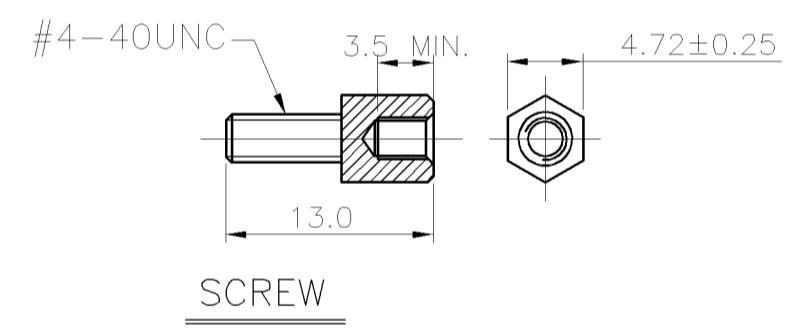
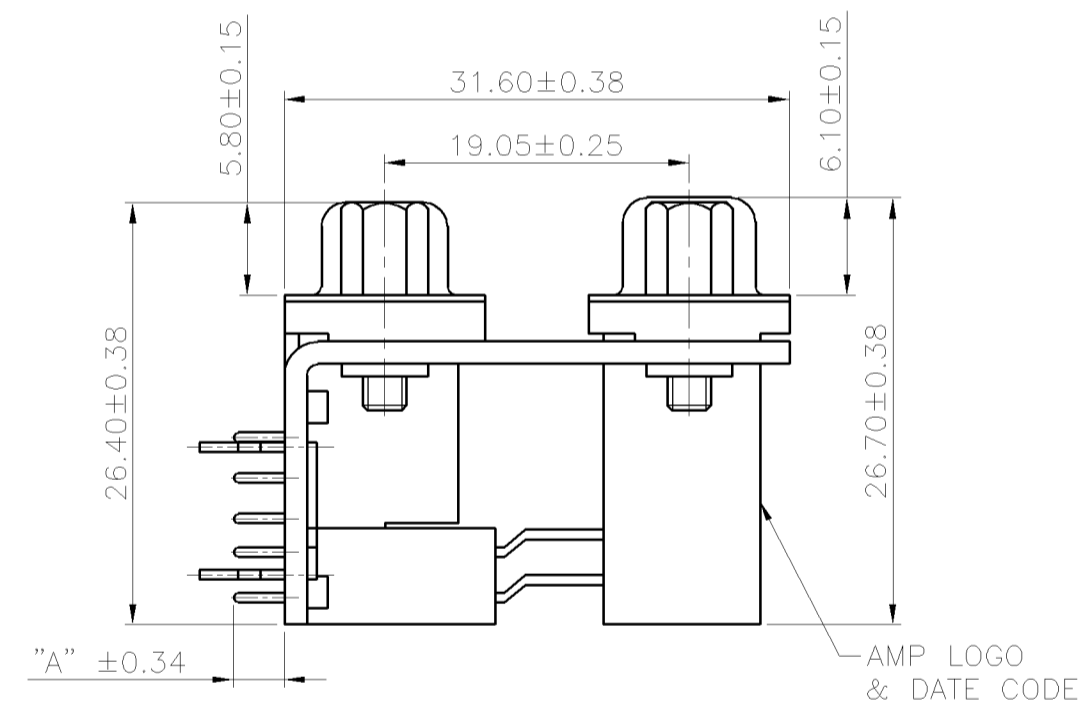
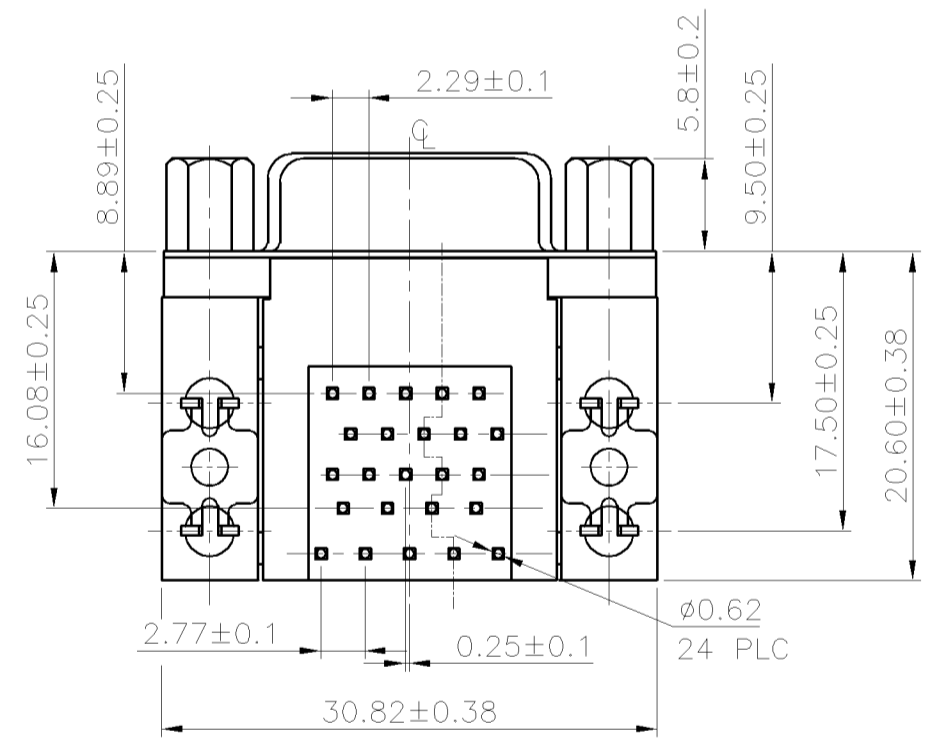

2.54 [0.100]	0.38um[15u"] MIN.	1734842-4
3.18 [0.125]		1734842-3
2.54 [0.100]	0.0254um[1u"] MIN.	1734842-2
3.18 [0.125]		1734842-1
SOLDERTAIL LENGTH "A"	FINISH	PART NUMBER

THIS DRAWING IS A CONTROLLED DOCUMENT.		DWN J. LEE 10JUL2007	Tyco Electronics Corporation Taipei, Taiwan														
DIMENSIONS: MM		CHK S. HOU 10JUL2007	NAME														
TOLERANCES UNLESS OTHERWISE SPECIFIED:		APVD W.J. KE 10JUL2007	STACKED ASSY, 9 POS PLUG OVER 15 POS RCPT, .750 STACK HEIGHT, AMPLIMTE														
<table border="1"> <tr><td>0 PLC</td><td>± 0.5</td></tr> <tr><td>1 PLC</td><td>± 0.3</td></tr> <tr><td>2 PLC</td><td>± 0.2</td></tr> <tr><td>3 PLC</td><td>± 0.15</td></tr> <tr><td>4 PLC</td><td>± -</td></tr> <tr><td>ANGLES</td><td>± 3°</td></tr> </table>		0 PLC	± 0.5	1 PLC	± 0.3	2 PLC	± 0.2	3 PLC	± 0.15	4 PLC	± -	ANGLES	± 3°	PRODUCT SPEC 108-57517	QUALIFICATION TEST REPORT		
0 PLC	± 0.5																
1 PLC	± 0.3																
2 PLC	± 0.2																
3 PLC	± 0.15																
4 PLC	± -																
ANGLES	± 3°																
MATERIAL SEE NOTE		FINISH SEE NOTE	501-57590	WEIGHT 26.6 GRAM	RESTRICTED TO												
CUSTOMER DRAWING			SIZE A3	CAGE CODE 00779	DRAWING NO 1734842												
			SCALE -	SHEET 1 OF 2	REV 01												

THIS DRAWING IS UNPUBLISHED. RELEASED FOR PUBLICATION
 © COPYRIGHT BY TYCO ELECTRONICS CORPORATION. ALL RIGHTS RESERVED.

LOC	DIST	REVISIONS			
P	LTR	DESCRIPTION	DATE	DWN	APVD
		SEE SHEET 1.			

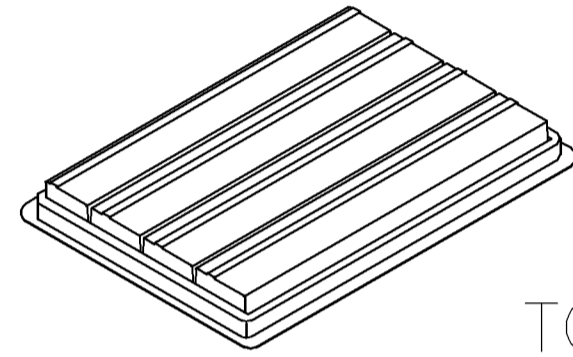
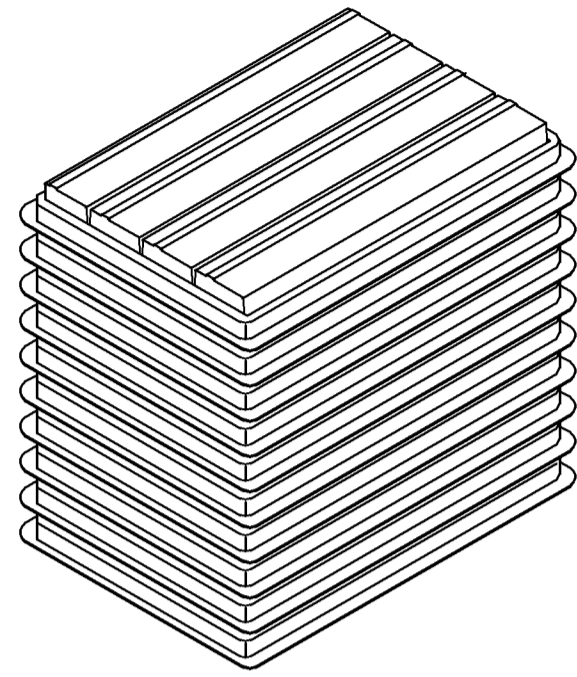

TOP COVER

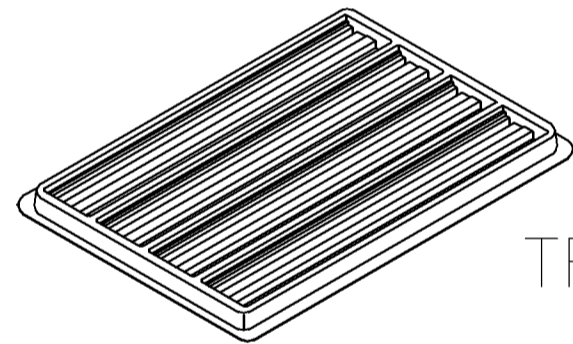

TRAY

- NOTES:
- DIMENSION:
 TRAY: L=310, W=210, H=28
 SHIPPING CARTON: L=335, W=230, H=280
 - QUANTITY:
 36 PCS/TRAY
 10 TRAY/SHIPPING BOX(360PCS)
 - WEIGHT:
 NET WEIGHT: 9.6KG
 GROSS WEIGHT: 11.0KG

LABEL

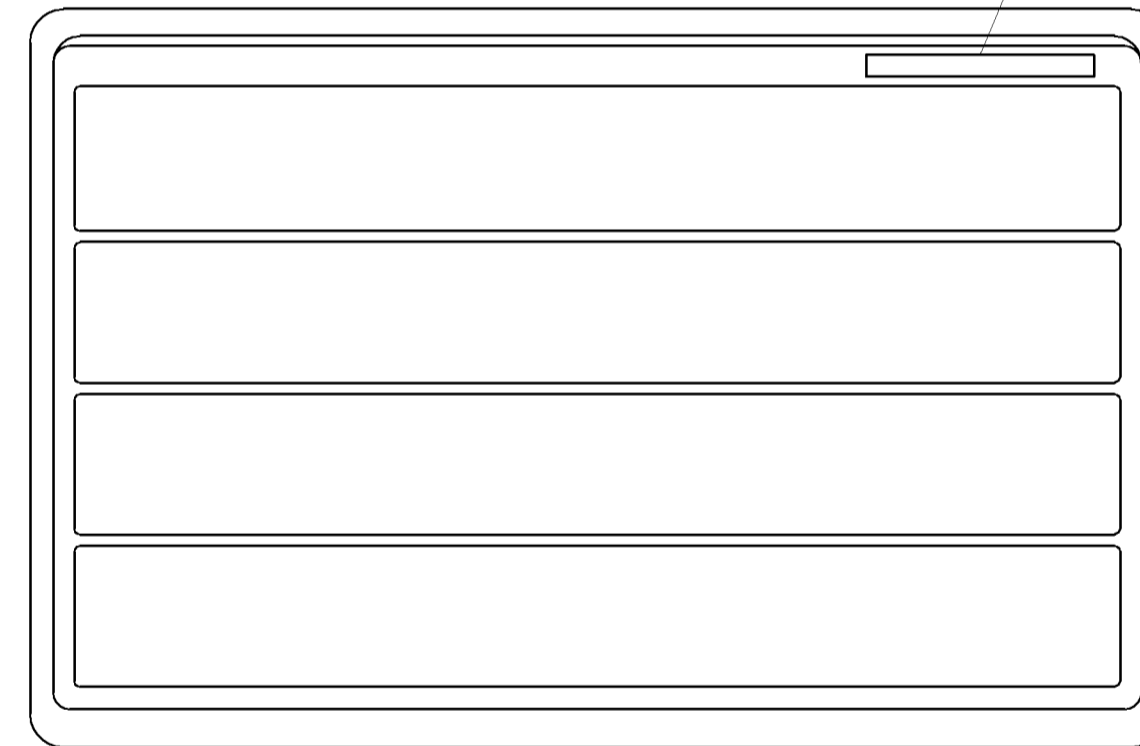

TRAY LAYOUT

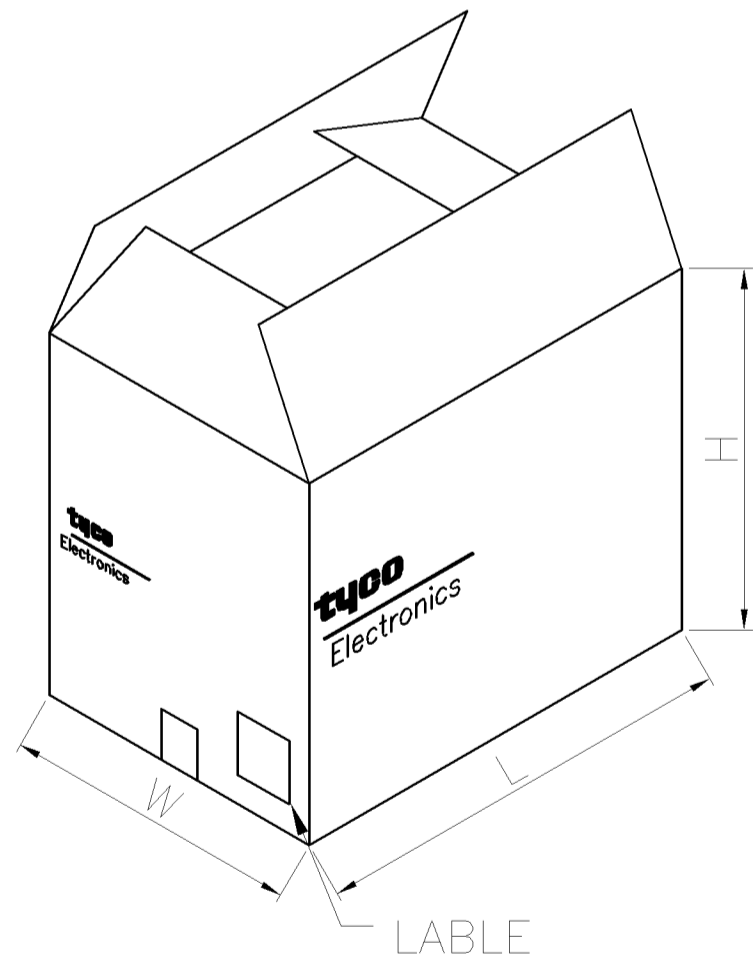

LABLE

CARTON

THIS DRAWING IS A CONTROLLED DOCUMENT.		DWN J. LEE 10JUL2007	Tyco Electronics Corporation Taipei, Taiwan														
DIMENSIONS: MM		CHK S. HOU 10JUL2007	NAME														
TOLERANCES UNLESS OTHERWISE SPECIFIED:		APVD W.J. KE 10JUL2007	PRODUCT SPEC														
<table border="1"> <tr><td>0 PLC</td><td>± -</td></tr> <tr><td>1 PLC</td><td>± -</td></tr> <tr><td>2 PLC</td><td>± -</td></tr> <tr><td>3 PLC</td><td>± -</td></tr> <tr><td>4 PLC</td><td>± -</td></tr> <tr><td>ANGLES</td><td>± -</td></tr> </table>		0 PLC	± -	1 PLC	± -	2 PLC	± -	3 PLC	± -	4 PLC	± -	ANGLES	± -	APPLICATION SPEC		STACKED ASSY, 9 POS PLUG OVER 15 POS RCPT, .750 STACK HEIGHT, AMPLIMTE	
0 PLC	± -																
1 PLC	± -																
2 PLC	± -																
3 PLC	± -																
4 PLC	± -																
ANGLES	± -																
MATERIAL		WEIGHT	SIZE	CAGE CODE	DRAWING NO												
FINISH		-	A3	00779	G=1734842												
CUSTOMER DRAWING			RESTRICTED TO	SCALE	SHEET												
			-	-	2 OF 2												
					REV 01												