

Tous droits strictement réservés. Reproduction ou utilisation sans l'autorisation écrite de la FCI est formellement interdite.  
All rights strictly reserved. Reproduction or use without written permission of FCI is expressly prohibited.

**FCI**

All rights strictly reserved. Reproduction or use without written permission of FCI is expressly prohibited.  
Tous droits strictement réservés. Reproduction ou utilisation sans l'autorisation écrite de la FCI est formellement interdite.

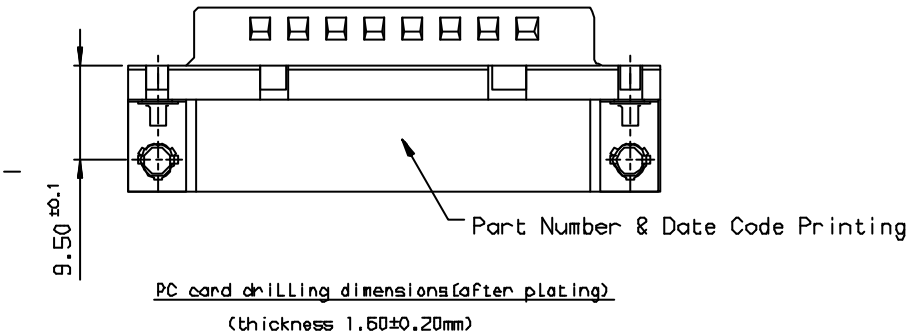
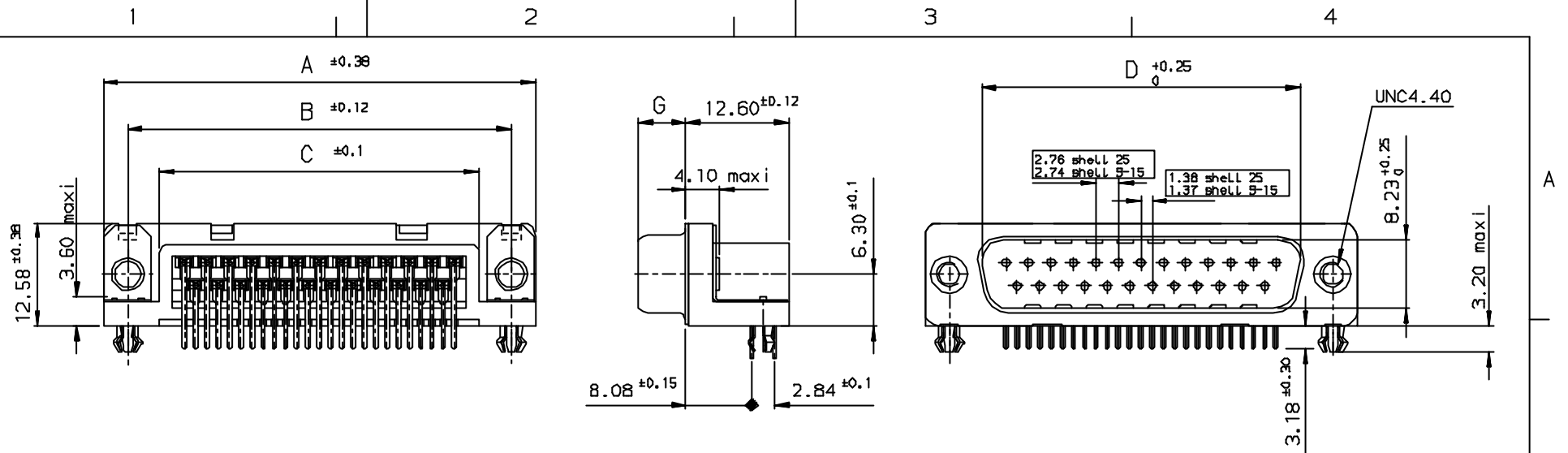

Pull parts	A $\pm 0.38$	B $\pm 0.12$	C $\pm 0.10$	D $+0.25$	E $\pm 0.07$	G $+0.25$	PART NUMBER
09	30.81	24.99	16.96	16.79	10.96	5.90	D09P33E4GX00**
15	39.14	33.32	25.18	25.12	19.18	5.90	D15P33E4GX00**
25	53.03	47.04	39.12	38.84	33.12	5.70	D25P33E4GX00**

GENERAL CHARACTERISTICS, SEE DRAWING C01-8646-0000

LF FOR LEAD FREE

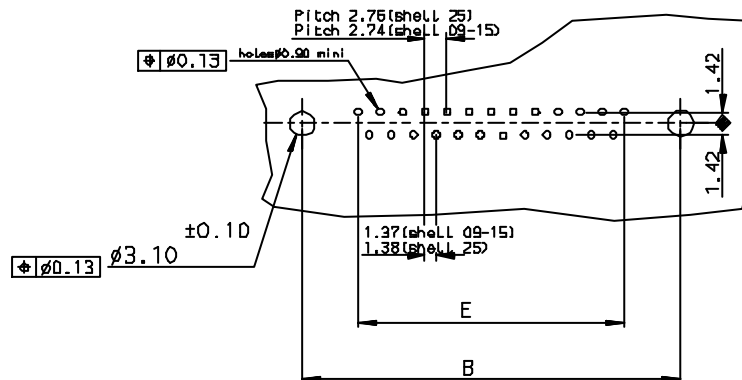

c	27/7/05	LEAD FREE DETAILS ADDED
INDEX	DATE	REVISION DESCRIPTION

Utr	Eon no	Dr	date
c	105-0124	JS	27/7/05

Dr JOHN SLEESA	27/10/97	Product Family	✓	Tolerance LINEAR $\pm 0.1$ ANGULAR $\pm 1^\circ$	Projection	MM
Eng GEORGE VJ	27/10/97	Spec ref			Size A3	Scale
Chr GEORGE VJ	27/7/05	Material			ECN	
Appr K Somasundaram	27/7/05					
<b>FCI</b>	Title	MALE CONNECT. DELTA D right angle with nut, harpoon & metal plate		Dwg no	C01-8646-0158-2	
	Catalog no	DELTA-D		CUSTOMER COPY	Sheet 1 of 1	