



FCIconnect.com

Copyright FCI

D

form: A3

1

2 3

4

5

6

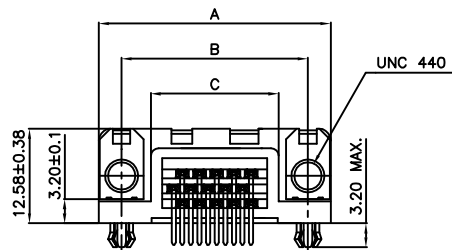
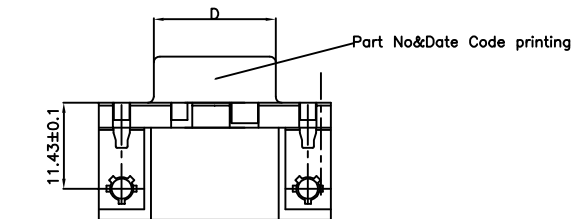

NOTE-1. FOR 14 POSN.HOLE NO.9 IS BLOCKED.

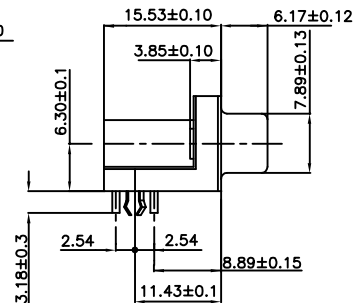

SIZE	DIMENSIONS						
	A±0.38	B±0.12	C±0.10	D ^{+0.25} ₋₀	E	F	G
14/15	30.81	24.99	16.96	16.21	7.68	8.19	2.285
26	39.14	33.32	25.18	24.54	7.02	8.01	2.285
44	53.03	47.04	39.12	38.25	7.01	8.02	2.285
62	69.32	63.50	55.68	54.71	7.03	8.21	2.41

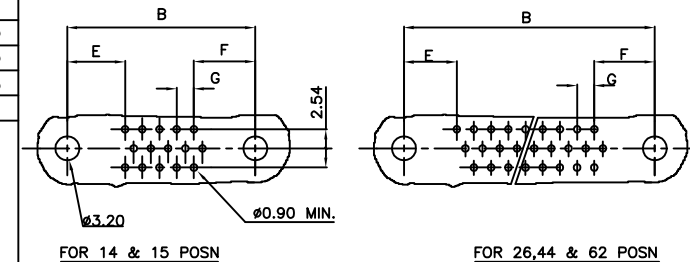
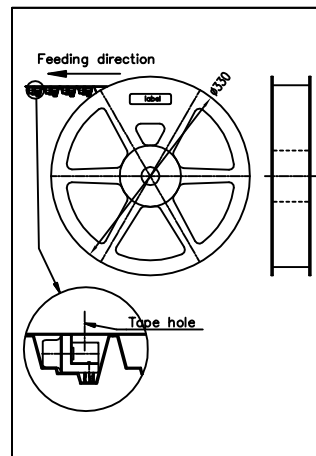

TECHNICAL SPECIFICATIONS

MATERIAL

SHELL
INSULATORS

: STEEL TIN/Zinc Cr 3 PLATED.
: SELF EXTINGUISHING THERMOPLASTIC,
UL CLASS94V0
: COPPER ALLOY

CONTACTS PLATING

ACTIVE ZONE
TERMINATION ZONE

: GOLD OVER NICKEL
: SnPb over Ni
: 2 μ MIN.MATTE TIN TOP OVER
1.27 μ MIN.NICKEL UNDER PLATE

FOR LEAD FREE TERMINATION

METAL BRACKET
SCREW LOCK
HARPOON
CLINCH NUT

: BRASS,TIN/Zinc Cr 3 PLATED.
: BRASS,TIN/Zinc Cr 3 PLATED.
: BRASS,TIN PLATED.
: BRASS,TIN/Zinc Cr 3 PLATED.

ELECTRICAL DATA

MAX.CURRENT RATING
TEST VOLTAGE
RATED VOLTAGE
CONTACT RESISTANCE
SHELL RESISTANCE
INSULATION RESISTANCE

: 3A
: 1000V
: 300V
: <25mΩ
: <5mΩ
: >5000MΩ

ENVIRONMENTAL CHARACTERISTICS

OPERATING TEMPERATURE RANGE
MECHANICAL CHARACTERISTICS

: -55°C +125°C

MATING/UNMATING CYCLES (Min.)

: > μ

INSERTION/EXTRACTION FORCE PER CONTACTS: 5 N Max./0.3 N Min.

ORDERING INFORMATION

I C D X X S 1 3 E X X X 1 2 L F

SERIES

NO.OF CONTACTS

14,15,26,44 & 62
TYPE OF CONTACTS

S-SOCKET

TYPE OF TERMINATION

13-ANGLED SPILL
PITCH 2.54 USA
FOOT PRINT 8.89 USA

HEIGHT OF TERMINATION

E-3.18 US STANDARD

LEAD FREE

SPECIAL CODE

12->HIGH TEMP+TAPE AND REEL PACKING.

MOUNTING OPTIONS

PA->STANDARD HOLE
PL->THREADED INSERT M3
PX->THREADED INSERT UNC 4.40
PV->FEMALE SCREW LOCK UNC 4.40
GL->HARPOON+INSERTM3+METAL BRACKET
GX->HARPOON+INSERT UNC 4.40+METAL BRACKET
GV->HARPOON+F.SCREW LOCK UNC 4.40+METAL BRACKET
UL->INSERT M3+METAL BRACKET
UX->INSERT UNC 4.40+METAL BRACKET
UV->F.SCREW LOCK UNC 4.40+METAL BRACKET

PLATING

4->FLASH Au+SnPb/Sn
6->0.76 μ Au+SnPb/Sn

Packaging Details

Tape according to EIA-481-B

Material : Conductive type

Reel ø 330mm

Qty for 15 pos- 130nos/ reel

Qty for 26 pos- 110nos/ reel

Empty Pockets

3 pockets min.and 300mm
extra cover tape at beginning
and 5 pockets min. at the end.

Final packaging

5 reels/ cartons

mat'l. code				surface	tolerance	projection	product family	
				ISO 1302	ISO 406 ISO 1101		COMPACT D	
ltr	ecn no	dr	date	tolerances unless otherwise specified			title	
D	106-0074	GVJ	2006/06/08	angles	linear		C-D A/S FEMALE CONNECTOR	
				0°±1°		MM		
						scale		
		dr	GEORGE.V.JOSEPH	2004/10/12			dwg no	
		enrg	Elias C. Thomas	2004/10/12			sheet 1 of 1	
		chr	GEORGE.V.JOSEPH	2006/06/23			C-CD-0021	
		appd	K.V.SIVADAS	2006/06/23			size	
sheet	revision	D					type	
index	sheet	1					Product Customer Drawing	

PDM: Rev:D

STATUS: Released

Printed: Jul 06, 2007