

THIS INFORMATION IS CONFIDENTIAL AND IS DISCLOSED TO YOU ON CONDITION THAT NO FURTHER DISCLOSURE IS MADE BY YOU TO OTHER THAN AMP PERSONNEL WITHOUT WRITTEN AUTHORIZATION FROM AMP (TAIWAN) LTD. DIMENSIONS IN MILLIMETERS. DO NOT SCALE PRINT.

NUMBER
C-788754

3RD ANGLE PROJECTION

METRIC

PRINT DIST
DW

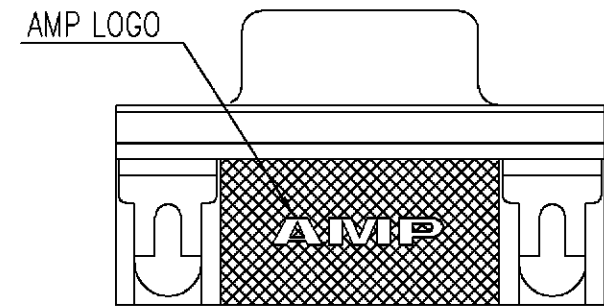
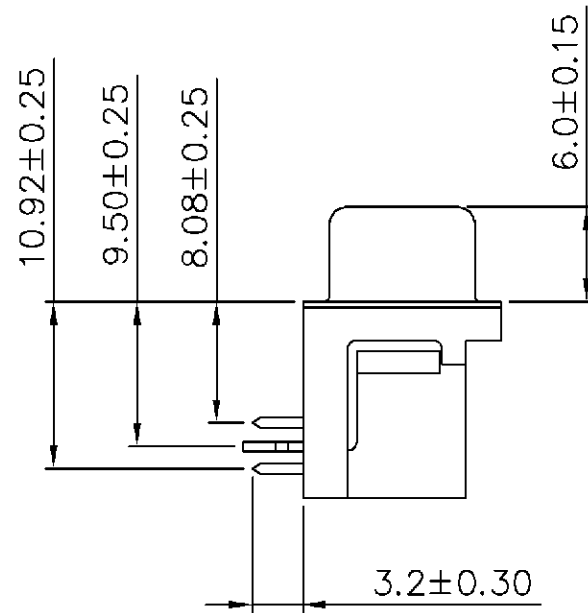
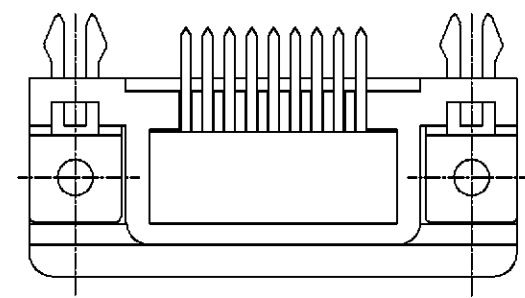
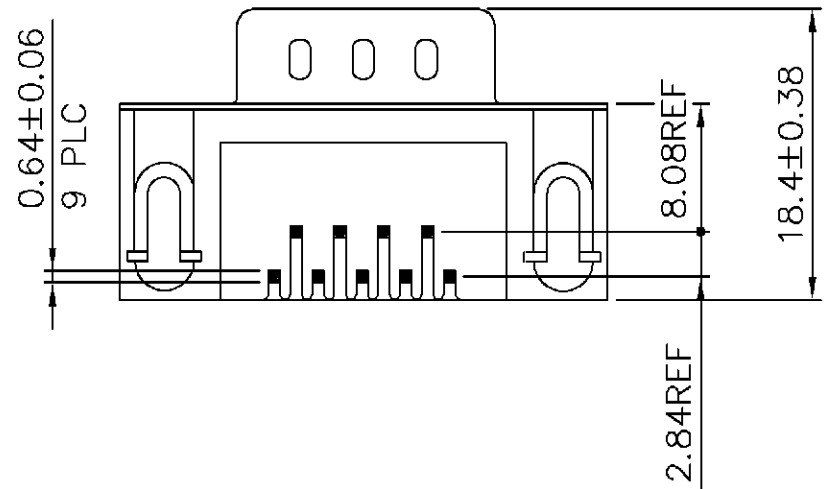
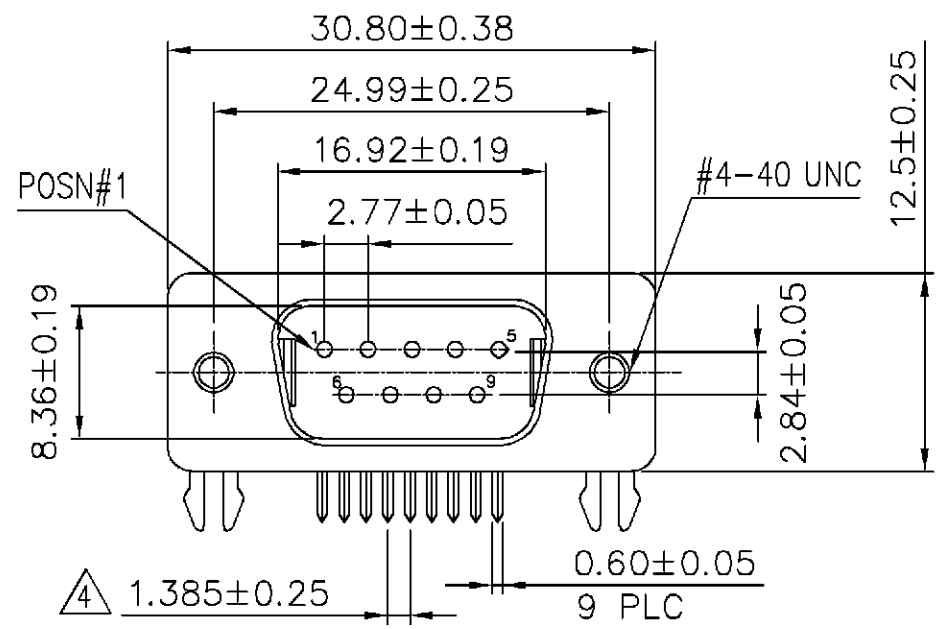

| | | | | |
|-----|-----------------|--------------|------------|---------------|
| | | | | |
| C | ADD PART NUMBER | FZ00-D144-03 | OH AW | 27JUN 2003 |
| LTR | REVISION RECORD | ECN | DWN CHK | DATE |

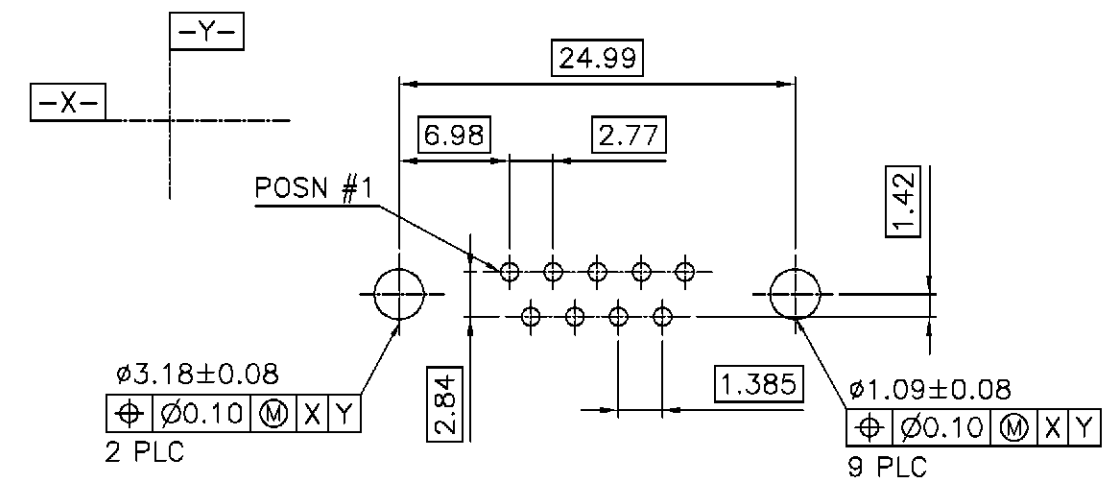

RECOMMENDED PCB LAYOUT (TOP VIEW)
(PC BOARD THICKNESS: 1.57[.062])

- 1 HOUSING: PBT, UL 94V-0 RATED, COLOR: BLACK.
CONTACTS: BRASS
SHELL: STEEL.
BOARDLOCKS: BRASS.
THREADED INSERTS: BRASS.
- 2 CONTACTS: GOLD PLATED (SEE TABLE) ON MATING END, 2.54um[.000100in] MIN TIN-LEAD ON SOLDER TAILS ALL OVER 1.27um[.000050in] MIN NICKEL ON ENTIRE CONTACT.
SHELL: NICKEL PLATED.
BOARDLOCK: SEE TABLE.
THREADED INSERT: NICKEL PLATED 0.76um[.000030in].
- 3 SPECIFICATIONS:
CURRENT RATING: 2 AMPS. (SIGNAL APPLICATION ONLY)
VOLTAGE RATING: 250 VAC.
DIELECTRIC WITHSTANDING VOLTAGE: 500 VAC(RMS).
INSULATION RESISTANCE: 1000 MEGOHMS MIN.
CONTACT RESISTANCE: 20 MILLIOHMS MAX.
OPERATING TEMPERATURE: -55° TO 105°C.
- 4 DIMENSION IS NON-CUMULATIVE.
- 5. SPECIFICATIONS SUBJECT TO CHANGES WITHOUT NOTICE.
CONTACT AMP FOR THE LATEST SPECIFICATIONS.

| | | | |
|-----------|-----------------------------------|-------------------|-------------|
| TRAY | 0.25um[.000010in] TIN-LEAD | GOLD FLASH | 788754-5 |
| TUBE | | 0.25um[.000010in] | 788754-4 |
| TRAY | 0.25um[.000010in] TIN OR TIN-LEAD | 0.25um[.000010in] | 788754-3 |
| | | 0.38um[.000015in] | 788754-2 |
| | | GOLD FLASH | 788754-1 |
| PACKAGING | BOARDLOCK PLATED | GOLD PLATING | PART NUMBER |

| | | | | |
|--|---------------------------|-------------|--|---|
| TOLERANCES UNLESS OTHERWISE SPECIFIED: 0 PLC ± 0.30 1 PLC ± 0.20 2 PLC ± 0.10 ANGLES ± | DWN | O. HU | TYCO Electronics NAME | TYCO HOLDINGS (BERMUDA) VII LTD. TAIWAN BRANCH |
| | CHK | A. WU | | |
| MATERIAL SEE NOTE 1 | APVD | J. CHENG | PLUG ASSEMBLY, 9 POSN, RIGHT ANGLE, 8.08mm[0.318in] | |
| | PRODUCT SPEC | 23-JUN-2003 | | |
| FINISH SEE NOTE 2 | QUALIFICATION TEST REPORT | | LOC DW | SIZE A ₃ |
| | WEIGHT | | DRAWING NO | REV |
| | | | C-788754 | C |
| | | | SCALE | SHEET |
| | | | 1:1 | 1 OF 1 |