

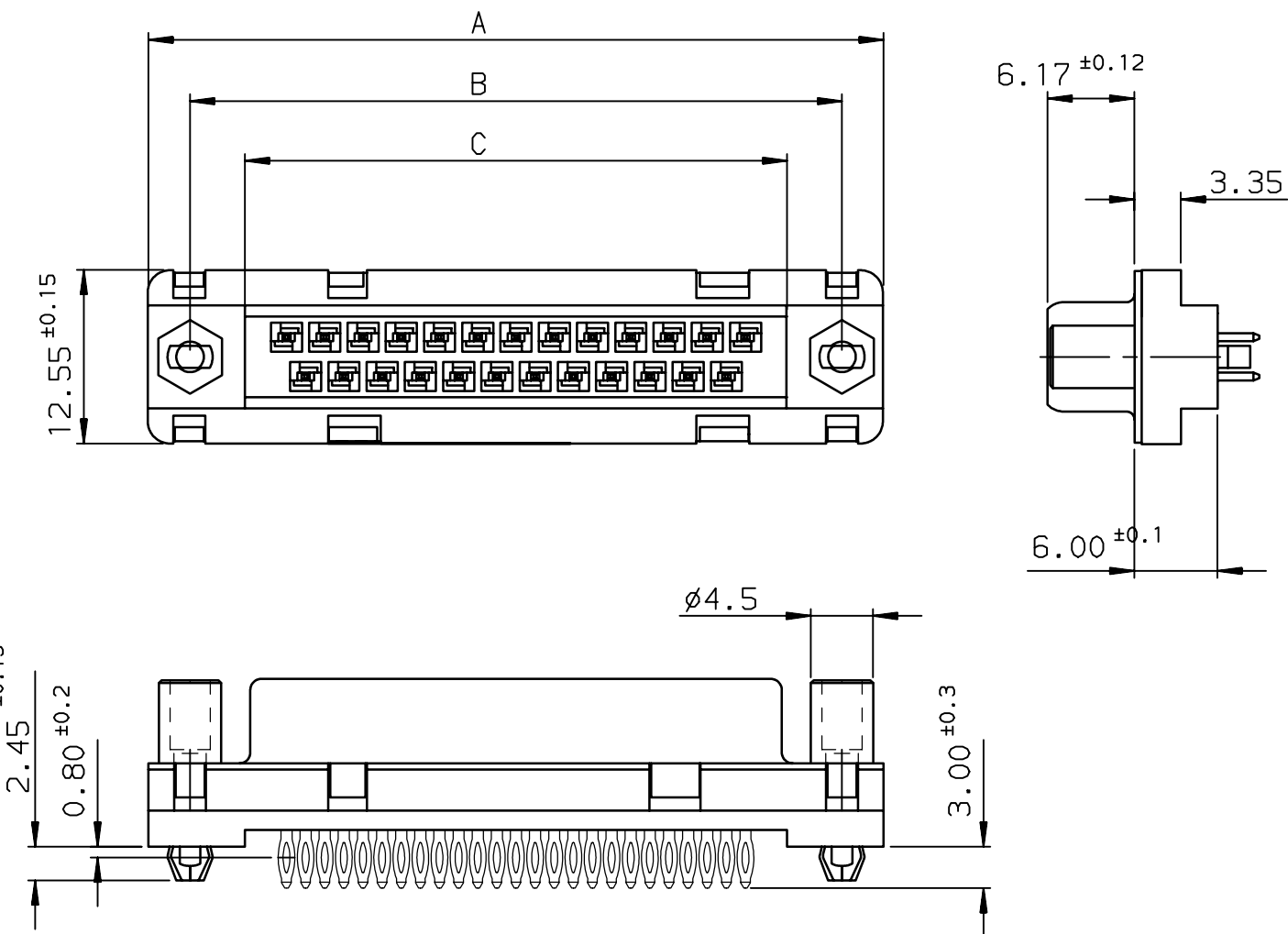

Copyright FCI.



TIN LEAD PART NUMBER

SHELL	A±0.38	B±0.12	C±0.10	D±0.25	E±0.07	PART NUMBER	PART NUMBER
09	30.81	24.99	16.96	16.21	10.96	D09S91C4GI00	D09S91C6GI00
15	39.14	33.32	25.18	24.54	19.18	D15S91C4GI00	D15S91C6GI00
25	53.03	47.04	39.12	38.25	33.12	D25S91C4GI00	D25S91C6GI00
37	69.32	63.50	55.68	54.71	49.68	D37S91C4GI00	D37S91C6GI00
						gold flash	0.76µ gold

LEAD FREE PART NUMBER

SHELL	A±0.38	B±0.12	C±0.10	D±0.25	E±0.07	PART NUMBER	PART NUMBER
09	30.81	24.99	16.96	16.21	10.96	D09S91C4GI00LF	D09S91C6GI00LF
15	39.14	33.32	25.18	24.54	19.18	D15S91C4GI00LF	D15S91C6GI00LF
25	53.03	47.04	39.12	38.25	33.12	D25S91C4GI00LF	D25S91C6GI00LF
37	69.32	63.50	55.68	54.71	49.68	D37S91C4GI00LF	D37S91C6GI00LF
						gold flash	0.76µ gold

rev	ecn no	dr	date
A	-	JAR	1996/09/17
B	LS05-004	MPE	2005/02/15
C	LS06-0097	LGO	2006/07/28
D	LS06-0140	LGO	2006/09/22
-	-	-	-
-	-	-	-
-	-	-	-

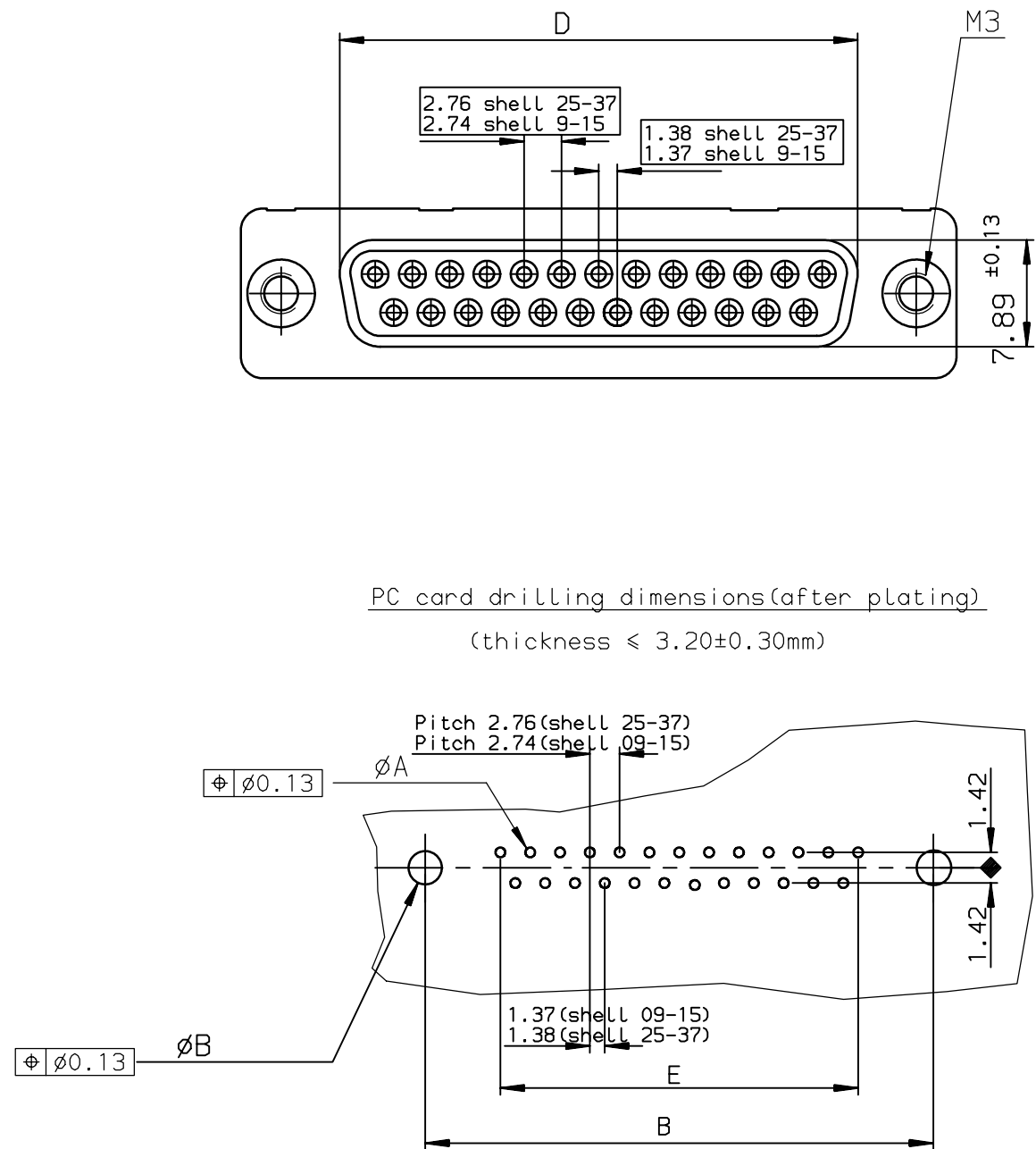

GENERAL CHARACTERISTICS AND ROHS INFORMATIONS:
SEE DRAWING C01-8646-0001

European Views									
www.fciconnect.com			surface ISO 1302	✓	tolerance std ISO 406 ISO 1101	projection mm			
TOLERANCES UNLESS OTHERWISE SPECIFIED						size A3	Scale 2		
Dr	PESSON	1996/09/17	ANGULAR		0.X	±0.1	ECN LS06-0140		
Eng	PESSON	1996/09/17		LINEAR	0.XX	±0.1	Spec ref -		
Chr	LEGARE	1996/09/17	0.XX' ±2°		0.XXX	±0.1			
Appr	LEGARE	1996/09/17	Product family D-SUB						
FCI			FEMALE CONNECTOR DELTA D EUROPE				Rev.		
			straight press-fit				D		
			catalog no -				CUSTOMER sheet 1 of 1		