

TIN LEAD PART NUMBER

SHELL	A±0.38	B±0.12	C±0.10	D±0.25	E±0.07	PART NUMBER		
09	30.81	24.99	16.96	16.79	10.96	D09P24B4P*00	D09P24B5P*00	D09P24B6P*00
15	39.14	33.32	25.18	25.12	19.18	D15P24B4P*00	D15P24B5P*00	D15P24B6P*00
25	53.03	47.04	39.12	38.84	33.12	D25P24B4P*00	D25P24B5P*00	D25P24B6P*00
37	69.32	63.50	55.68	55.30	49.68	D37P24B4P*00	D37P24B5P*00	D37P24B6P*00
						Gold flash	0,40 µ gold	0,76 µ gold

LEAD FREE PART NUMBER

SHELL	A±0.38	B±0.12	C±0.10	D±0.25	E±0.07	PART NUMBER		
09	30.81	24.99	16.96	16.79	10.96	D09P24B4P*00LF	D09P24B5P*00LF	D09P24B6P*00LF
15	39.14	33.32	25.18	25.12	19.18	D15P24B4P*00LF	D15P24B5P*00LF	D15P24B6P*00LF
25	53.03	47.04	39.12	38.84	33.12	D25P24B4P*00LF	D25P24B5P*00LF	D25P24B6P*00LF
37	69.32	63.50	55.68	55.30	49.68	D37P24B4P*00LF	D37P24B5P*00LF	D37P24B6P*00LF
						Gold flash	0,40 µ gold	0,76 µ gold

PC card drilling dimensions(after plating)
(thickness 2.40±0.20mm)

Threaded ØT M3 = L
Threaded ØT 4.40 = X

Threaded ØT M3 = L
Threaded ØT 4.40 = X

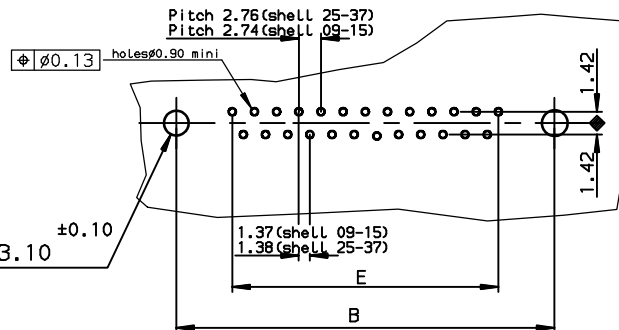

GENERAL CHARACTERISTICS AND ROHS INFORMATIONS:

SEE DRAWING C01-8646-0000

European Views

www.fciconnect.com		surface	ISO 1302	tolerance std	ISO 406 ISO 1101	projection	mm
		ISO 1302	✓	TOLERANCES UNLESS OTHERWISE SPECIFIED		mm	
Dr	LELEON	1992/09/14	ANGULAR	LINEAR	0.X ±0.1	size	Scale
Eng	PESSON	1992/09/14	0.XX ±0.1		0.XX ±0.1	A3	2
Chr	LEGARE	1992/09/14	0.XXX ±0.1		0.XXX ±0.1	ECN	LS06-0095
Appr	LEGARE	1992/09/14	Product family		D-SUB	Spec ref	-

rev	ecn no	dr	date
D	-	ATC	2000/12/15
E	LS05-001	MPE	2005/03/09
F	LS06-0095	LGO	2006/06/19
-	-	-	-
-	-	-	-
-	-	-	-
-	-	-	-

	title	MALE CONNECTOR DELTA D STD EUROPE		C01-8646-0103	Rev. F
	straight, solder type for PCB 2.4mm	catalog no			



Copyright FCI.