

A

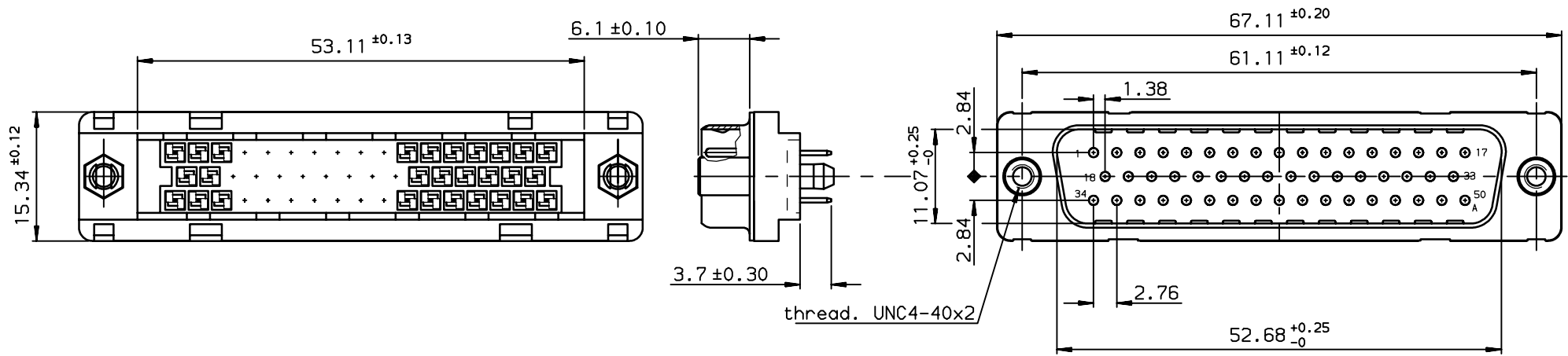

B

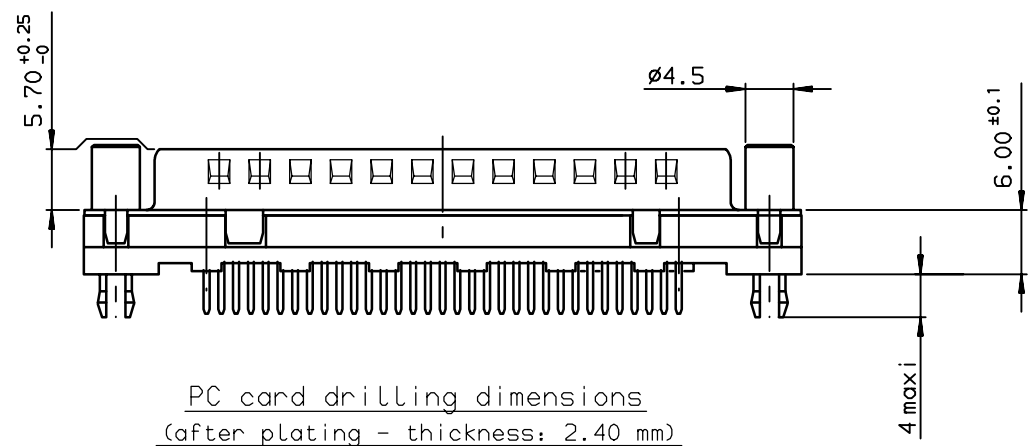

C

PC card drilling dimensions  
(after plating - thickness: 2.40 mm)

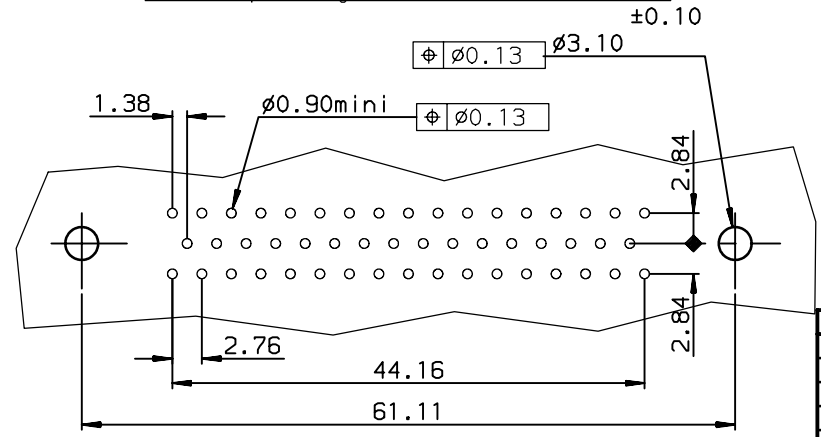

TIN LEAD PART NUMBER

Part number	Part number
D50P24B4GV00	D50P24B6GV00
fLash AU	0.76µ AU

LEAD FREE PART NUMBER

Part number	Part number
D50P24B4GV00LF	D50P24B6GV00LF
fLash AU	0.76µ AU

GENERAL CHARACTERISTICS AND ROHS INFORMATIONS:  
SEE DRAWING C01-8646-0000

European Views

www.fciconnect.com		surface ISO 1302 ✓	tolerance std ISO 406 ISO 1101	projection mm	mm
TOLERANCES UNLESS OTHERWISE SPECIFIED					
Dr	JARRY	2002/06/26	0.X ±0.1	size	Scale
Eng	PESSON	2002/06/26	0.XX ±0.1	A3	2
Chr	LEGARE	2002/06/26	0.XX* ±2*	ECN	L506-0095
Appr	LEGARE	2002/06/26	0.XXX ±0.1	Product family	D-SUB Spec ref -
FCI		MALE CONNECTOR DELTA D 50-EUROPE		dwg no	Rev.
		straight solder, harpoon, screwLock		C01-8646-0791	C
catalog no		-		CUSTOMER	sheet 1 of 1

rev	ecn no	dr	date
A	-	JAR	2002/06/26
B	L505-001	MPE	2005/03/14
C	L506-0095	LGO	2006/07/21
-	-	-	-
-	-	-	-
-	-	-	-



Copyright FCI.