

PC card drilling dimensions (after plating)
(thickness 1.60 ± 0.20mm)

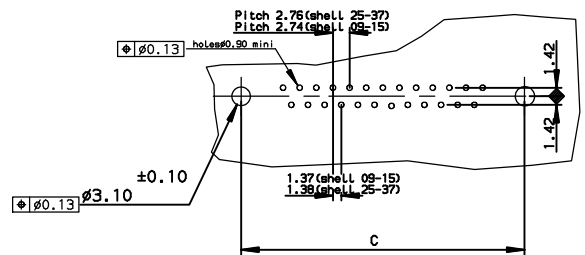

ELECTRICAL DATA

- I max 7.5A
- Contact resistance $\leq 7.3\text{ m}\Omega$
- Insulation resistance >5000Ma
- TEST VOLTAGE
- contact/contact >1000V
- contact/ground >1200V

MECHANICAL DATA

- Contact force >=0.14N
- Retention force >=40N
- Insertion force according to DIN41652 Part 2
- Withdrawal force according to DIN41652 Part 2
- Mechanical endurance > 500 matings / unmatings
- Material shell steel, cadmium plated
- Material insulator glass filled thermoplastic UL94V0
- Material contacts pin: brass; socket: brass
- Finish on contact area gold over nickel
- Finish on termination end bright tin-lead over nickel
- Solderability according to DIN 41640 Part 70, test 12a
- Schock according to DIN41640 Part 14, test 6c, 50g
- Vibration according to DIN41640 Part 15, test 6d, 20g 10 to 2000Hz; discontinuity $\leq 1\mu\text{s}$

ENVIRONMENTAL DATA

- Climatic category -55° / +125°/56 j
- Corrosion salt spray: 48h

Dimensions are in millimeters

Shell size	Number of contacts	A ^{+0.76} / ₀	B ^{+0.25} / ₀	C ±0.12	F ^{+0.51} / ₀	G ^{+0.25} / ₀	H ^{+0.51} / ₀	K	L ^{+0.22} / ₀	Part number
E	09	30.43	16.21	24.99	10.64	6.05	19.02	1.50 MAXI	0.80	DEM09S300
A	15	38.76	24.54	33.32	10.64	6.05	27.25	1.50 MAXI	0.80	DAM15S300
B	25	52.65	38.25	47.04	10.64	6.05	41.02	1.50 MAXI	0.80	DBM25S300
C	37	68.94	54.71	63.50	10.64	6.05	57.45	1.50 MAXI	1.00	DCM37S300

European Views

www.fciconnect.com		surface ISO 1302 ✓	tolerance std ISO 406 ISO 1101	projection	mm
TOLERANCES UNLESS OTHERWISE SPECIFIED					
Dr	JARRY	1998/01/05	ANGULAR	0.X ±0.1	size A3
Eng	PESSON	1998/01/05	LINEAR	0.XX ±0.1	Scale 1.5
Chr	LEGARE	1998/01/05	0.XX' ±2'	0.XXX ±0.1	ECN LS06-0097
Appr	LEGARE	1998/01/05	Product family	D-SUB	Spec ref -
title SOCKET CONNECTORS D SUB.WITH STRAIGHT DIP SOLDER PINS			C01-8637-0560		Rev. D
catalog no -			CUSTOMER sheet 1 of 1		

rev	ecn no	dr	date
C	-	JAR	2002/03/15
D	LS06-0097	LGO	2006/07/28
-	-	-	-
-	-	-	-
-	-	-	-
-	-	-	-



Copyright FCI.