

LAYOUT DIMENSIONS (after plating)
CONNECTOR SIDE VIEW

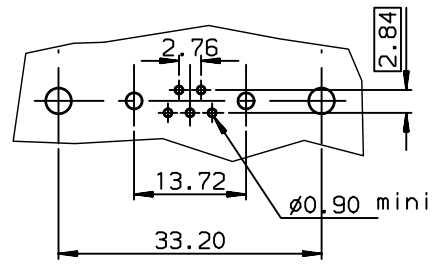

TIN LEAD PART NUMBER

DAI7W2P300G30	M 3
DAV7W2P300G30	UNC 4.40
DAI7W2P300G40	M 3
DAV7W2P300G40	UNC 4.40
DAI7W2P300H30	M 3
DAV7W2P300H30	UNC 4.40
DAI7W2P300H40	M 3
DAV7W2P300H40	UNC 4.40
PART NUMBER	Threaded A

LEAD FREE PART NUMBER

DAI7W2P300G30LF	M 3
DAV7W2P300G30LF	UNC 4.40
DAI7W2P300G40LF	M 3
DAV7W2P300G40LF	UNC 4.40
DAI7W2P300H30LF	M 3
DAV7W2P300H30LF	UNC 4.40
DAI7W2P300H40LF	M 3
DAV7W2P300H40LF	UNC 4.40
PART NUMBER	Threaded A

GENERAL CHARACTERISTICS AND ROHS INFORMATIONS:
SEE DRAWING C01-8639-0001

European Views

www.fciconnect.com		surface ISO 1302	<input checked="" type="checkbox"/>	tolerance std ISO 406 ISO 1101	projection 	mm
TOLERANCES UNLESS OTHERWISE SPECIFIED						
Dr	JARRY	2001/01/01	ANGULAR	LINEAR	0.X ±0.1	size A3
Eng	PESSON	2001/01/01	0.XX ±0.1	0.XXX ±0.1	Scale 1.5	
Chr	LEGARE	2001/01/01	0.XX ±2°		ECN LS06-0095	
Appr	LEGARE	2001/01/01	Product family		D-SUB	Spec ref -

rev	ecn no	dr	date
B	-	DEB	2003/09/29
C	LS05-001	MPE	2005/03/09
D	LS06-0095	LGO	2006/06/27
-	-	-	-
-	-	-	-
-	-	-	-

FCI title **PIN CONNECTOR WITH TWO POWERS CONTACTS** dwg no **C01-8639-1799** Rev. **D**

catalog no - CUSTOMER sheet 1 of 1



Copyright FCI.