

ELECTRICAL DATA

-Current at AMB.	4A
-I max	7.5A
-Contact resistance	≤7.3mΩ
-Insulation resistance	≥500MΩ
-TEST VOLTAGE	
contact/contact	≥1000V
contact/ground	≥1200V

MECHANICAL DATA

-Contact force	≥0.14N
-Retention force	≥40N
-Insertion force	according to DIN41652 Part 2
-Withdrawal force	according to DIN41652 Part 2
-Mechanical endurance	:500 matings / unmatings
-Material shell	steel, cadmium plated
-Material insulator	glass filled thermoplastic UL94V0
-Material contacts	pin: brass, socket brass
-Finish on contact area	gold over nickel
-Finish on termination end	bright tin-lead over nickel
-Solderability	according to DIN 41640 Part 70, test 12a
-Schock	according to DIN41640 Part 14, test 6c, 50g
-Vibration	according to DIN41640 Part 15, test 6d, 20g 10 to 2000Hz; discontinuity ≤1μs

ENVIRONMENTAL DATA

-Climatic category	-55° / +125°
-Corrosion	salt spray: 48h

PC BOARD LAYOUT

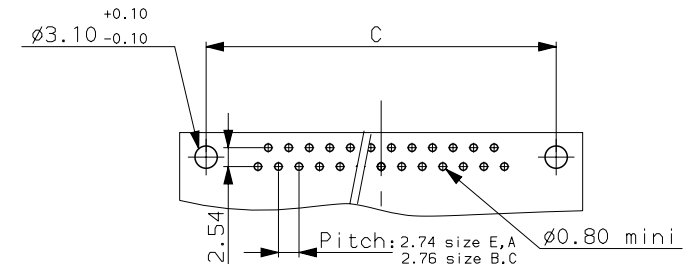

Dimensions are in millimeters

Shell size	Number of contacts	A ^{+0.76} ₀	B ^{+0.25} ₀	C ±0.12	F ^{+0.51} ₀	G	H ^{+0.51} ₀	L ^{+0.22} ₀	PART NUMBER
E	09	30.43	16.79	24.99	10.47	5.90 ^{+0.15} ₀	19.02	0.80	DEM09P500
A	15	38.76	25.12	33.32	10.47	5.90 ^{+0.15} ₀	27.25	0.80	DAM15P500
B	25	52.65	38.84	47.04	10.56	5.70 ^{+0.25} ₀	41.02	0.80	DBM25P500
C	37	68.94	55.30	63.50	10.56	5.70 ^{+0.25} ₀	57.45	1.00	DCM37P500

a	03/10/96	Creation of drawing.	
ISS	DATE	Lastest modification by : JOUBERT	MOD N°
Designed by: JOUBERT date 03/10/96		Type of drawing: CUSTOMER	
Checked by : FONTENEAU date 03/10/96		Released by: --	
TITLE : PIN CONNECTORS D SUBMINIATURE RIGHT ANGLED SPILL WITH PLASTIC BRACKETS			
SCALE	Special mfg: --	MATERIAL: --	N°: --
1.5	item list n°: --	--	--
	General Linear	General machining --	Geometrical Tolerances
	Tolerances: --	surface texture: <input checked="" type="checkbox"/>	see NF E 04-552
	FRAMATOME CONNECTORS FRANCE		This document is the property of FRAMATOME CONNECTORS FRANCE. It must not be reproduced or communicated without permission in writing flow the owners
	Rue Louis Breguet - BP 05 72024 LE MANS Cedex Tel. 33 (16) 43.84.08.43		
FORMAT	SOURIAU DRG N°		PROJECT
A3	C01-8637-0471		M94D001