

PC card drilling dimensions (after plating)

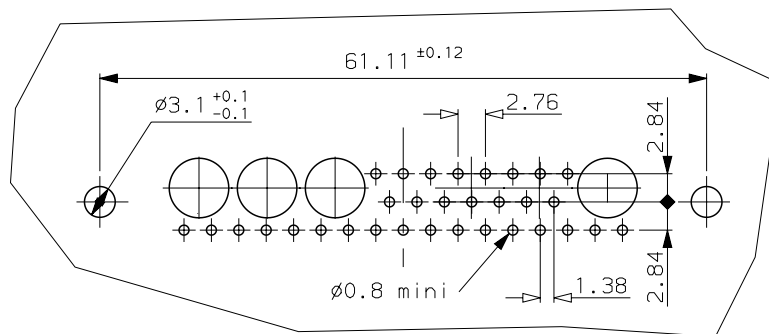

ELECTRICAL DATA

-Current at AMB.	5A
-I max	7.5A
-Contact resistance	≤7.3ma
-Insulation resistance	≥5000Ma
-TEST VOLTAGE	
contact/contact	≥1000V
contact/ground	≥1200V

MECHANICAL DATA

-Contact force	≥0.20N
-Retention force	≥20N
-Insertion force	according to DIN41652 Part 2
-Withdrawal force	according to DIN41652 Part 2
-Mechanical endurance	≥500 matings/unmatings
-Material shell	steel, bright cadmium -Lead
-Material insulator	glass filled thermoset UL94V0
-Material contacts	brass
-Finish on contact area	0.4 μ gold
-Finish on termination end	bright gold -Lead
-Solderability	according to DIN 41640 Part 70, test 12a
-Shock	according to DIN41640 Part 14, test 6c, 50g
-Vibration	according to DIN41640 Part 15, test 6d, 20g
	10 to 2000Hz: discontinuity ≤1μs

ENVIRONMENTAL DATA

-Climatic category	-55/155/56
-Corrosion	salt spray: 48h

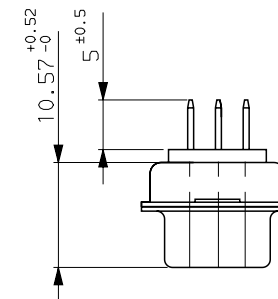

Part number		DDM36W4P300N	
b	12/11/96	Revisionned to day .	---
ISS	DATE	Latest modification by : JARRY	MOD N°
Designed by: JARRY		date 03/05/94	Type of drawing: CLIENT
TITLE : MALE CONNECTORS STRAIGHT SPILLS			SHEET 01
SCALE: 2.0			
		This document is the property of FRAMATOME CONNECTORS FRANCE It must not be reproduced or communicated without permission in writing from the owners	
FORMAT	SOURIAU DRG N°		PROJECT
A3	C01-8639-0551		M94D001