

PC BOARD LAYOUT

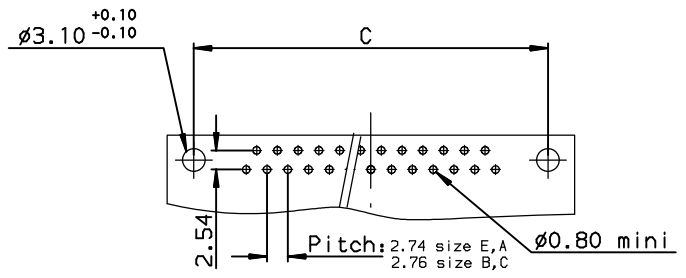

ELECTRICAL DATA

-Current at AMB.	4A
-I max	7.5A
-Contact resistance	<7.3mΩ
-Insulation resistance	>500MΩ
-TEST VOLTAGE	
contact/contact	>1000V
contact/ground	>1200V

MECHANICAL DATA

-Contact force	>0.14N
-Retention force	>40N
-Insertion force	according to DIN41652 Part 2
-Withdrawal force	according to DIN41652 Part 2
-Mechanical endurance	:500 matings / unmatings
-Material shell	steel, cadmium plated
-Material insulator	glass filled thermoplastic UL94V0
-Material contacts	pin: brass, socket: brass
-Finish on contact area	gold over nickel
-Finish on termination end	bright tin-lead over nickel
-Solderability	according to DIN 41640 Part 70, test 12a
-Shock	according to DIN41640 Part 14, test 6c, 50g
-Vibration	according to DIN41640 Part 15, test 6d, 20g 10 to 2000Hz; discontinuity <1μs

ENVIRONMENTAL DATA

-Climatic category	-55° / +125°
-Corrosion	salt spray: 48h

Dimensions are in millimeters

Shell size	Number of contacts	A ^{+0.75} ₀	B ^{+0.25} ₀	C ±0.12	F ^{+0.51} ₀	G ^{+0.25} ₀	H ^{+0.51} ₀	L ^{+0.22} ₀	PART NUMBER
E	09	30.43	16.46	24.99	10.64	6.05	19.02	0.80	DEM09S500
A	15	38.76	24.54	33.32	10.64	6.05	27.25	0.80	DAM15S500
B	25	52.65	38.25	47.04	10.64	6.05	41.02	0.80	DBM25S500
C	37	68.94	54.71	63.50	10.64	6.05	57.45	0.80	DCM37S500

European Views

www.fciconnect.com		surface ISO 1302 ✓	tolerance std ISO 406 ISO 1101	projection mm
TOLERANCES UNLESS OTHERWISE SPECIFIED				
Dr	JOUBERT	1996/10/03	ANGULAR	size A3
Eng	PESSON	1996/10/03	LINEAR	Scale 1.5
Chr	FONTENEAU	1996/10/03	0.xx' ±2'	ECN LS06-0097
Appr	LEGARE	1996/10/03	Product family D-SUB	Spec ref -
title SOCKET CONNECTORS D SUB. RIGHT			Rev. B	
title ANGLED SPILL WITH PLASTIC BRACKETS			C01-8637-0557	
catalog no -			CUSTOMER sheet 1 of 1	

rev	ecn no	dr	date
A	-	JOU	1996/10/03
B	LS06-0097	LGO	2006/07/28
-	-	-	-
-	-	-	-
-	-	-	-
-	-	-	-



Copyright FCI.