

This document is the property of Amphenol Corporation and is delivered on the express condition that it is not to be disclosed, reproduced or used, in whole or in part, for the manufacture or sale by anyone other than Amphenol Corporation without its prior consent, and that no right is granted in disclosure or to use any trademark in this document.

FEMALE

Specifications

Contact Resistance: 30m ohms max. at DC 100mA
 Insulator Resistance: 1000M ohms min. at DC 500V
 Current Rating: 5 AMP
 Dielectric Withstanding Voltage: AC 1000V For 1 minute
 Operating Temperature: -55°C ~ +125°C
 Shell : steel, tin plated
 Contact: Brass , Selective gold { see table below }
 Termination : Tin over Nickel
 Housing: PBT & 30% Glass Fiber (UL 94V-0)

ROHS compliant
 MSL components : level 3

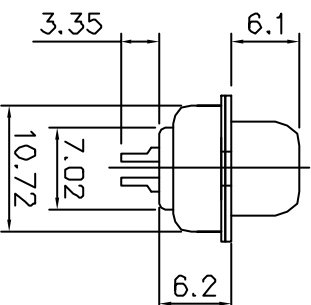
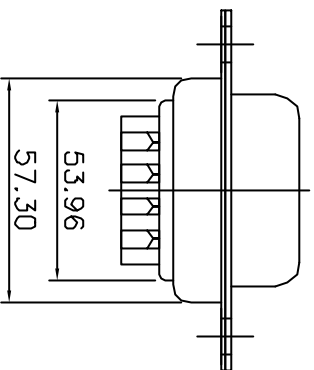
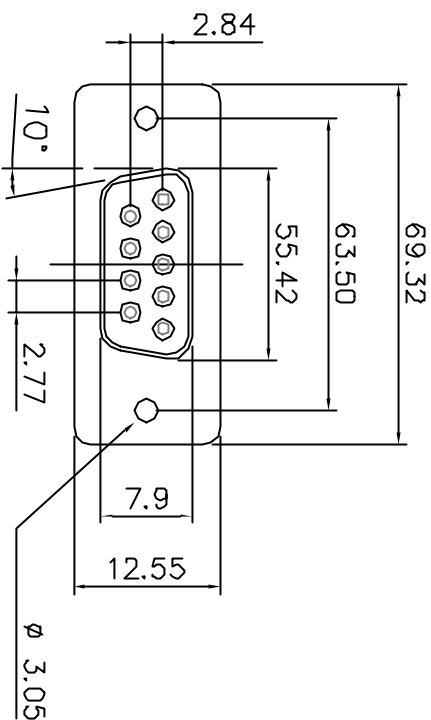

Drawing number	Contact plating
L77SDC37S	Gold flash
L177SDC37S	15µ inches
L77SDC37SC309	30µ inches

TOLERANCE	min	max	APPROVALS	DATE	TITLE
X	±0.05		GDU	06/03/06	SD SERIES D-SUB CONNECTORS SOLDER CUP SOCKET
X.X	±0.1		JF.L	06/03/06	
X.XX	±0.3		JF.L	06/03/06	
SIZE: A4 DRAWING: L-77SDC37S----- Scale N.A. Sheet 1 of 1					AMPHENOL AMPHENOL SOCAPEX Dole Plant
				MM	REV: A