

S

DRAWING MADE IN AMERICAN PROJECTION

4

3

858856

2

1

© 1968 BY AMP INCORPORATED. ALL RIGHTS RESERVED. AMP PRODUCTS COVERED BY PATENTS AND/OR PATENTS PENDING.

THIS PRODUCT DESIGNED AND BUILT BY AMP INCORPORATED. NO LICENSE TO USE THAT DESIGN IN MANUFACTURE, OR TO USE ANY ISSUED OR PENDING PATENTS WHICH ARE INVOLVED, IS IMPLIED.

REVISIONS				
ZONE	LTR	DESCRIPTION	DATE	APPROVED
	A	REVISED NOTE 1	LAB 10-17-73	JPA
	B	REVISED PER ECN 4349	D.S. 5-21-74	M.G.
	C	ADDED REF. TO .69, 1.19, 1.91, 1.2 & .89	XA 12-1-77	M.G.
	D	REV PER ECN 5-3960	4/20/87	R.S.
	E	OBS-2 ECN OF 0376	2-89	T.W.

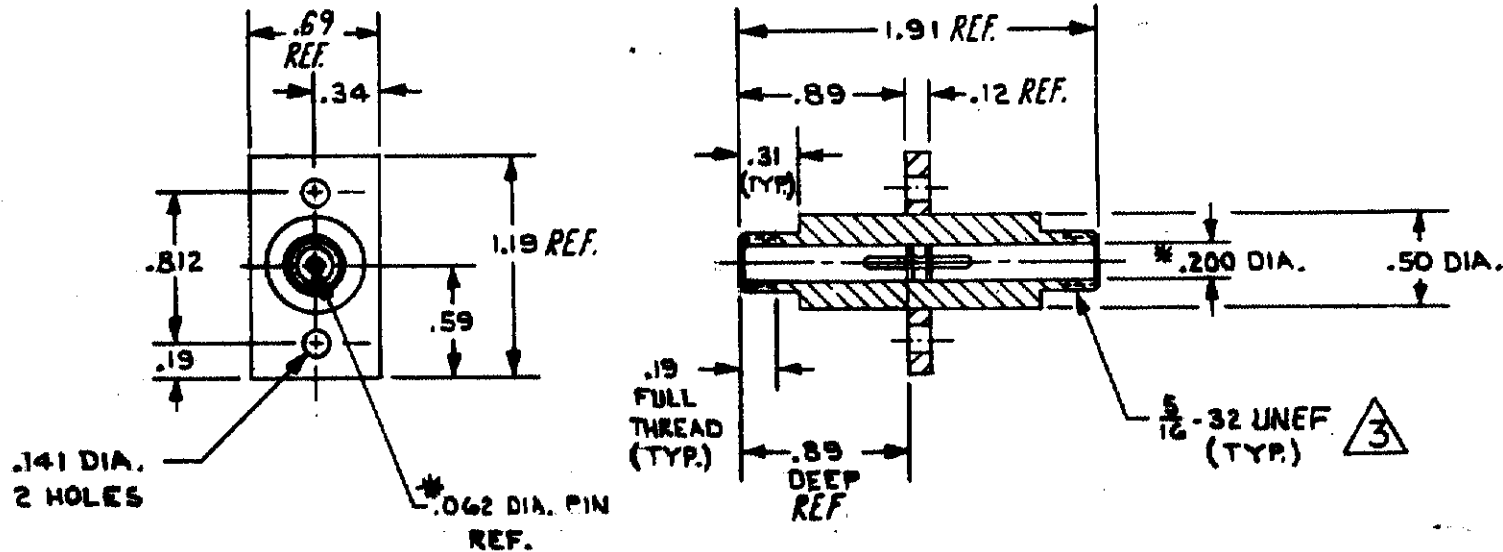

- RECEPTACLE TO MATE WITH AMP LGH- $\frac{1}{2}$ L LEAD ASSEMBLY, AVAILABLE SEPARATELY.
- DIA'S. MARKED WITH ASTERISK * TO BE CONCENTRIC WITHIN .015 T.I.R.
- PER FEDERAL STANDARD H-28 3 WIRE METHOD. DIMENSION OVER WIRES TO BE: .307-.310.

OBS	858856-2	RECEPTACLE (PIN GOLD PLATED)
	858856-1	RECEPTACLE (PIN TIN PLATED)

QTY REQD	QTY REQD	ITEM NO.	DWG SIZE	PART OR IDENTIFYING NO.	NOMENCLATURE OR DESCRIPTION
----------	----------	----------	----------	-------------------------	-----------------------------

UNLESS OTHERWISE SPECIFIED: DIMENSIONS ARE IN INCHES TOLERANCES .00 = ±.02 ANGLES .000 = ±.005				CONTRACT NO. DR 10Echall 2-6-68		AMP INCORPORATED CAPITRON DIVISION ELIZABETHTOWN, PENNSYLVANIA	
MATERIAL: EPIALL 1904				APPD		NAME LGH- $\frac{1}{2}$ L RECEPTACLE, FEED THRU FOR BULKHEAD APPLICATIONS	
FINISH: NATURAL				DSGN APPD JW Law 2-6-68		SIZE B	
NEXT ASSY				OTHER APPD		CODE IDENT NO. 89110	
FINAL ASSY				NEXT ASSY		NUMBER 858856	
USED ON				APPLICATION		SCALE N.T.S. WT	
QTY REQD						SHEET 1 of 1	

PRINT DIST 102 OF 150

5

4

3

2

DATE