

# STANDARD LEVER & ROCKER SWITCHES

# ALE

## FEATURES

- **High Reliability**  
Twin-contact clip mechanism is used in the contact section to ensure reliability.
- **Washable Structure**  
All switches are of a completely sealed construction.
- **Ideal for Extremely Small Current**  
Gold-plated contacts make these switches ideal for use with extremely dry circuit applications.
- **Designed for PC Boards**  
Terminal pitches are all in inch size (multiples of 2.54 mm).
- **Quality Touch**  
Independent detent construction provides a light operating touch.
- **UL approved.**

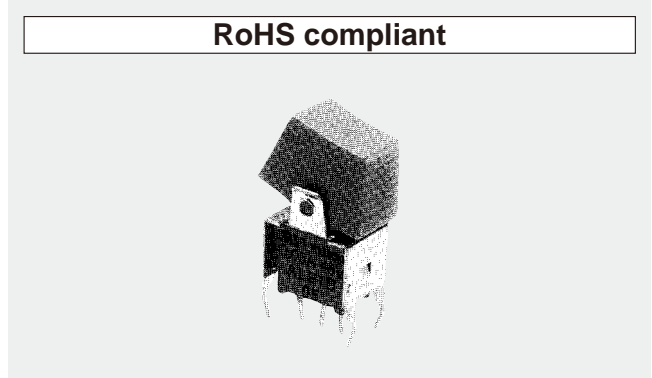

## SPECIFICATIONS

Rating	Max : 50mA 48VAC/DC Min : 1μA 20mVAC/DC
Initial contact resistance	50mΩmax. (1.5mA 200 μVAC)
Dielectric strength	250VAC 1 minute
Insulation resistance	500MΩ min (250VDC)
Electrical life	10,000 cycles at maximum rating. 50,000 cycles at 0.4VA max. (D type)
Operating temperature range	-20~+85°C
Storage temperature range	-40~+85°C

## ACTUATOR SHAPE

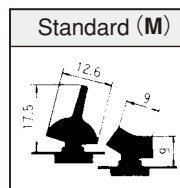

## PART NUMBERING

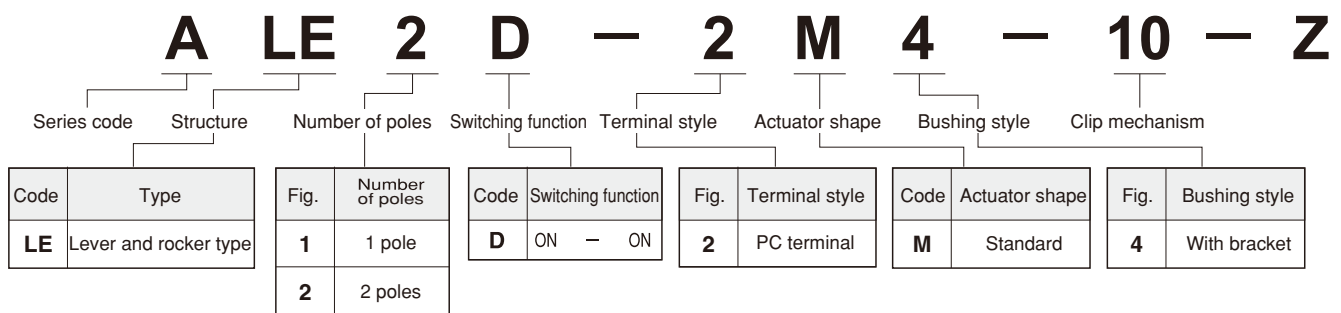

## TABLE OF PART NUMBERS

Number of poles	Terminal style	Switching function	Part No.
1 pole	PC terminal	ON - ON	ALE1D-2M4-10-Z
2 poles	PC terminal	ON - ON	ALE2D-2M4-10-Z

※Please contact us if you can't find your preferable combination in the table of part numbers.

■ Specifications are subject to change without notice. Specifications in this catalog are for reference. The formal specification sheets will be submitted upon request.

# ALE STANDARD LEVER & ROCKER SWITCHES

## OUTLINE DIMENSIONS

### SPDT

PC



Mount with **rocker**

Compact type

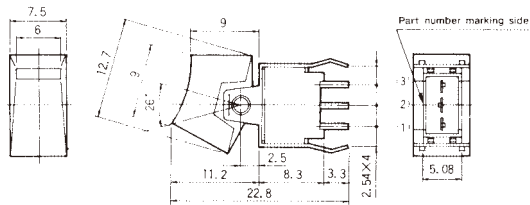

Terminal number not shown on box.

Switching function	Viewed from part No. marking side		
Part No.			
<b>ALE1D-2M4-10-Z</b>	ON	—	ON
Connecting terminals	2-3	—	2-1

### DPDT

PC



Mount with **lever**

Compact type

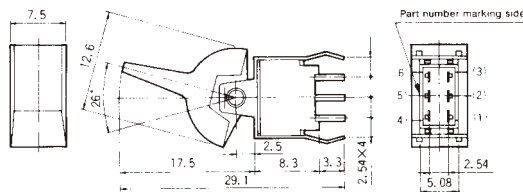

Terminal number not shown on box.

Switching function	Viewed from part No. marking side		
Part No.			
<b>★ALE2D-2M4-10-Z</b>	ON	—	ON
Connecting terminals	2-3 5-6	—	2-1 5-4

★ : Made-to-order items.

