

FL

HYPER-MINIATURE LEVER & ROCKER SWITCHES

FEATURES

- It is of ultra-compact type. The volumetric ratio is half that of the conventional series A.
- Immersion cleaning is possible after soldering.
- Terminal mounting is at 0.1-inch pitches.
- Independent detent mechanism provides light feel operability.
- Regarding the contact reliability, a long-term stability is assured by the clip contact.
- Gold-plated contacts make these switches ideal for use with extremely small current.
- All plastic construction prevents a malfunction due to static electricity.

SPECIFICATIONS

Rating	Max : 0.4VA (28VDC max.) Min: 1 μ A 20mVDC
Initial contact resistance	100m Ω max. (1.5mA 200 μ VAC)
Dielectric strength	250VAC 1 minute
Insulation resistance	500M Ω min (250VDC)
Electrical life	10,000 cycles at max. rating 50,000 cycles at min. rating (D type)
Operating temperature range	-40~+85°C
Storage temperature range	-40~+85°C

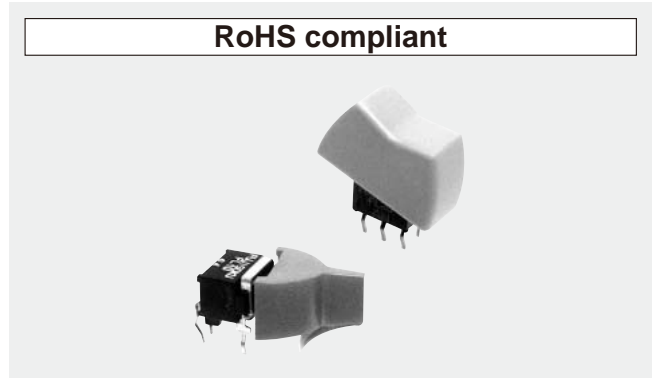
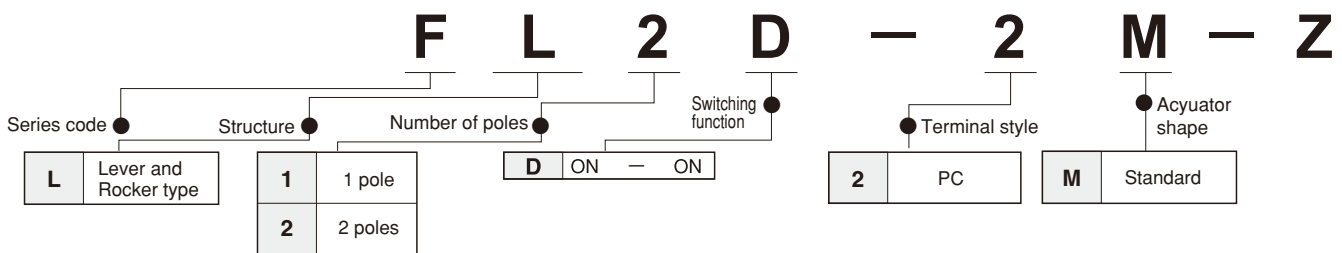

TABLE OF PART NUMBERS

Number of poles	Terminal style	Switching function	Part No.
1 pole	PC terminal	ON - ON	FL1D-2M-Z
2 poles	PC terminal	ON - ON	FL2D-2M-Z

PART NUMBERING



STANDARD ACCESSORIES

Part name	Lever	Rocker	Rocker
Dimensions	 Gloss finish (ABS resin)	 Gloss finish (ABS resin)	 Gloss finish (ABS resin)
White	140000050858	140000481410	140000481594
Red	140000050859	140000481411	140000481595
Black	140000050860	140000481412	140000481596
Gray	140000050861	140000481413	140000481597

LEVER · ROCKER MOUNTING

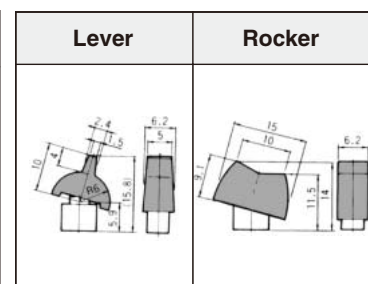

● Lever/Rocker is a standard accessory. Please choose one of them by specifying the part number.

※ Please contact us if you can't find your preferable combination in the table of part numbers.

■ Specifications are subject to change without notice. Specifications in this catalog are for reference. The formal specification sheets will be submitted upon request.

FL HYPER-MINIATURE LEVER & ROCKER SWITCHES

OUTLINE DIMENSIONS

SPDT

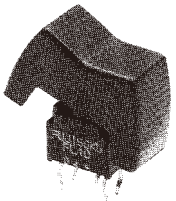

Mount with **Rocker**

PC

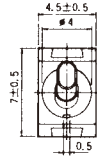

Terminal number not shown on box.

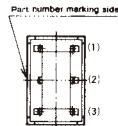
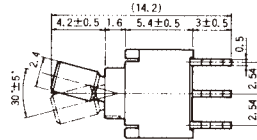

PC Hole Layouts

Switching function	Viewed from part No. marking side		
Part No.	FL1D-2M-Z	—	—
Connecting terminals	2-1	—	2-3

DPDT



Mount with **Lever**

PC

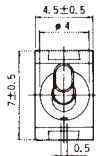

Terminal number not shown on box.

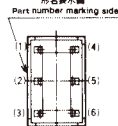
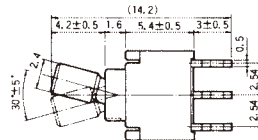

PC Hole Layouts

Switching function	Viewed from part No. marking side		
Part No.	FL2D-2M-Z	—	—
Connecting terminals	2-1 5-4	—	2-3 5-6

SOLDERING

- Hand soldering
Device : Solder iron
380°C Max. 3 sec. Max.
- Auto soldering
Device : Wave or dip type
275°C Max. 6 sec. Max.
Preheat should be within 80-120°C and less than 120 sec.
- When soldering two or more terminals to the common land, use solder resist to solder them independently.

FLUX CLEANING

- Solvents : Fluorine or Alcohol type
- Cleaning shall be made when terminal temperature falls to 90°C or lower. Or, leave the switch at normal temperature for 5 minutes or longer, before cleaning.
- Do not apply ultrasonic cleaning.

PACKAGING SPECIFICATION

