













SLEEVES		SHAFT ADAPTER
	2mm Light Sky Blue	
	3mm Orange	103 BASE 
	1/8 inch (3.175mm) Purple1	103 TOP COVER 
	4mm Gray60	TOOL A 
	3/16 inch (4.76mm) Yellow1	TOOL B 
	5mm Green1	
	6mm Red1	
	1/4 inch (6.35mm) Snow	
	8mm Blue	

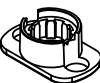

ASSEMBLY

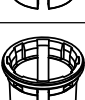
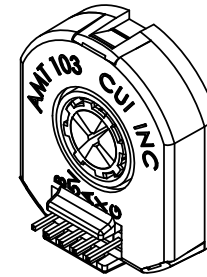
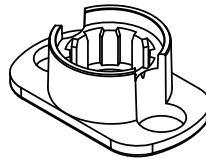
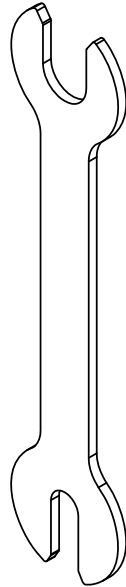
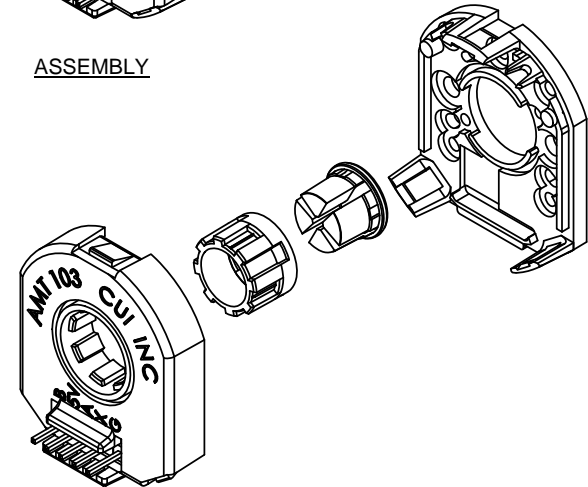

PIN-OUT	
PIN	DESCRIPTION
B	B CHANNEL
5V	+5VDC POWER
A	A CHANNEL
X	INDEX OUPUT
G	GROUND

MATING CONNECTOR  
AMP 3-640441-5

CABLES AVAILABLE  
(SOLD SEPERATELY)



AMT103 VersaPak comes with all items shown: all Sleeve sizes, Shaft Adapter, Base, Top Cover, Tool A, Tool B, Index Pulse, and 16 Resolution Dip Switch.

#### Sleeve Sizes

The AMT comes with sleeve adapters to fit the following bore diameters: 2mm, 3mm, 3.17mm (1/8"), 4mm, 4.76mm (3/16"), 5mm, 6mm, 6.35mm (1/4"), 8mm.

#### Operational Specs

3.6 Vdc~5.5Vdc; Max power consumption 10mA  
Temp Range: -40 ~ +100°C  
Current consumption: 6mA (typ), 10mA max

#### Resolution Options (PPR)

All resolutions stated are before quadrature decoding (example: 1000PPR x 4 = 4000 counts).

Resolutions of AMT103 VersaPak = 48, 96, 100, 125, 196, 200, 250, 256, 384, 400, 500, 512, 800, 1000, 1024, 2048.

#### Max RPM

7500	2048, 1000, 800, 384 (plus res. from 15k and 30k RPM)
15000	1024, 500, 400, 192 (plus res. from 30k RPM)
30000	512, 250, 200, 96, 256, 125, 100, 48

#### Resolutions

#### Mounting Hole Options (see dim drawing for layout)

- 2 each M1.6 holes on 16mm (.63") bolt circle
- 2 each #4 holes on 19.05 (.75") bolt circle
- 2 each M1.6 or M2 holes on 20mm (.787") bolt circle
- 3 each M1.6 or M2 holes on 20.9mm (.823") bolt circle
- 3 each M1.6 or M2 holes on 22mm (.866") bolt circle
- 4 each M1.6 or M2 holes on 25.4mm (1") bolt circle

Note: Some stepper motors may leak a magnetic field causing the AMT index pulse to not function properly.



**CUI INC**

20050 SW 112th Ave.  
Tualatin, OR 97062  
Phone: 503-612-2300  
800-275-4899  
Fax: 503-612-2383  
Website: www.cui.com

TITLE: AMT103 VersaPak		REV: D
PART NO. AMT103-V		UNITS: MM [INCHES]
DRAWN BY: ZRJ	APPROVED BY:	SCALE: N/A

PC FILE NAME:  
AMT103-V-REV-D

COPYRIGHT 2007 BY CUI INC.

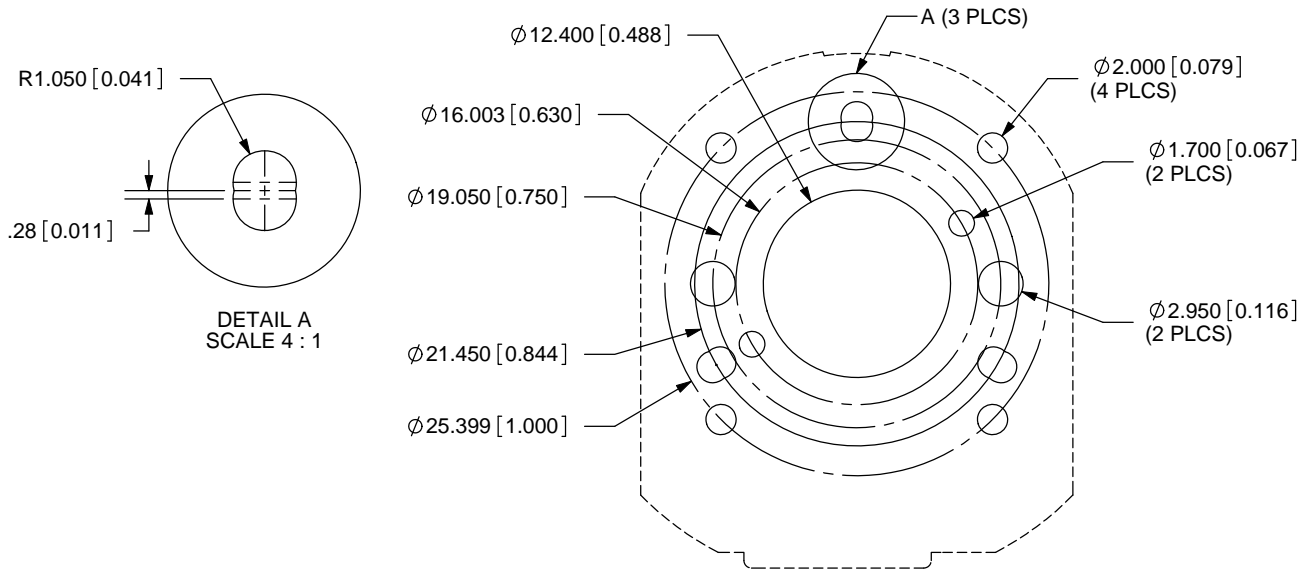
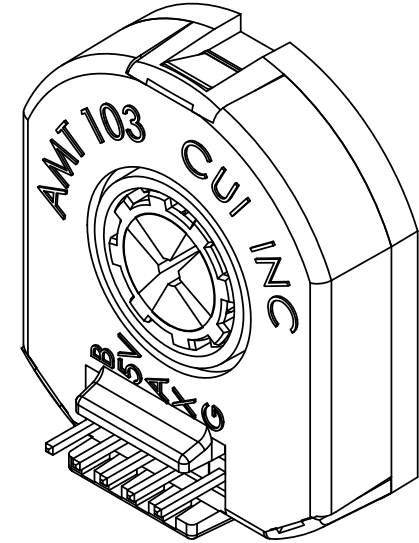
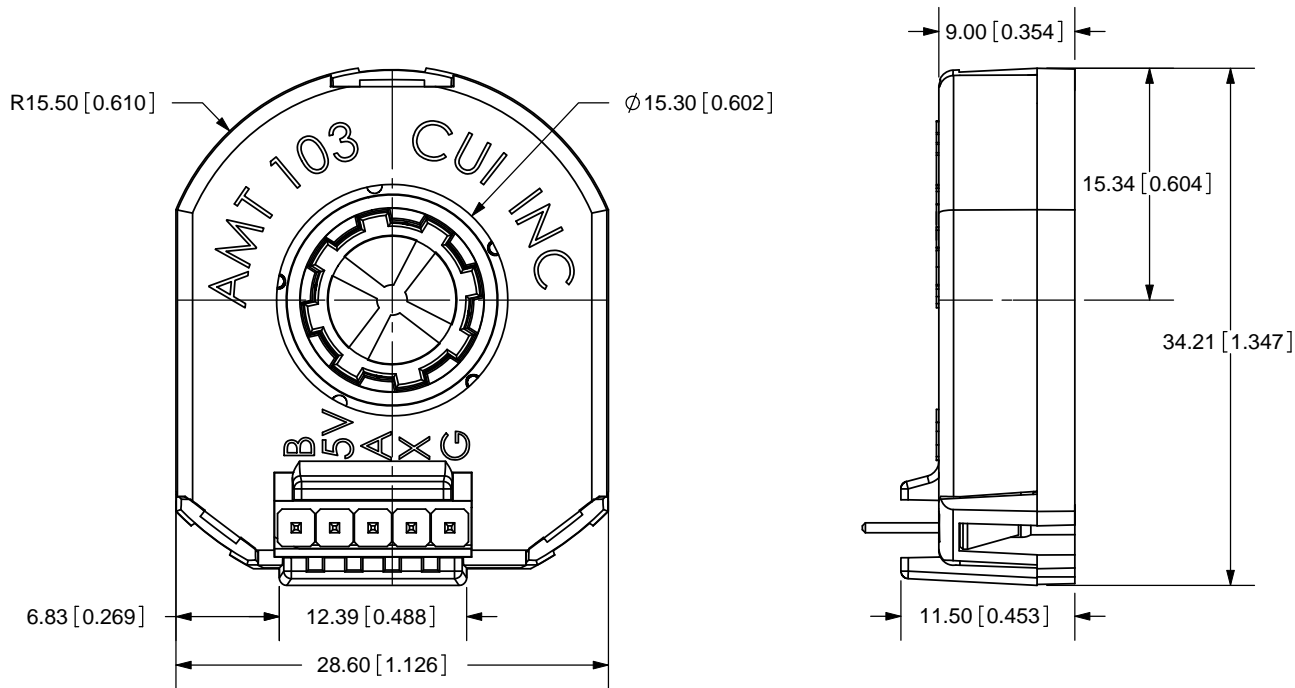

TOLERANCE:  
 $\pm 0.05\text{mm}$  UNLESS OTHERWISE  
 SPECIFIED



20050 SW 112th Ave.  
 Tualatin, OR 97062  
 Phone: 503-612-2300  
 800-275-4899  
 Fax: 503-612-2383  
 Website: www.cui.com

TITLE: AMT103 DIMENSION DRAWING		REV: D
PART NO. AMT103	UNITS: MM [INCHES]	
DRAWN BY: ZRJ	APPROVED BY:	SCALE: 2:1