

LTR	EN	DESCRIPTION	APPR	BY	DATE
A	-	INITIAL RELEASE	RB	EM	2-10-04

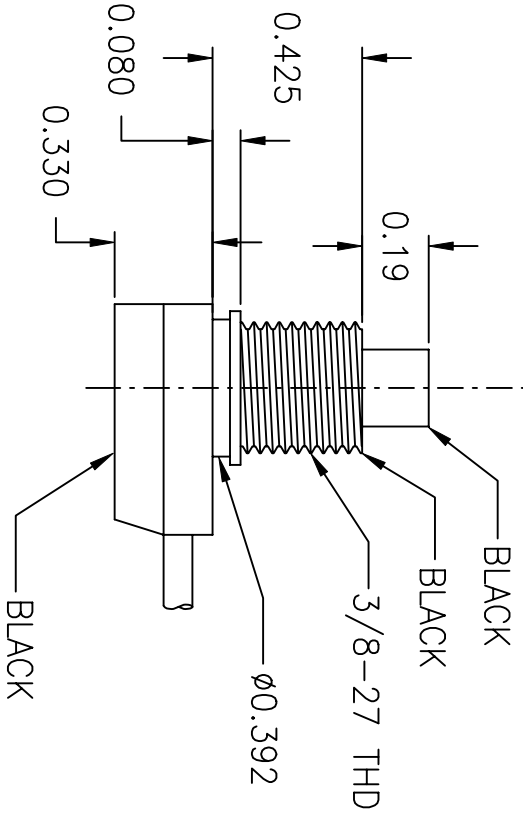
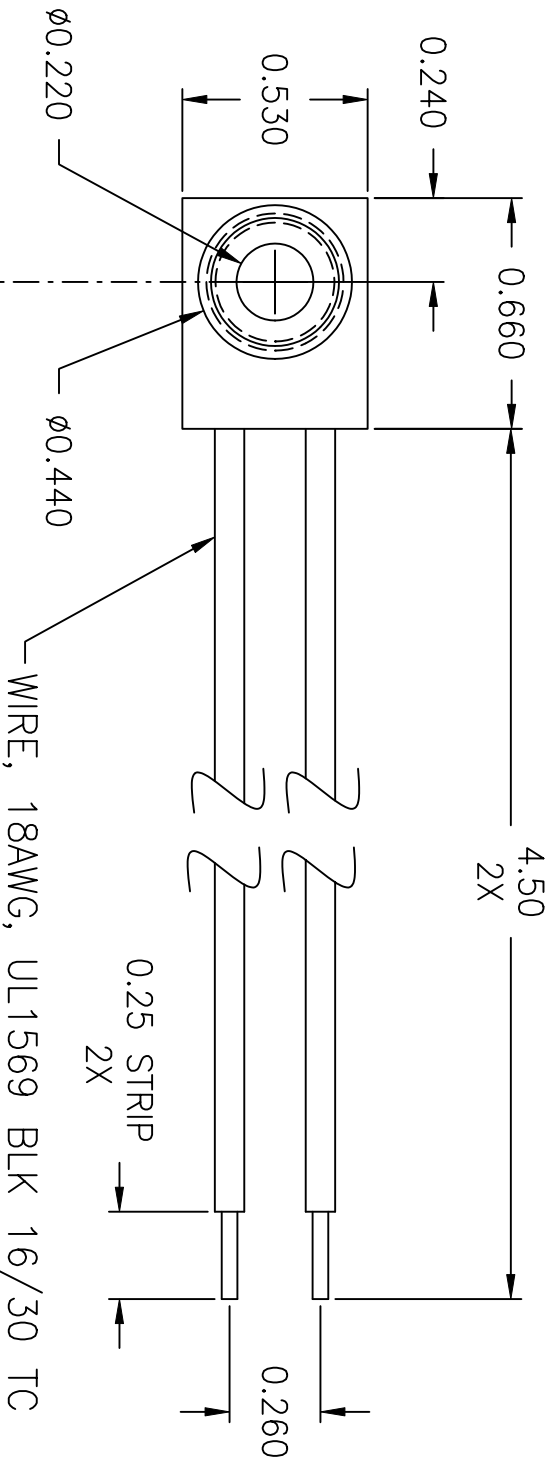

JUDCO INVENTORY NO. 40-3145-01
 SWITCH TYPE: PUSH ON - PUSH OFF, SPST
 UL ELECTRICAL RATING: 125VAC, 6A, 6A-L
 UL TEMPERATURE RATING: 65°C
 NUTS PACKED SEPARATELY
 ELECTRICAL GREASE ADDED: SYNTECH 2292G2

CUSTOMER: DIGI KEY
 CUST. PN: 511 PB-ND
 APPROVED BY: _____
 DATE: _____

DIMENSIONS IN INCHES DIMENSIONS ARE REFERENCE		
TITLE HARBOR CITY CALIFORNIA		
DRAWN: EM	02-10-04	OUTLINE J-188A-1 ULAC
APPR: KJ	02-10-04	
DWG. NO. 1415-569		SHEET 1 OF 1

This document embodies a product, component, and/or design proprietary to JUDCO MANUFACTURING INC., and which is protected either as a trade secret, by U.S. Patent, or by copyright. It may not be used in any way without written consent of JUDCO MANUFACTURING INC.