

LTR	EN	DESCRIPTION	APPR	BY	DATE
A	-	INITIAL RELEASE	RB	EM	2-16-04

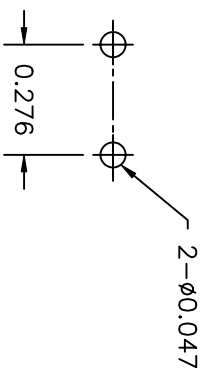

SUGGESTED MOUNTING PATTERN

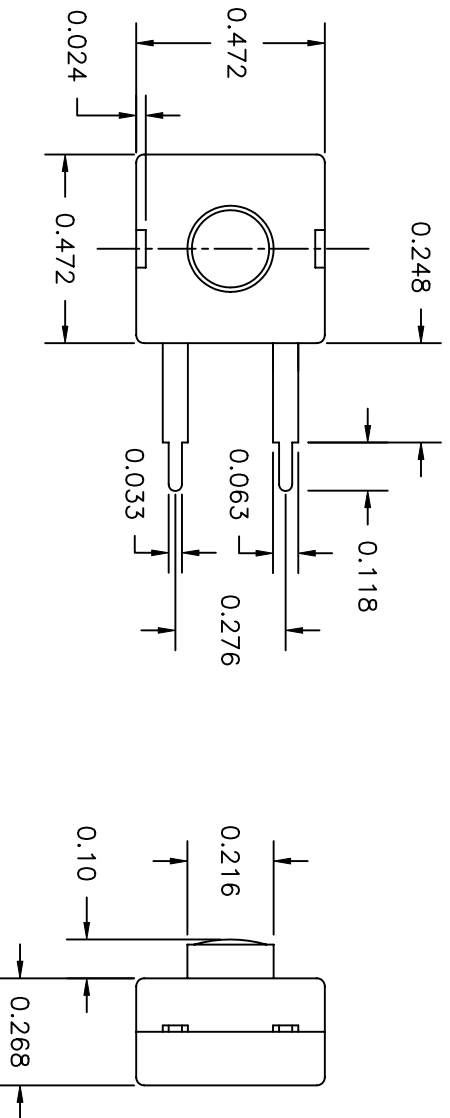
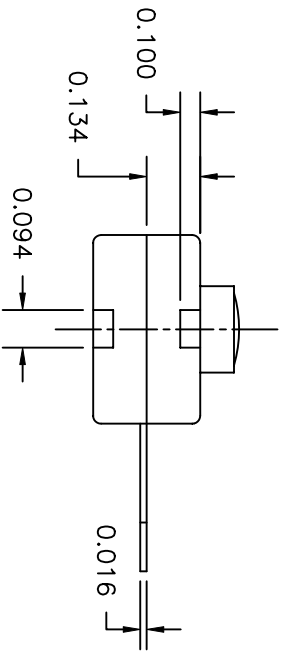

JUDCO INVENTORY NO. 50-0014-00
 SWITCH TYPE: PUSH BUTTON, SPST, ON-OFF
 UL ELECTRICAL RATING: 12VDC, 300MA

CUSTOMER: DIGI KEY
 CUST. PN: 518 PB-ND

APPROVED BY: _____
 DATE: _____

DIMENSIONS IN INCHES
 DIMENSIONS ARE REFERENCE

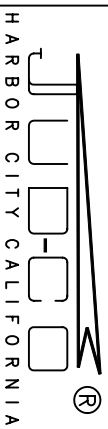

HARBOR CITY CALIFORNIA

TITLE

OUTLINE

DRAWN: EM 02-16-04
 APPR: KJ 02-16-04

J-977-1 SPST, 2 STR TRMS, ON-OFF
 DWG. NO. 1415-575

1415US75A.DWG

SHEET

1 OF 1

This document embodies a product, component, and/or design proprietary to JUDCO MANUFACTURING INC., and which is protected either as a trade secret, by U.S. Patent, or by copyright. It may not be used in any way without written express consent of JUDCO MANUFACTURING INC.