

LTR	EN	DESCRIPTION	APPR	BY	DATE
A	-	INITIAL RELEASE	RB	NH	12-18-03

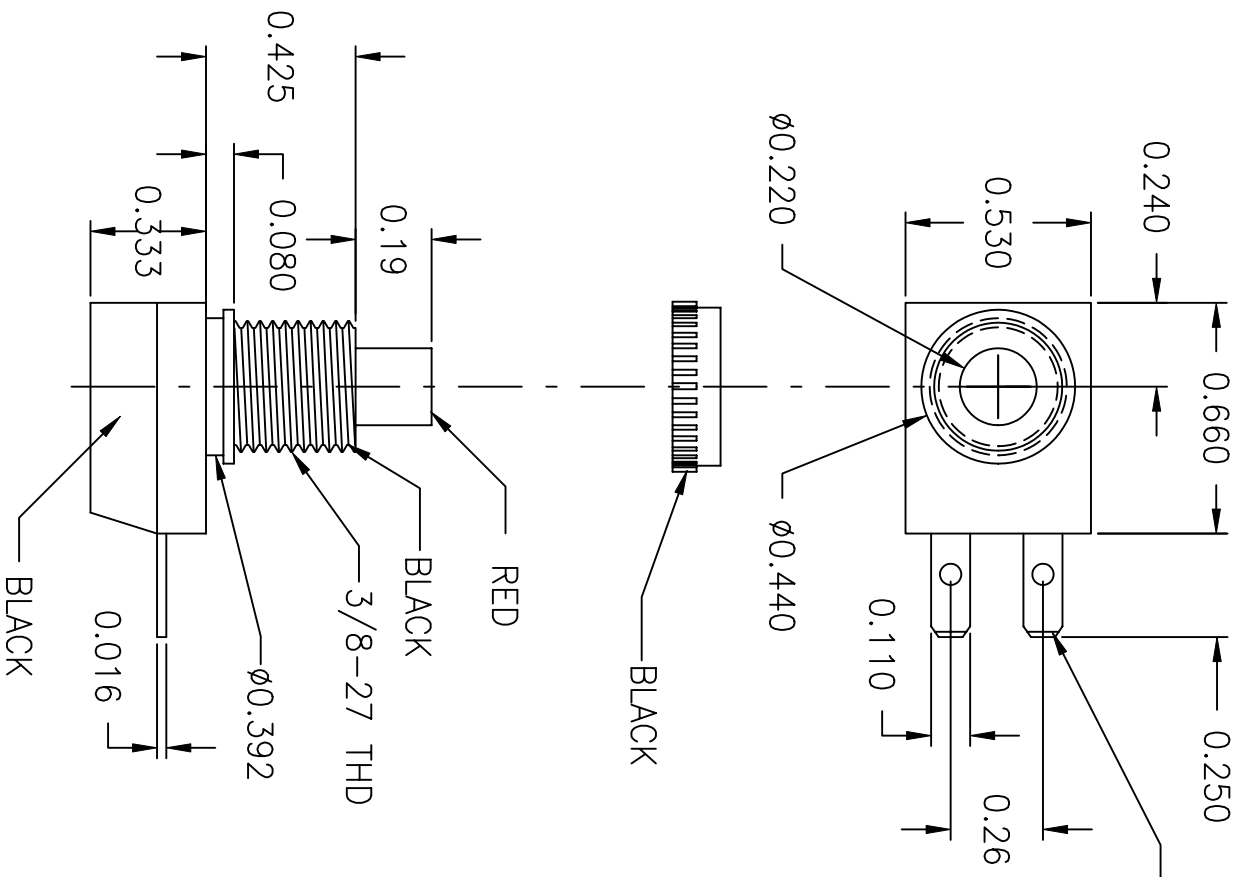

JUDCO INVENTORY NO. 40-3437-02
 SWITCH TYPE: MOMENTARY, NORMALLY CLOSED
 NUTS PACKED SEPARATELY.

CUSTOMER: DIGI-KEY
 APPROVED BY: _____
 DATE: _____

This document embodies a product, component, and/or design proprietary to JUDCO MANUFACTURING INC., and which is protected either as a trade secret, by U.S. Patent, or by copyright. It may not be used in any way without written express consent of JUDCO MANUFACTURING INC.

DIMENSIONS IN INCHES DIMENSIONS ARE REFERENCE		
DRAWN: NH 12-18-03		
APPR: KJ 12-18-03	DWG. NO. 1415-528	TITLE HARBOR CITY CALIFORNIA OUTLINE J-188A-3
1415US28A.DWG		SHEET 1 OF 1