

SWITCH FUNCTION	
POS. 1	POS. 2
ON	(ON)
1-3	1-2

(ON)=MOMENTARY

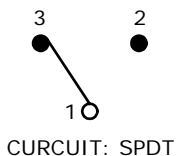

NOTE:

1. ALL DIMENSIONS IN MM [INCH]
2. GENERAL TOLERANCE: X.X=±0.4  
X.XX=±0.25
3. TERMINAL NUMBERS FOR REF ONLY
- ▲ 4. PLATING MATERIAL: GOLD
5. RATING: 0.4VA MAX. @ 20VDC OR AC
6. ELECTRIC LIFE: 50,000 MAKE-AND-BREAK CYCLES AT FULL LOAD.
7. INSULATION RESISTANCE: 1,000 MEGA-OHM MIN.
8. DIELECTRIC STRENGTH: 1,000 V RMS @SEA LEVEL.
9. OPERATING TEMP.: -30°C to 85°C
11. 2002/95/EC (ROHS) COMPLIANT
10. ▲ DENOTES CRITICAL PARAMETER.

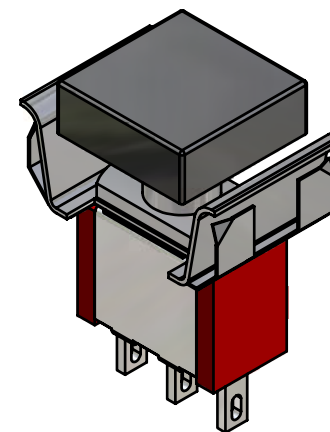
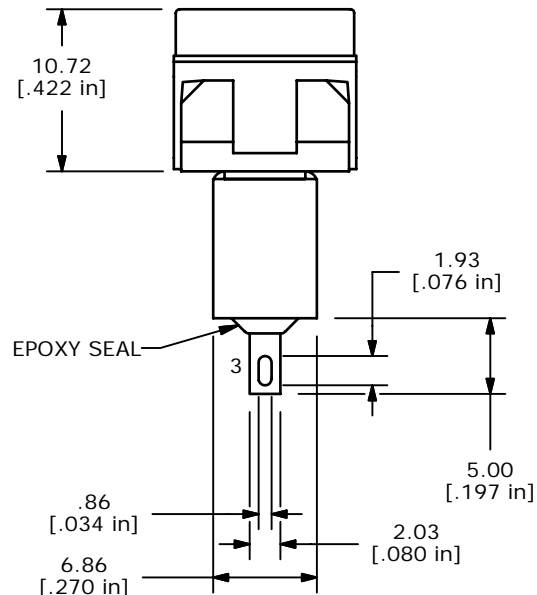
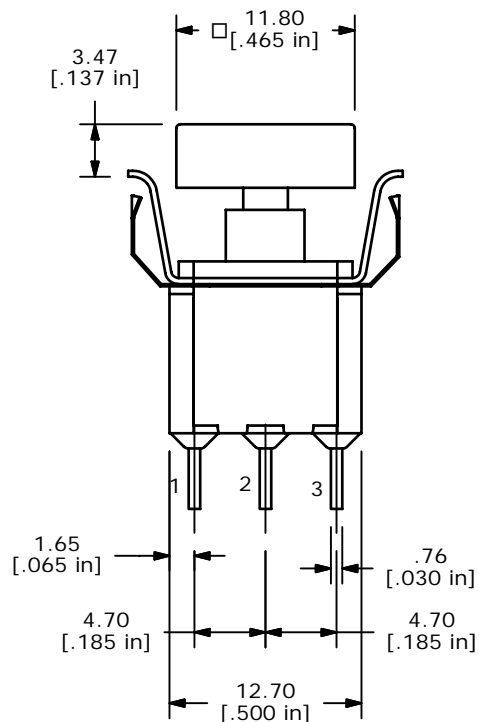
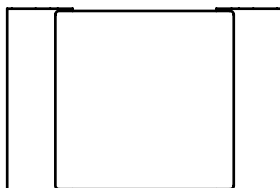

ISOMETRIC

E	15941	EDIT CAP HEIGHT DIMENSION	4/5/06	PH
D	15576	REMOVE BLACK BEZEL	12/2/05	PH
C	15529	ADD SNAP-IN FRAME	11/15/05	PH
B	15486	ADD DIM ON BUSHING	11/2/05	PH
A	15366	RELEASED FOR PRODUCTION	10/25/05	PH
REV	PCR NO	DESCRIPTION	DATE	BY

THE INFORMATION CONTAINED IN THIS DOCUMENT IS PROPRIETARY TO E-SWITCH AND IS NOT TO BE COPIED OR TRANSFERRED

**E-SWITCH®**

TITLE 700SP7M1REAP1BLK

SCALE	DATE	DR	DWG	REV
2:1	10/25/2005	PH	T711062	E