

RECOMMENDED P.C.B. LAYOUT

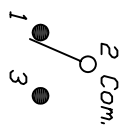

CIRCUIT: SPDT

SWITCH FUNCTION	
DN	$\langle \text{DN} \rangle$
2-1	2-3

< > =MOMENTARY

NOTES:

1. ALL DIMENSIONS IN MM [INCH]
2. GENERAL TOLERANCE: X.X=±0.4
X.XX=±0.25
3. TERM. NOS. FOR REF. ONLY
4. RATING: 3A @120V or 28VDC;
1A @250VAC
5. FIXED TERM. & MOVING CONTACT:
Copper Alloy w/SILVER plate.
6. CONTACT RESISTANCE:
20mlll—ohms initial @2-4VDC.
7. ELECTRICAL LIFE: 60,000 make-and-break
cycles at full load.
8. INSULATION RESISTANCE: 1,000M ohm min.
9. DIELECTRIC STRENGTH: 1000V RMS @sea level
10. OPERATING TEMP.: -30°C to 85°C
11. 2002/95/EC (ROHS) COMPLIANT

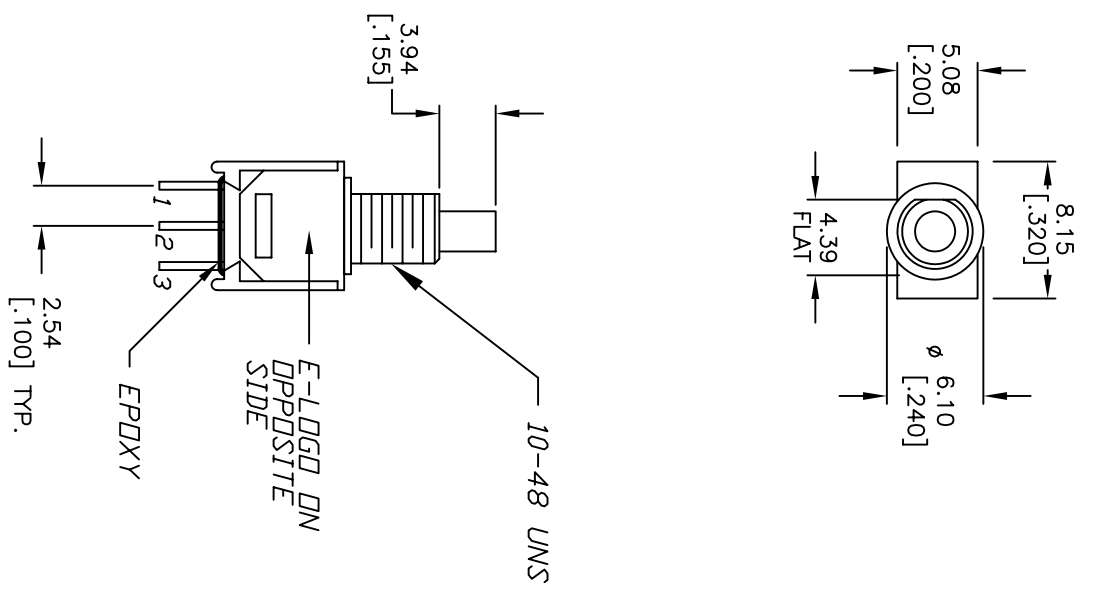
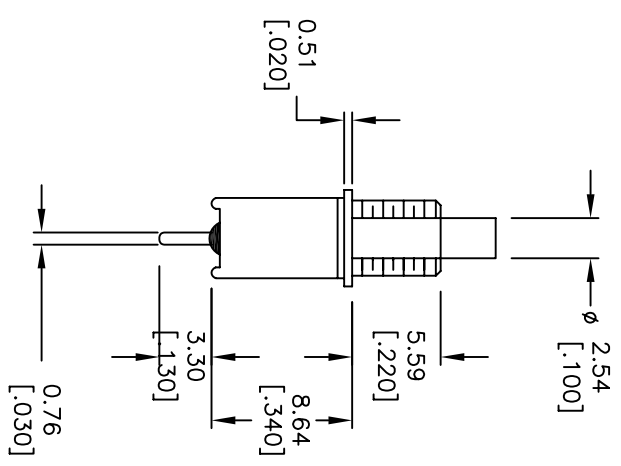

E-SWITCH®

REV.	ECN No.	DESCRIPTION	DATE	CHKD	PH
B	15840	EDIT DIMENSIONS, ROHS NOTE	3/6/06		PH
A	12291	RELEASED	7/5/02		CJB

TITLE	SCALE	DATE	DR	DWG	REV
800 SP-8 B5 M2 Q E	2:1	7/5/02	CB	T822026	B

THE INFORMATION CONTAINED IN THIS DOCUMENT IS PROPRIETARY TO E-SWITCH AND IS NOT TO BE COPIED OR TRANSFERRED