

PARTS LIST

ITEM	QTY	PART NUMBER	DESCRIPTION
1	1	F040017	D16EER13
2	1	F050102	50-001-02 ROUND CONCAVE TRANSPARENT LENS

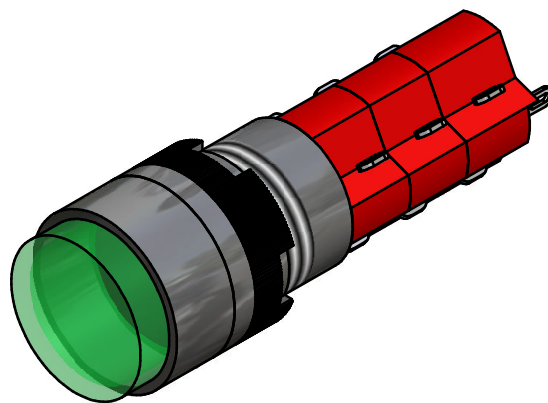

PANEL MOUNTING

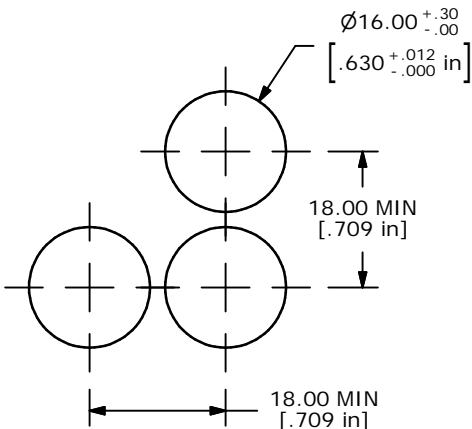
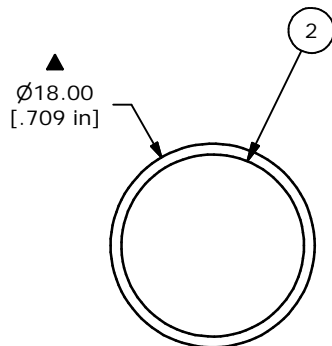
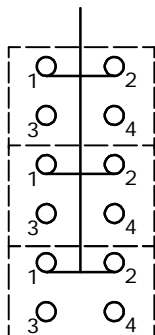

3PDT NO LAMP CONTACT CONFIGURATION

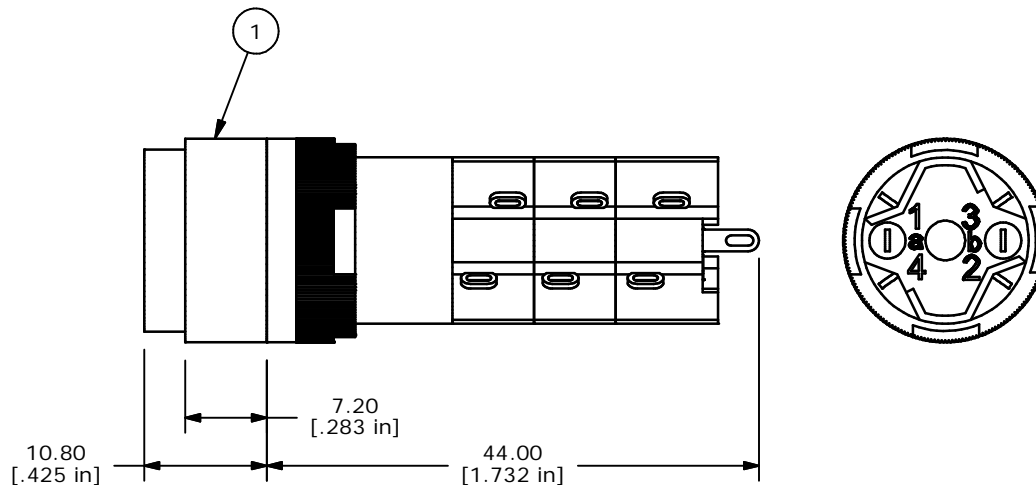

NOTE:

1. ALL DIMENSIONS IN MM [INCH]
2. GENERAL TOLERANCE: X.X=±0.4  
X.XX=±0.25
3. TERMINAL NUMBERS FOR REF ONLY
4. MECHANICAL LIFE: 2,000,000 OPERATIONS
5. INSULATION RESISTANCE: 1,000 MILLI-OHM MIN.
6. OPERATING TEMP.: -25°C to 55°C
- ▲ 7. LAMP VOLTAGE: NO LAMP
8. ▲ DENOTES CRITICAL PARAMETER.



A	14669	RELEASED FOR PRODUCTION	2/4/05	AR
REV	PCR NO	DESCRIPTION	DATE	BY

TITLE D16EER130GRN				
SCALE	DATE	DR	DWG	REV
2:1	2/4/05	AR	XF0260P	A

THE INFORMATION CONTAINED IN THIS DOCUMENT IS PROPRIETARY TO E-SWITCH AND IS NOT TO BE COPIED OR TRANSFERRED