

1.0  
0.2  
3.0  
0.4  
a-L-b (+)

SPST  
CONTACT CONFIGURATION

NOTES:

1. ALL DIMENSIONS IN MM
2. GENERAL TOLERANCE: X.X=±0.4  
X.XX=±0.25
3. RATINGS: 5A @250V AC;  
8A @125V AC
4. CONTACT MATERIAL:  
COPPER ALLOY W/Silver Plating
5. TRAVEL: 3.00mm

PARTS LIST			
ITEM	QTY.	PART NO.	PART DESCRIPTION
1	1	F040009	D16 OA R1 1
2	1	F050111	50-001-11 (Transparent BLU lens)

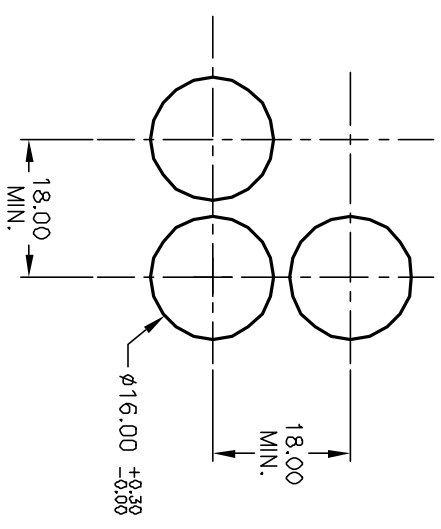

**E-SWITCH®**

TITLE  
D16DAR110BLU  
TRANSPARENT /FLAT LENS

REV.	ECN No.	DESCRIPTION	DATE	CHKD
A	13034	RELEASED FOR PRODUCTION	4/10/03	AR

SCALE	DATE	DR	DWG	REV
1.5:1	4/10/03	AR	XF0299P	A

THE INFORMATION CONTAINED IN THIS DOCUMENT IS PROPRIETARY TO E-SWITCH AND IS NOT TO BE COPIED OR TRANSFERRED