

1 0 1 0 2  
3 0 0 4  
a-L-b (+)

SPST  
CONTACT CONFIGURATION

NOTES:

1. ALL DIMENSIONS IN MM
2. GENERAL TOLERANCE: X.X=±0.4  
X.XX=±0.25
3. RATINGS: 5A @250V AC;  
8A @125V AC
4. CONTACT MATERIAL:  
COPPER ALLOY W/Silver Plating
5. TRAVEL: 3.00mm

PARTS LIST			
ITEM	QTY.	PART NO.	PART DESCRIPTION
1	1	F040009	D16 OA R1 1
2	1	F050112	50-001-12 (Transparent GRN lens)

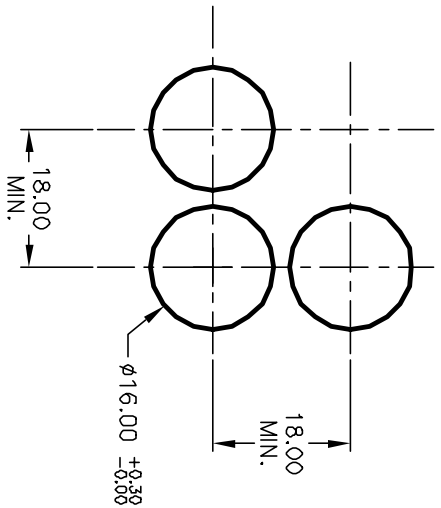

RECOMMENDED PANEL MOUNTING  
SCALE 1:1

**E-SWITCH®**

REV.	ECN No.	DESCRIPTION	DATE	CHKD
A	11573	RELEASED FOR PRODUCTION	11/19/02	CJB

TITLE	SCALE	DATE	DR	DWG	REV
D16 DA R11 0 GRN TRANSPARENT /FLAT LENS	1.5:1	11/19/02	CB	XF0287P	A

THE INFORMATION CONTAINED IN THIS DOCUMENT IS PROPRIETARY TO E-SWITCH AND IS NOT TO BE COPIED OR TRANSFERRED