

1.0
0.2
3.0
0.4
a-L-b (+)

SPST
CONTACT CONFIGURATION

NOTES:

1. ALL DIMENSIONS IN MM
2. GENERAL TOLERANCE: X.X=±0.4
X.XX=±0.25
3. RATINGS: 5A @250V AC;
8A @125V AC
4. CONTACT MATERIAL:
COPPER ALLOY W/Silver Plating
5. TRAVEL: 3.00mm

PARTS LIST			
ITEM	QTY.	PART NO.	PART DESCRIPTION
1	1	F040009	D16 OA R1 1
2	1	F050116	50-001-16 (Transparent YEL lens)

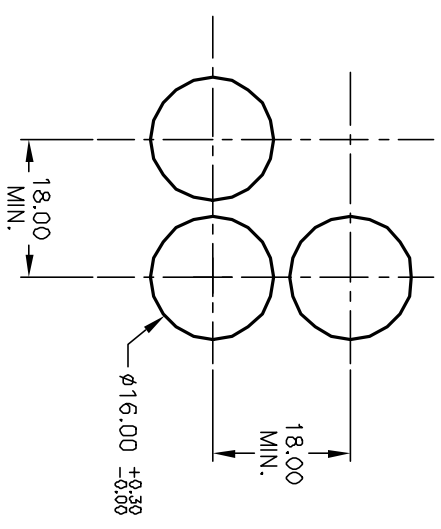

RECOMMENDED PANEL MOUNTING
SCALE 1:1

REV.	ECN No.	DESCRIPTION	DATE	CHKD
A	13033	RELEASED FOR PRODUCTION	4/10/03	AR

TITLE		SCALE	DATE	DR	DWG	REV
D16DAR110YEL TRANSPARENT /FLAT LENS		1.5:1	4/10/03	AR	XF0293P	A

E-SWITCH®

THE INFORMATION CONTAINED IN THIS DOCUMENT IS PROPRIETARY TO E-SWITCH AND IS NOT TO BE COPIED OR TRANSFERRED