

SPST
CONTACT CONFIGURATION

PARTS LIST			
ITEM	QTY.	PART NO.	PART DESCRIPTION
1	1	F040009	D16 OA R1 1
2	1	F050420	50-004-20 (RED LED)
3	1	F050104	50-001-04 (Transparent RED lens)

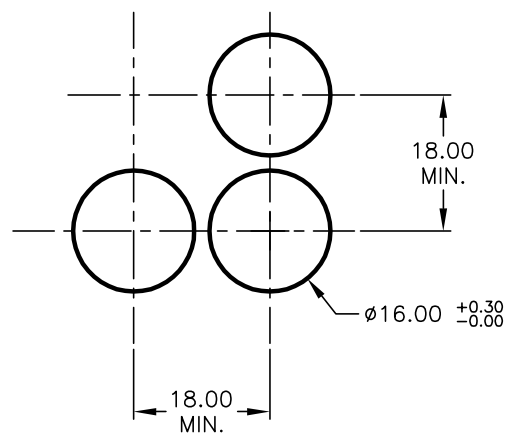

- NOTES:
- ALL DIMENSIONS IN MM
 - GENERAL TOLERANCE: X.X=±0.4
X.XX=±0.25
 - RATINGS: 5A @250V AC
8A @125V AC
 - CONTACT MATERIAL:
COPPER ALLOY W/Silver Plating
 - LAMP VOLTAGE: 12V DC

E-SWITCH®				
TITLE D16OAR11JREDRED				
SCALE	DATE	DR	DWG	REV
1.5:1	5/26/04	AR	XF0311P	A

REV.	ECN No.	DESCRIPTION	DATE	CHKD
A	14039	RELEASED FOR PRODUCTION	5/26/04	AR

THE INFORMATION CONTAINED IN THIS DOCUMENT IS PROPRIETARY TO E-SWITCH AND IS NOT TO BE COPIED OR TRANSFERRED