

1.0  
3.0  
a-L-b (+)

SPST  
CONTACT CONFIGURATION

NOTES:

1. ALL DIMENSIONS IN MM
2. GENERAL TOLERANCE: X.X=±0.4  
X.XX=±0.25
3. RATINGS: 5A @250V AC  
8A @125V AC
4. CONTACT MATERIAL:  
COPPER ALLOY W/Silver Plating

| PARTS LIST |      |          |                                  |
|------------|------|----------|----------------------------------|
| ITEM       | QTY. | PART NO. | PART DESCRIPTION                 |
| 1          | 1    | F040008  | D16 OA S1 1                      |
| 2          | 1    | F050314  | 50-003-14 (TRANSPARENT RED lens) |

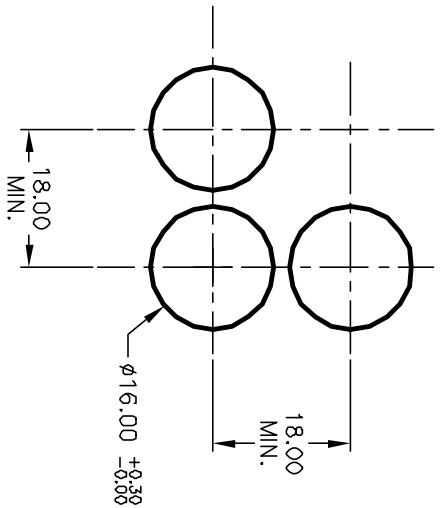

RECOMMENDED PANEL MOUNTING  
SCALE 1:1

| REV. | ECN No. | DESCRIPTION             | DATE    | CHKD |
|------|---------|-------------------------|---------|------|
| A    | 12923   | RELEASED FOR PRODUCTION | 3/20/03 | AR   |

| TITLE   | SCALE | DATE    | DR | DWG     | REV |
|---|-------|---------|----|---------|-----|
| D16 OA S11 0 RED (Momentary)<br>TRANSPARENT/FLAT LENS | 1.5:1 | 3/20/03 | AR | XF0245P | A   |



THE INFORMATION CONTAINED IN THIS DOCUMENT IS PROPRIETARY TO E-SWITCH AND IS NOT TO BE COPIED OR TRANSFERRED