

1 0 1 0 2  
3 0 0 4  
a-L-b (+)

SPST  
CONTACT CONFIGURATION

PARTS LIST			
ITEM	QTY.	PART NO.	PART DESCRIPTION
1	1	F040008	D16 OA S1 1
2	1	F050422	50-004-22 (GRN L.E.D.)
3	1	F050305	50-003-05 (Transparent WHT lens)

NOTES:

1. ALL DIMENSIONS IN MM
2. GENERAL TOLERANCE: X.X=±0.4  
X.XX=±0.25
3. RATINGS: 5A @250V AC  
8A @125V AC
4. TRAVEL: 3.0mm
5. CONTACT MATERIAL:  
COPPER ALLOY W/Silver Plating
6. LAMP VOLTAGE: 24V DC L.E.D.

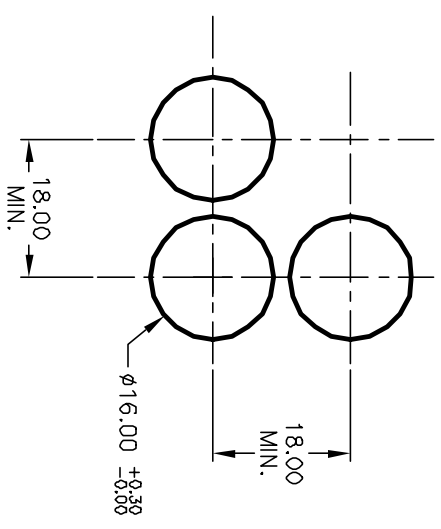

RECOMMENDED PANEL MOUNTING  
SCALE 1:1

REV.	ECN No.	DESCRIPTION	DATE	CHKD
A	12199	RELEASE FOR PRODUCTION	5/30/02	CJB

TITLE	SCALE	DATE	DR	DWG	REV
D16 DA S11 K GRN WHT TRANSPARENT/CONCAVE LENS	1.5:1	5/30/02	CB	XF0475P	A

**E-SWITCH®**

THE INFORMATION CONTAINED IN THIS DOCUMENT IS PROPRIETARY TO E-SWITCH AND IS NOT TO BE COPIED OR TRANSFERRED