

1 0 1 0 2
 3 0 0 4
 a-(L)-b(+)

SPST
 CONTACT CONFIGURATION

PARTS LIST			
ITEM	QTY.	PART NO.	PART DESCRIPTION
1	1	F040007	D16 OA T1 1
2	1	F050201	50-002-01 (BLUE OPAQUE LENS)

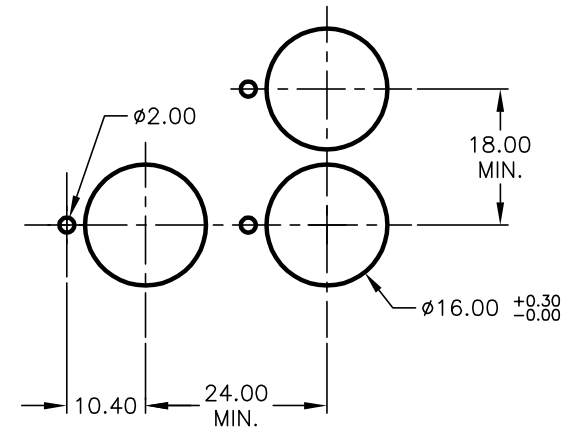

NOTES:

- ALL DIMENSIONS IN MM
- GENERAL TOLERANCE: X.X=±0.4
 X.XX=±0.25
- RATINGS: 5A @250V AC
 8A @125V AC
- TRAVEL: 3.0mm
- CONTACT MATERIAL:
 COPPER ALLOY W/Silver Plating
- LAMP VOLTAGE: 6V DC

E-SWITCH®

A	13538	RELEASE FOR PRODUCTION	10/15/03	AR
REV.	ECN No.	DESCRIPTION	DATE	CHKD

TITLE D16 OA T11 0 BLU (MOMENTARY)				
SCALE 1.5:1	DATE 10/15/03	DR AR	DWG XF0185P	REV A

THE INFORMATION CONTAINED IN THIS DOCUMENT
 IS PROPRIETARY TO E-SWITCH AND IS
 NOT TO BE COPIED OR TRANSFERRED