

SPST
CONTACT CONFIGURATION

PARTS LIST			
ITEM	QTY.	PART NO.	PART DESCRIPTION
1	1	F040007	D16 OA T1 1
2	1	F050405	50-004-05 (Incandescent Bulb)
3	1	F050205	50-005-05 (Transparent WHT lens)

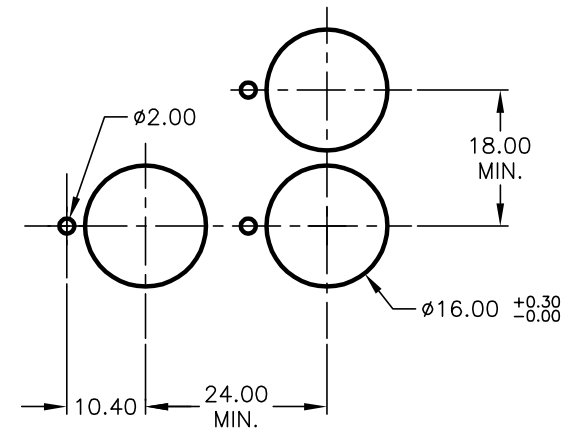

RECOMMENDED PANEL MOUNTING

SCALE 1:1

NOTES:

1. ALL DIMENSIONS IN MM
2. GENERAL TOLERANCE: X.X=±0.4
X.XX=±0.25
3. RATINGS: 5A @250V AC
8A @125V AC
4. TRAVEL: 3.0mm
5. CONTACT MATERIAL:
COPPER ALLOY W/Silver Plating
6. LAMP VOLTAGE: 28V AC/DC 40mA

E-SWITCH®

TITLE

D16 OA T11 C WHT (MOMENTARY)

A	13740	RELEASE FOR PRODUCTION	1/27/04	AR
REV.	ECN No.	DESCRIPTION	DATE	CHKD

SCALE

1.5:1

DATE

1/27/04

DR

AR

DWG

XF0331P

REV

A

THE INFORMATION CONTAINED IN THIS DOCUMENT
IS PROPRIETARY TO E-SWITCH AND IS
NOT TO BE COPIED OR TRANSFERRED