

RECOMMENDED PCB LAYOUT

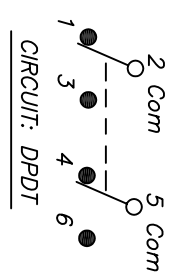

SWITCH FUNCTION		
POS. 1	POS. 2	POS. 3
DN	OFF	DN
2-3,5-6	OPEN	2-1,4-5

NOTES:

1. ALL DIMENSIONS IN MM [INCH]
2. GENERAL TOLERANCE: X.X=±0.4 X.XX=±0.25
3. TERM. NOS. FOR REF. ONLY
4. RATING: 5A @120VAC OR 28VDC 2A @250VAC
5. MATERIAL: FIXED TERMINAL & MOVING CONTACT  
 Copper Alloy w/Silver Plate  
 CONTACT RESISTANCE: 10mILLI Ohms max initial @2-4VDC, 100mA for AG & AU  
 ELECTRICAL LIFE: 30,000 make-and-break cycles at full load.  
 INSULATION RESISTANCE: 1,000M ohm min.  
 DIELECTRIC STRENGTH: 1000V RMS @sea level  
 OPERATING TEMP.: -30°C to 85°C  
 ▲ DENOTES CRITICAL PARAMETER.  
 2002/95/EC (ROHS) COMPLIANT

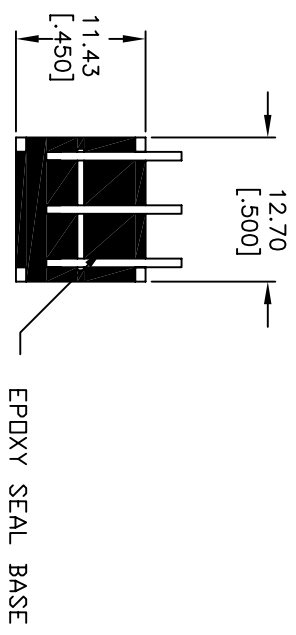
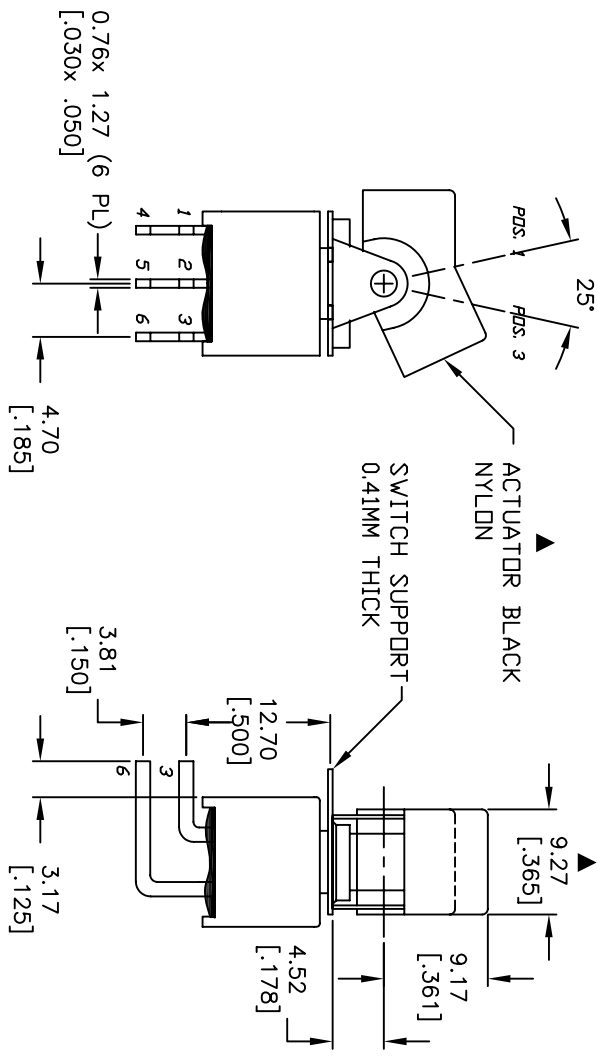
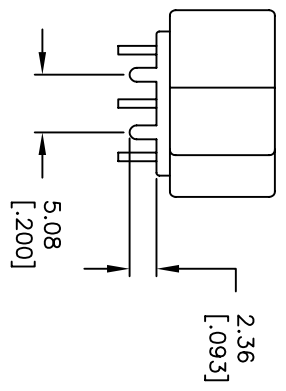

REV.	ECN No.	DESCRIPTION	DATE	CHKD	TN
B	17403	UPDATE NOTES, SWITCH FUNCTION	6/20/07	AR	
A	13252	RELEASED FOR PRODUCTION	6/27/03	AR	

TITLE	SCALE	DATE	DR	DWG	REV
300AWDP3U1M6QE	2:1	6/20/07	TN	T302108	B

THE INFORMATION CONTAINED IN THIS DOCUMENT IS PROPRIETARY TO E-SWITCH AND IS NOT TO BE COPIED OR TRANSFERRED