

RECOMMENDED PANEL MOUNTING

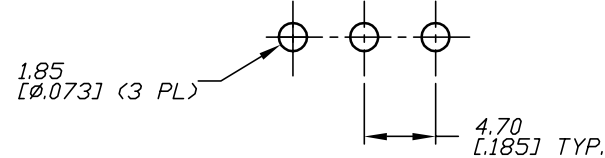

RECOMMENDED PCB LAYOUT

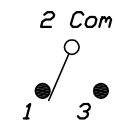

CIRCUIT: SPDT
CONTACT CONFIGURATION

SWITCH FUNCTION		
PDS. 1	PDS. 2	PDS. 3
ON	NONE	ON
2-3	OPEN	2-1

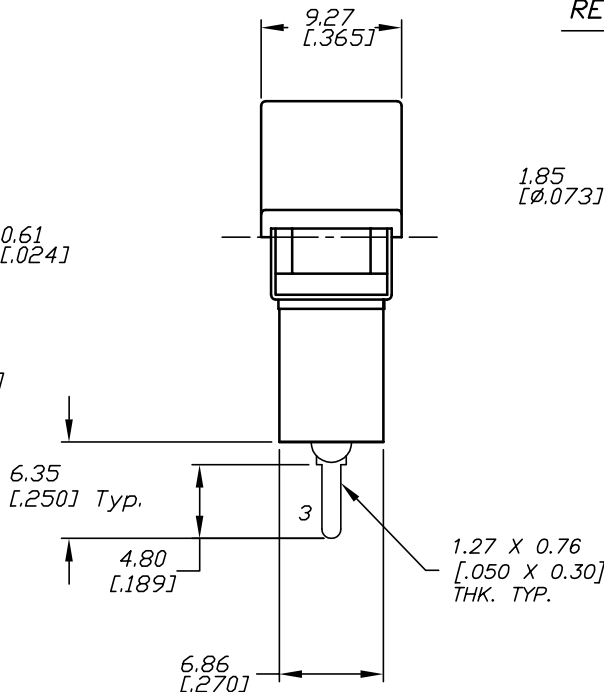

NOTES:

1. ALL DIMENSIONS IN MM [IN]
2. GENERAL TOLERANCE: 0.0=±0.4, 0.00=±0.25
3. TERM. NOS. FOR REF ONLY
4. CONTACT RATING: 5A @120VAC or 28VDC; 2A @250VAC
5. ELECTRICAL LIFE: 50,000 MAKE AND BREAK AT FULL LOAD
6. INSULATION RESISTANCE: 1,000 MEGA-OHM MIN
7. DIELECTRIC STRENGTH: 1,000V RMS @SEA LEVEL
8. OPERATION TEMP.: -30°C TO +85°C

E-SWITCH®

B	1115	REVISED & REDRAWN	12/13/00	PML
A	11025	RELEASED FOR PRODUCTION	10/25/00	PML
REV.	ECN No.	DESCRIPTION	DATE	CHKD

TITLE				
300 SP-1 R1 M2 Q E				
SCALE	DATE	DR	DWG	REV
2:1	10/25/00	PML	T311003	B

THE INFORMATION CONTAINED IN THIS DOCUMENT IS PROPRIETARY TO E-SWITCH AND IS NOT TO BE COPIED OR TRANSFERRED