

RECOMMENDED P.C.B. LAYOUT

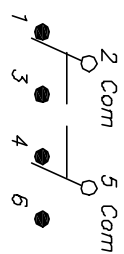

CIRCUIT: DPDT  
CONTACT CONFIGURATION

SWITCH FUNCTION		
PDS: 1	PDS: 2	PDS: 3
DN	NONE	LDN1
2-3,5-6	OPEN	2-1,5-4

(B)

[ J ] =MENTARY

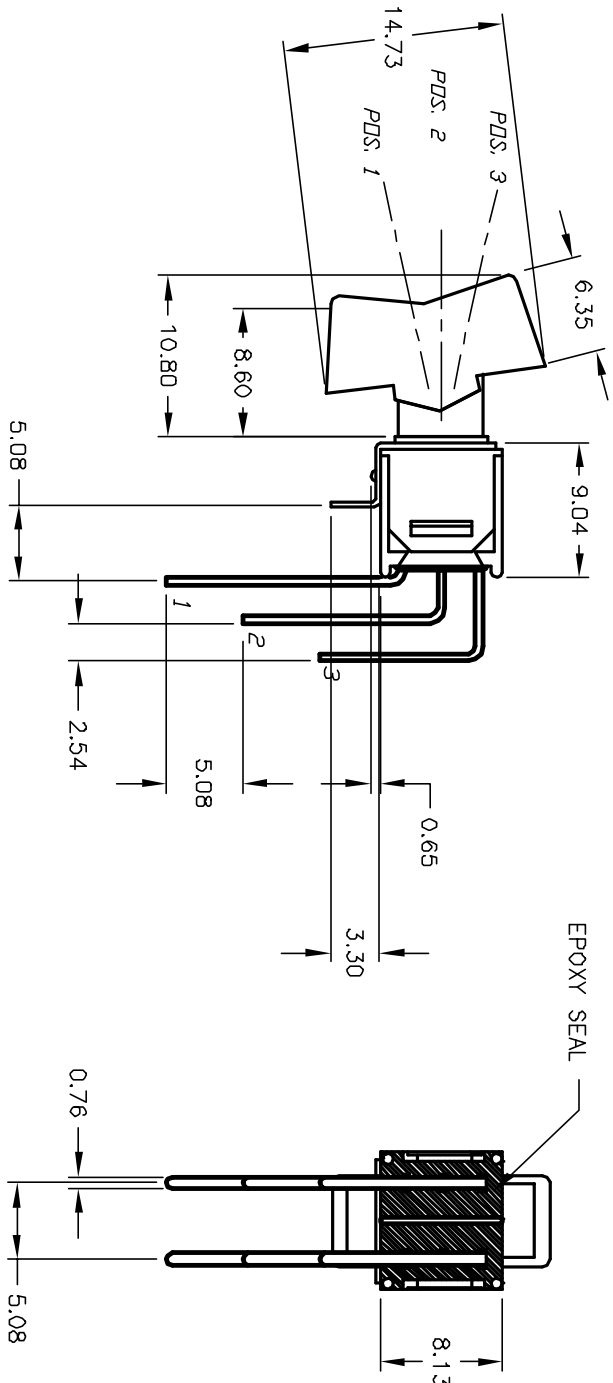
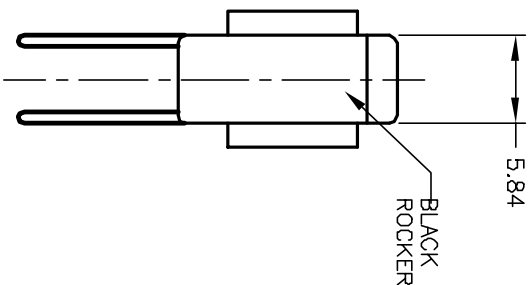

NOTES:

1. ALL DIMENSIONS IN MM
2. GENERAL TOLERANCE: X.X=±0.4  
X.XX=±0.25
3. TERM. NOS. FOR REF. ONLY
4. RATING: 3A @120VAC, OR 28VDC  
1A @250VAC
5. FIXED TERMINAL/MOVING CONTACT MATERIAL:  
COPPER ALLOY w/SILVER PLATING
6. ELECTRIC LIFE: 30,000 make-and-break cycles  
at full load.
7. INSULATION RESISTANCE: 1,000 M ohm min.
8. DIELECTRIC STRENGTH: 1,000 V RMS @sea level.
9. OPERATING TEMP. -30°C to +85°C
10. ▲ DESIGNATE MAJOR FEATURE

**E-SWITCH®**

REV. B		TITLE		SCALE		DATE		DR		DWG		REV	
12074		400 MDP-2 R6 (BLK) M7 QE		2:1		2/8/02		CJB		T421007		B	
FUNCTION WAS CON OFF ON1		DATE		CHKD		CJB		DESCRIPTION		THE INFORMATION CONTAINED IN THIS DOCUMENT IS PROPRIETARY TO E-SWITCH AND IS NOT TO BE COPIED OR TRANSMITTED			
ECN NO.		DATE		CHKD		CJB		DESCRIPTION		THE INFORMATION CONTAINED IN THIS DOCUMENT IS PROPRIETARY TO E-SWITCH AND IS NOT TO BE COPIED OR TRANSMITTED			