

PANEL THICKNESS	X dimension
0.75-1.25 [0.30-.049]	19.2-.01 [7.56]
1.25-2.0 [0.49-.079]	19.4-.01 [7.64]
2.0-3.0 [0.79-.118]	19.8-.01 [7.80]

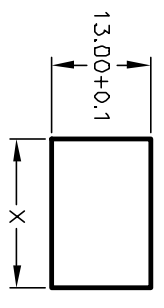

SWITCH FUNCTION	
PDS. 1	PDS. 3
DN	<DN>
1a-1	1-1b

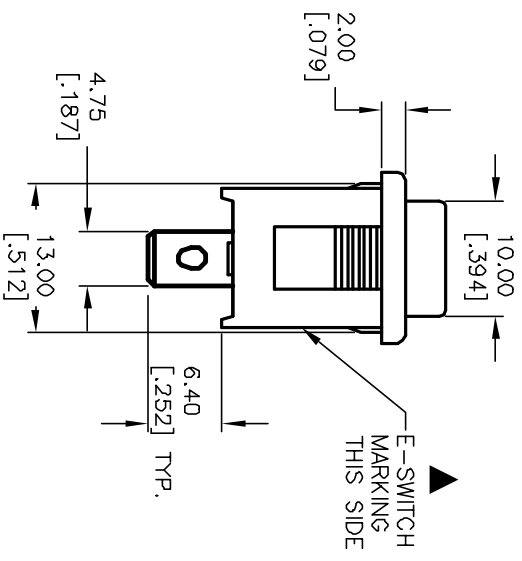
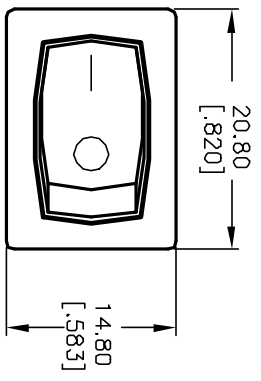
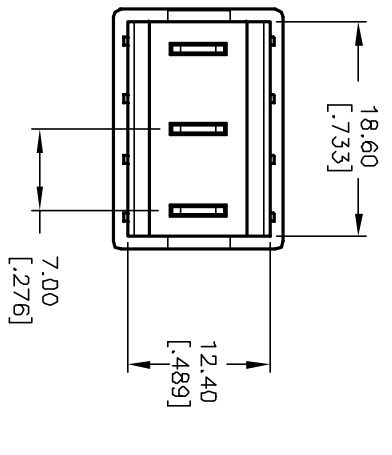
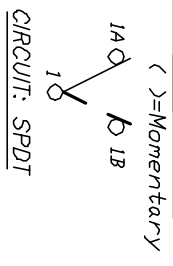

- NOTES:
1. ALL DIMENSIONS IN MM [INCH]
  2. GENERAL TOLERANCE: X.X=±0.4  
X.XX=±0.25
  3. TERMINAL NUMBERS FOR REF ONLY
  4. RATING: 15A @ 125VAC OR  
6A @ 250VAC
  5. MATERIALS: TERMINALS: Silver Plated Copper Alloy  
CONTACTS: Coin Silver, Silver Plated
  6. ELECTRIC LIFE: 10,000 cycles
  7. CONTACT RESISTANCE: <20 Mega Ω
  8. INSULATION RESISTANCE: >1000 Mega Ω
  9. DIELECTRIC STRENGTH: >1500 V 1 minute  
>3000 V between poles

# E-SWITCH®

TITLE		R1966G BLK BLK FF	
REV.	ECN No.	DATE	CHKD
A	12426	9/16/02	CJB
DESCRIPTION		SCALE	DATE
RELEASED		1.5:1	9/16/02
THE INFORMATION CONTAINED IN THIS DOCUMENT IS PROPRIETARY TO E-SWITCH AND IS NOT TO BE COPIED OR TRANSFERRED		DR	REV
		CB	A
		DWG	M304213