

PANEL THICKNESS	X dimension
0.75-1.25 [0.030-0.049]	19.2-01 [0.756]
1.25-2.0 [0.049-0.079]	19.4-01 [0.764]
2.0-3.0 [0.079-0.118]	19.8-01 [0.780]

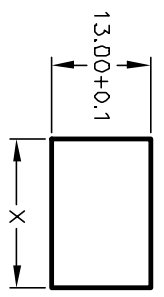

PANEL CUTOUT  
NDT TO SCALE

SWITCH FUNCTION		
POS. 1	POS. 2	POS. 3
<DN>	OFF	<DN>
1-1a	OPEN	1-1b

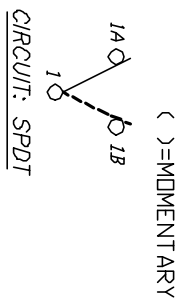

NOTES:

1. ALL DIMENSIONS IN MM [INCH]
2. GENERAL TOLERANCE: X.X=±0.4 X.XX=±0.25
3. TERMINAL NUMBERS FOR REF ONLY
4. RATING: 15A @ 125VAC OR 6A @ 250VAC
5. APPROVALS: UL, CSA, NEMKO, SEMKO, FEMKO, DEMKO
6. MATERIALS: TERMINALS: Silver Plated Copper Alloy CONTACTS: Coin Silver, Silver Plated
7. ELECTRIC LIFE: 10,000 cycles
8. CONTACT RESISTANCE: <20 Mega-OHM
9. INSULATION RESISTANCE: >1000 Mega-OHM
10. DIELECTRIC STRENGTH: >1500 V 1 minute >3000 V between poles

**E-SWITCH®**

REV.	ECN No.	REVISION PART DESCRIPTION	DATE	CHKD
B	12061	REVISED PART DESCRIPTION	4/16/02	CJB
DESCRIPTION				
THE INFORMATION CONTAINED IN THIS DOCUMENT IS PROPRIETARY TO E-SWITCH AND IS NOT TO BE COPIED OR TRANSFERRED				

TITLE	SCALE	DATE	DR	DWG	REV
R19661 BLK BLK GS	1.5:1	1/15/99	MM	M306206	B