

PANEL THICKNESS	X
0.75-1.25	19.20
1.25-2.0	19.40
2.0-3.0	19.60

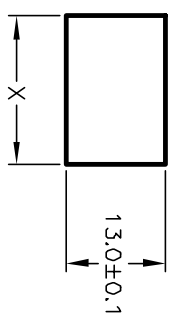

PANEL CUTOUT
NOT TO SCALE



CIRCUIT: SPST

SWITCH FUNCTION	POS. 1	POS. 2
DN	DN	OFF
1-1a	1-1a	OPEN

CONTACT CONFIGURATION

NOTES:

1. ALL DIMENSIONS IN MM
2. GENERAL TOLERANCE: X.X=±0.4
X.XX=±0.25
3. RATING: 6A @250VAC; 9A @125VAC (UL/CSA)
4(1) A @250VAC (VDE, SEMEKO, NEMKO, DEMKO, FIMKO)
4. CONTACT RESISTANCE: 20 MLLLDHMS TYP INITIAL.
5. INSULATION RESISTANCE: 1000 MEGAOHMS
6. DIELECTRIC STRENGTHS: 1500V RMS MIN. @SEA LEVEL.
3000V RMS @SEA LEVEL.
7. MECHANICAL LIFE: 50,000 CYCLES.
8. ELECTRICAL LIFE: 10,000 CYCLES.

E-SWITCH®

REV.	ECN No.	DESCRIPTION	DATE	CHKD
C	11593	REVISED PART DESCRIPTION	8/2/01	CJB

TITLE	SCALE	DATE	DR	DWG	REV
R1973 A BLK BLK EF 0	1.5:1	8/2/01	CJB	M400005	C

THE INFORMATION CONTAINED IN THIS DOCUMENT IS PROPRIETARY TO E-SWITCH AND IS NOT TO BE COPIED OR TRANSFERRED