

RECOMMENDED PANEL MOUNTING

PANEL THICKNESS	X
0.75-1.25	30.0-30.2
1.25-2.00	30.2-30.4
2.00-3.00	30.6-30.8

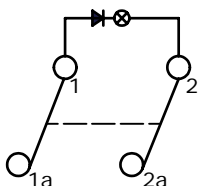

CIRCUIT: DPST
ON-OFF ILLUMINATED

SWITCH FUNCTION		
POS. 1	POS. 2	POS. 3
ON	NONE	OFF
1-1a,2-2a	N/A	OPEN

- NOTES:
- ALL DIMENSIONS IN MM [INCH]
 - GENERAL TOLERANCE: X.X=±0.4
X.XX=±0.25
 - TERM. NOS. FOR REF. ONLY
 - ▲4. RATING: 20A @125VAC;
16A @250VAC.
 - MATERIAL:
CONTACT SURFACE: SILVER ALLOY
TERMINAL: COPPER ALLOY w/SILVER PLATE
 - ELECTRICAL LIFE: 10,000 CYCLES
 - MECHANICAL LIFE: 30,000 CYCLES
 - CONTACT RESISTANCE: <20 mΩ INITIAL
 - DIELECTRIC STRENGTH: >1,500V AC 1MIN
 - ▲DENOTES CRITICAL PARAMETER.
 - LAMP: NEON, 250 VAC
 - 2002/ 95/ EC(ROHS) COMPLIANT

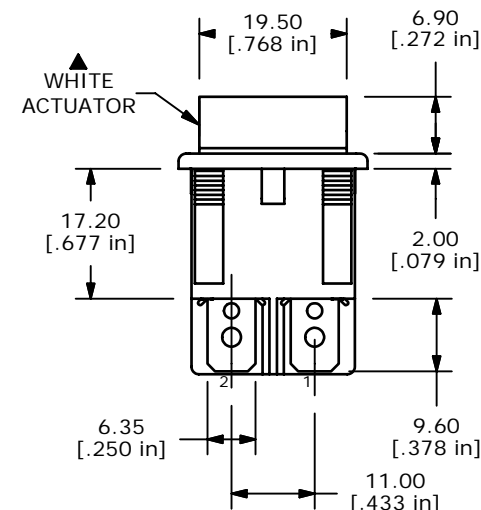
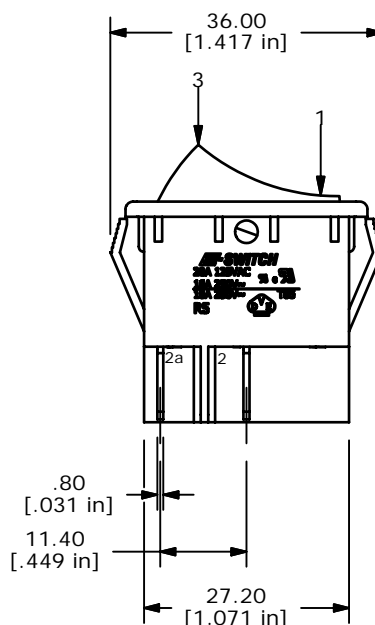
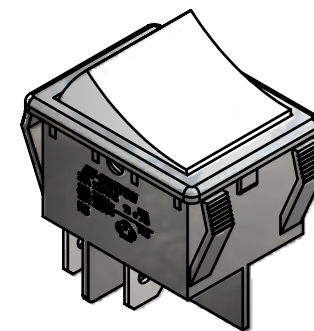
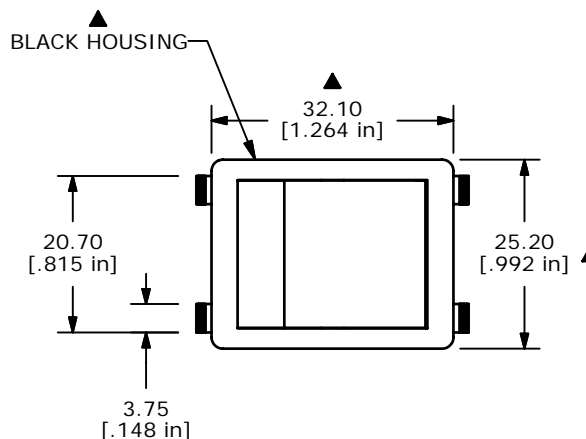

REV	PCR NO	DESCRIPTION	DATE	BY
B	16502	CHANGED FROM 15A TO 16A.	10/02/2006	TN
A	16495	RELEASED FOR PRODUCTION	9/29/2006	TN

TITLE R5BBLKWHITEF2				
SCALE 1:1	DATE 9/29/2006	DR TN	DWG M050252	REV B

THE INFORMATION CONTAINED IN THIS DOCUMENT IS PROPRIETARY TO E-SWITCH AND IS NOT TO BE COPIED OR TRANSFERRED