

PANEL THICKNESS	X dimension
0.75~1.25 [0.30~.049]	30.0 +0.2 [1.181]
1.25~2.0 [0.49~.079]	30.2 +0.2 [1.189]
2.0~3.0 [0.79~.118]	30.6 +0.2 [1.205]

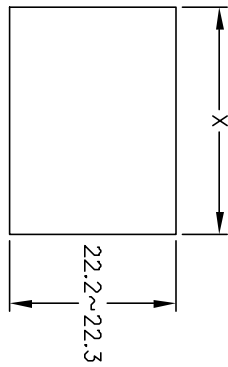

RECOMMENDED PANEL MOUNTING
NOT TO SCALE
(ILLUMINATED)

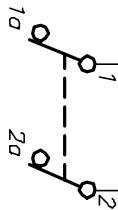

CIRCUIT: DPST
ON-OFF

NOTES:

1. ALL DIMENSIONS IN MM [INCH]
2. GENERAL TOLERANCE: X.X=±0.4
X.XX=±0.25
3. TERM. NOS. FOR REF. ONLY
4. RATING: 20A @125VAC;
15A @250VAC. (Normal Conditions)
5. LAMP VOLTAGE: 12V DC (Incandescent Bulb)
6. MATERIAL:
CONTACT SURFACE: Coin Silver, Silver Plated.
TERMINAL: Copper ALLOY w/Silver plate
7. ELECTRICAL LIFE: ≥10,000 cycles
8. MECHANICAL LIFE: 30,000 cycles
9. CONTACT RESISTANCE: <20 mΩ—Ohms initial
10. DIELECTRIC STRENGTH: >1,500V AC 1min
>3,000V between poles.

YELLOW ILLUMINATED
ACTUATOR
BLACK BODY/HOUSING

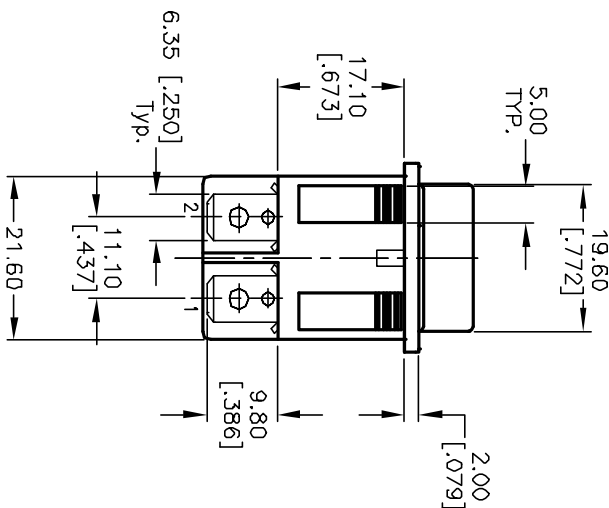
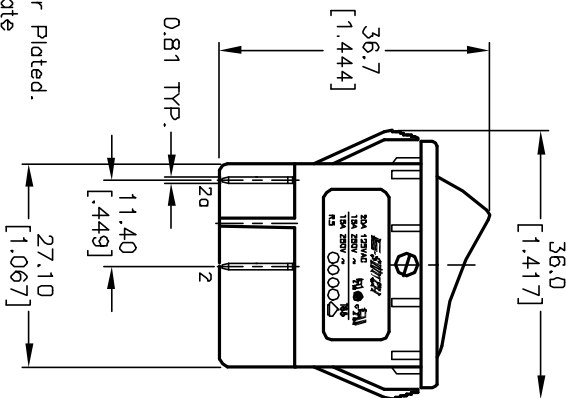
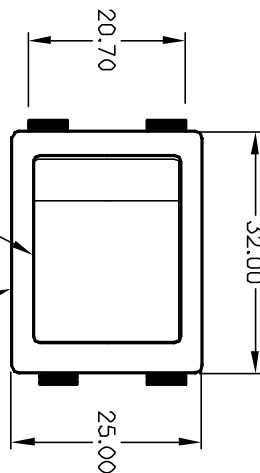

INCANDESCENT BULB		
PARAMETERS	SYMBOL	MAX. UNITS
LAMP VOLTAGE (AC/DC)	V	12 V
POWER DISSIPATION	P _d	2 Watts
CURRENT	I	100 mA

REV.	ECN No.	DESCRIPTION	DATE	CHKD	AR	TITLE	SCALE	DATE	DR	DWG	REV
A	13046	RELEASED FOR PRODUCTION	4/15/03		AR	RSBBLKYELEF3	1:1	4/15/03	AR	M050229	A
<p>E-SWITCH®</p>											
<p>THE INFORMATION CONTAINED IN THIS DOCUMENT IS PROPRIETARY TO E-SWITCH AND IS NOT TO BE COPIED OR TRANSFERRED</p>											