

MARKING "J"

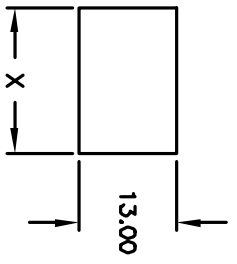
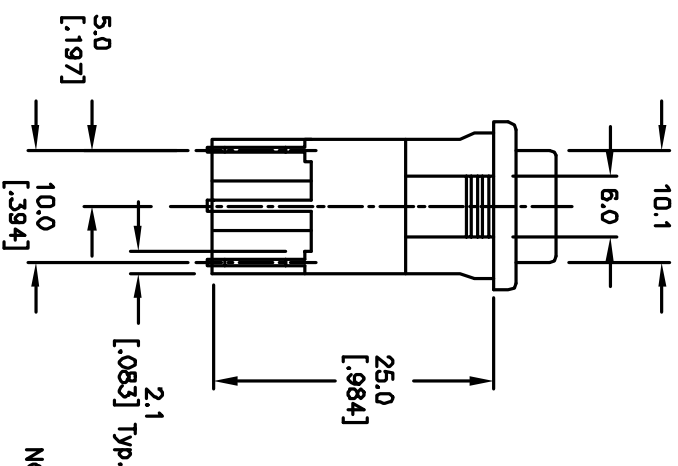
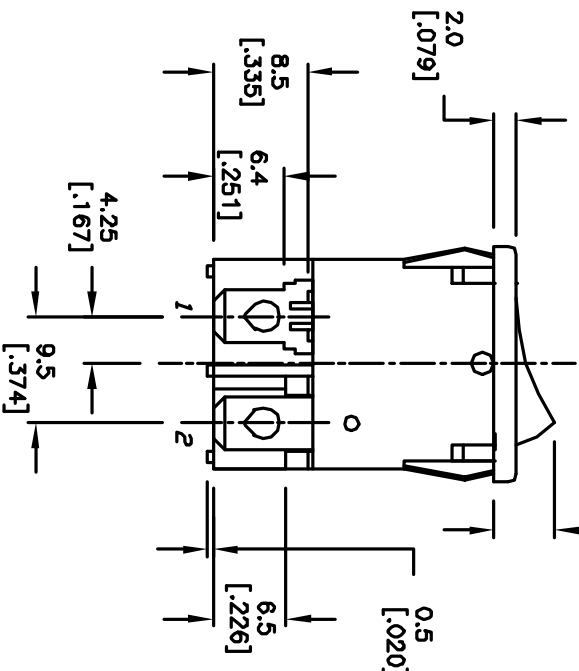

RECOMMENDED PANEL MOUNTING

NOT TO SCALE

PANEL THICKNESS	X
0.75-1.25 (0.030-0.049)	19.2 (7.56)
1.25-2.0 (0.049-0.079)	19.4 (7.64)

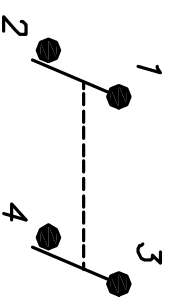

CIRCUIT: DPST

NOTES:

1. ALL DIMENSIONS IN MM [INCH]
2. GENERAL TOLERANCE: X.X=±0.4
X.XX=±0.25
3. TERM. NDS. FOR REF. ONLY
4. RATING: AC 125V 12A, AC 250V 8A
5. MECHANICAL LIFE: 15,000 cycles
6. ELECTRICAL LIFE: 10,000 cycles
7. CONTACT RESISTANCE: 10mΩ-Ohms
8. INSULATION RESISTANCE: >1000MΩ-Ohms
9. DIELECTRIC STRENGTH: 1,500 Volts for 1min.
3,000 Volts between poles
10. OPERATING TEMP: -30°C to 85°C
11. HOUSING/ACTUATOR COLOR: BLACK
12. SEE DESIGNATED ROCKER MARKING
13. ▲ DESIGNATE CRITICAL PARAMETER:

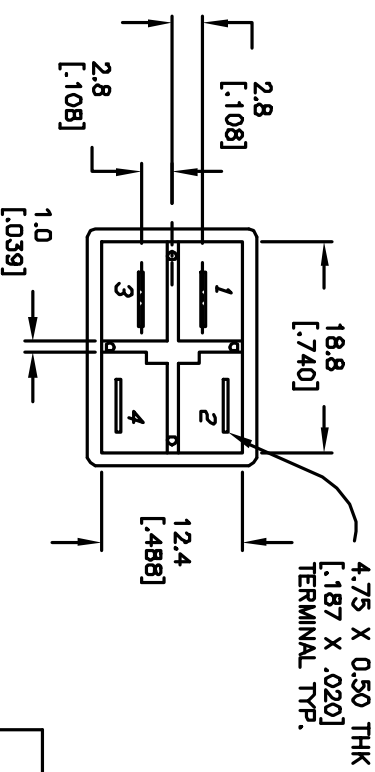

4.75 X 0.50 THK
[0.187 X 0.020]
TERMINAL TYP.

REV.	ECN NO.	DESCRIPTION	DATE	CHKD
A	12538	RELEASED	11/5/02	CB

TITLE	SCALE	DATE	DR	JWG	REV
RC1083B BLK BLK JF	1.5/1	11/5/02	CB	P301506	A

E-SWITCH®

THE INFORMATION CONTAINED IN THIS DOCUMENT IS PROPRIETARY TO E-SWITCH AND IS NOT TO BE COPIED OR TRANSMITTED