

2.16mm TRAVEL TO MAKE

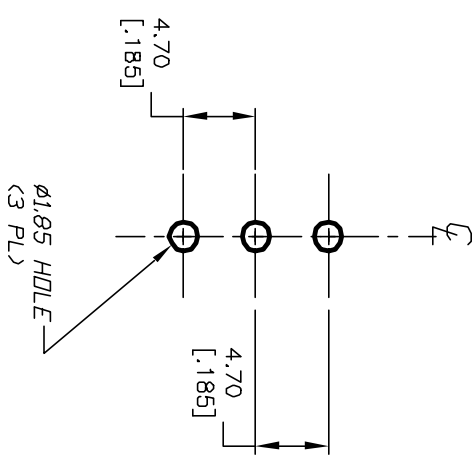
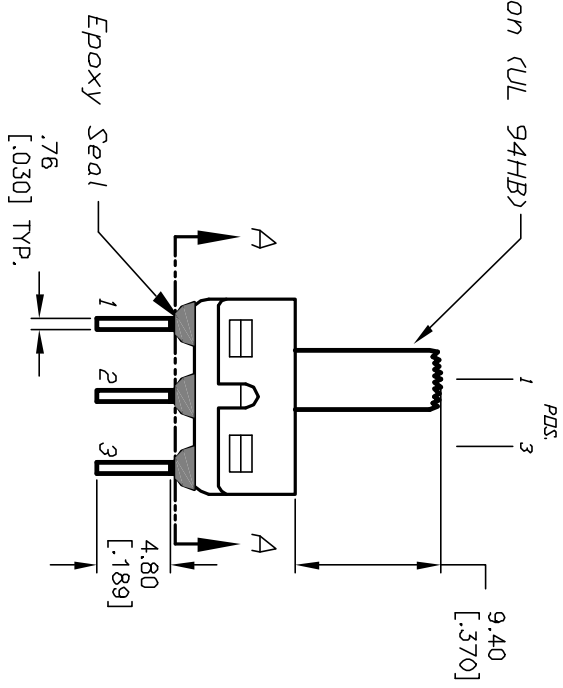
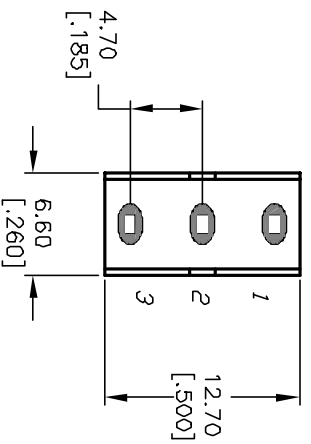
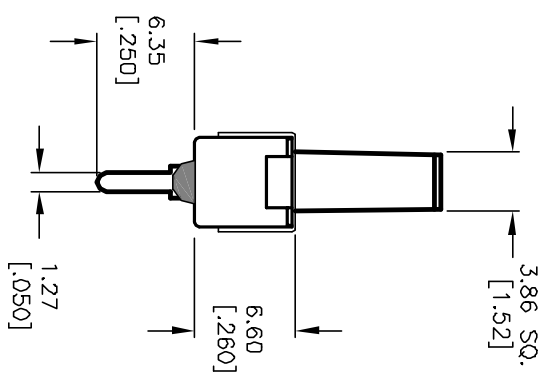

RECOMMENDED P.C.B. LAYOUT

NOTES:

1. ALL DIMENSIONS IN MM [INCH]
2. GENERAL TOLERANCE: X.X=±0.4 X.XX=±0.25
3. TERM NOS. FOR REF. ONLY
4. RATING: 0.4VA @20V max. (AC or DC)
5. CONTACT MATERIAL:
Copper Alloy w/Gold plate over
Nickle plate.
6. ELECTRICAL LIFE: 30,000 ACTUATIONS @Full Load
7. INSULATION RESISTANCE: 1000 Mega Ohms min.
8. DIELECTRIC STRENGTH: 1000V RMS @SEA LEVEL.
9. OPERATING TEMPERATURE: -30C TO 85C

CIRCUIT: SPDT

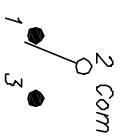

SWITCH FUNCTION			
PDS. 1	PDS. 2	PDS. 3	
DN	NONE	<DN>	
2-1	DPEN	2-3	

< >=Momentary

REV.	ECN No.	DESCRIPTION	DATE	CHKD
A	11645	RELEASED	1/13/03	CJB

TITLE	SCALE	DATE	DR	DWG	REV
500 SSP-2 S3 M2 R E A (GOLD CONTACTS)	2:1	1/13/03	CJB	TS12034	A

E-SWITCH®

THE INFORMATION CONTAINED IN THIS DOCUMENT IS PROPRIETARY TO E-SWITCH AND IS NOT TO BE COPIED OR TRANSFERRED