

RECOMMENDED PANEL CUTOUT

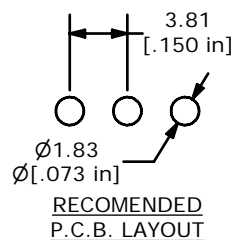

RECOMMENDED P.C.B. LAYOUT

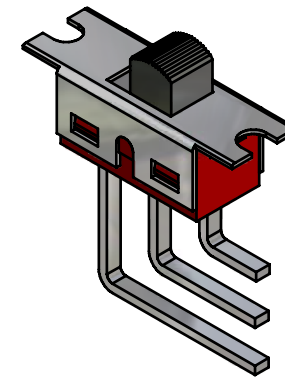
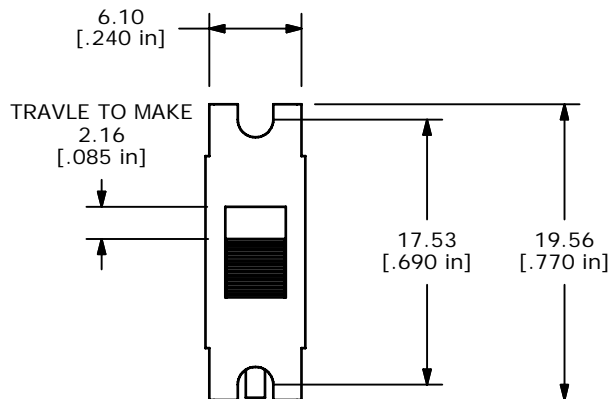

ISOMETRIC

B ▲

| SWITCH FUNCTION | | |
|-----------------|--------|--------|
| POS. 1 | POS. 2 | POS. 3 |
| | | |
| ON | NONE | (ON) |
| 2-1 | OPEN | 2-3 |

(ON)=MOMENTARY

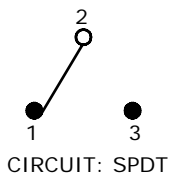

CIRCUIT: SPDT

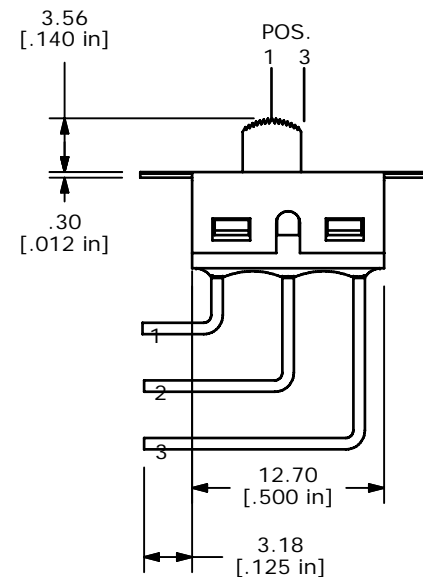
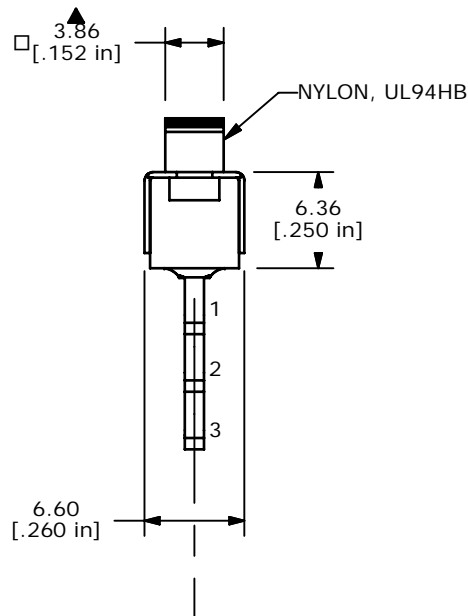

NOTE:

- ALL DIMENSIONS IN MM [INCH]
- GENERAL TOLERANCE: X.X=±0.4
X.XX=±0.25
- TERMINAL NUMBERS FOR REF ONLY
- PLATING MATERIAL: GOLD
- RATING: 0.4 (VA) MAX. @20V MAX.
- ELECTRIC LIFE: 30,000 ACTUATIONS AT FULL LOAD.
- INSULATION RESISTANCE: 1,000 MEGA-OHM MIN.
- DIELECTRIC STRENGTH: 1,000 V RMS @SEA LEVEL.
- OPERATING TEMP.: -30°C to 85°C
- ▲ DENOTES CRITICAL PARAMETER.

| | | | | |
|-----|--------|-------------------------|---------|----|
| C | 15077 | Dim 3.18 was 2.69 | 7/20/05 | RC |
| B | 14975 | CHANGED FUNCTION TABLE | 6/3/05 | JB |
| A | 14916 | RELEASED FOR PRODUCTION | 5/18/05 | JB |
| REV | PCR NO | DESCRIPTION | DATE | BY |

THE INFORMATION CONTAINED IN THIS DOCUMENT IS PROPRIETARY TO E-SWITCH AND IS NOT TO BE COPIED OR TRANSFERRED

E-SWITCH®

TITLE 500SSP2S4M7REB

| | | | | |
|-----------|----------------|-------|-------------|-------|
| SCALE 2:1 | DATE 5/18/2005 | DR JB | DWG T505000 | REV C |
|-----------|----------------|-------|-------------|-------|