

RECOMMENDED P.C.B. LAYOUT

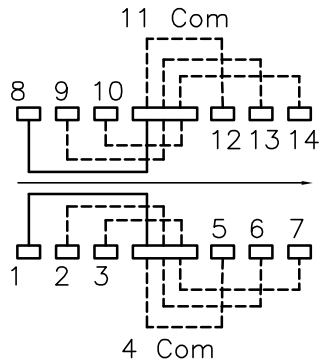

CIRCUIT: DP6T  
CONTACT CONFIGURATION

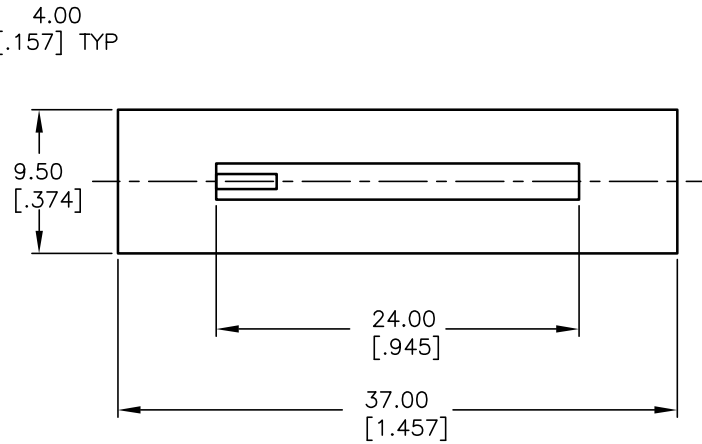
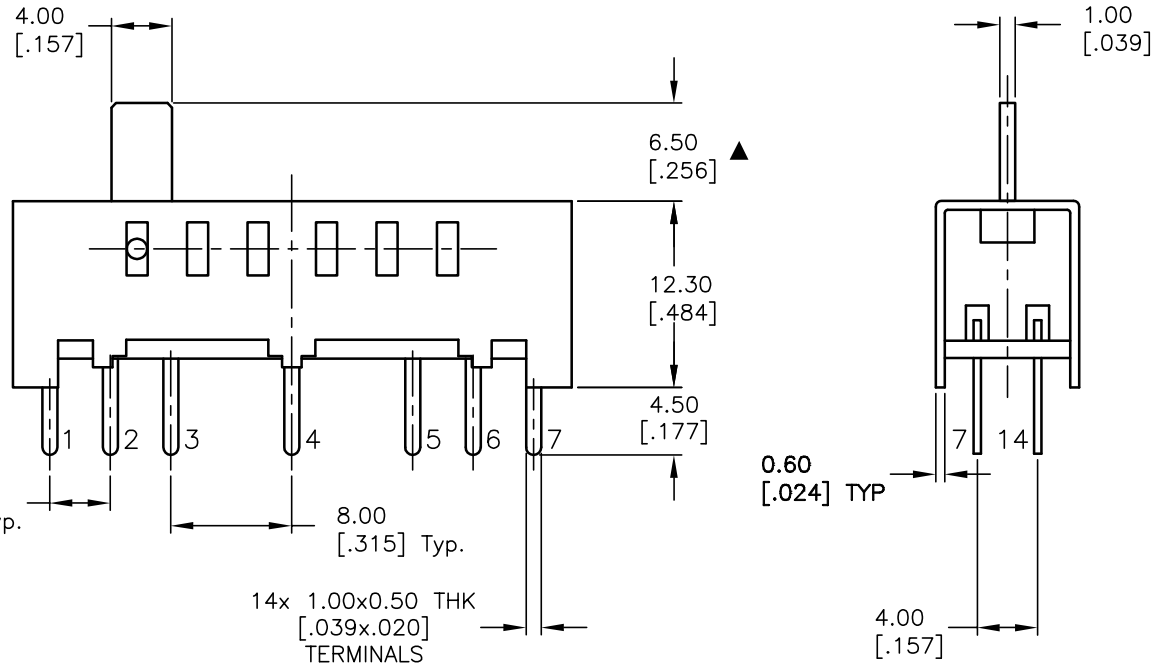

NOTES:

1. ALL DIMENSIONS IN MM [INCH]
2. GENERAL TOLERANCE: X.X=±0.4  
X.XX=±0.25
3. TERM. NOS. FOR REFERENCE ONLY.
4. RATING: 0.3A @30V DC
- ▲ 5. CONTACT MATERIAL: COPPER ALLOY W/ SILVER PLATE
6. CONTACT RESISTANCE: >20mΩ (INITIAL)
7. DIELECTRIC STRENGTH: 500V AC FOR 1 MIN
8. OPERATING LIFE: 10,000 CYCLES MIN
9. OPERATING FORCE: 300 ±100gf
10. TRAVEL: 4mm
11. OPERATING TEMP: -20°C TO +70°C
12. ▲ DENOTES CRITICAL PARAMETER.

**E-SWITCH®**

TITLE					EG2601C									
SCALE	2:1		DATE	8/26/03		DR	AR		DWG	P040288		REV	A	

A	13399	RELEASED FOR PRODUCTION	8/26/03	AR
REV.	ECN No.	DESCRIPTION	DATE	CHKD

THE INFORMATION CONTAINED IN THIS DOCUMENT IS PROPRIETARY TO E-SWITCH AND IS NOT TO BE COPIED OR TRANSFERRED