

THIS DRAWING IS UNPUBLISHED. RELEASED FOR PUBLICATION  
 © COPYRIGHT BY TYCO ELECTRONICS CORPORATION. ALL RIGHTS RESERVED.

| Loc |     | DIST          |  | REVISIONS |     |      |  |
|-----|-----|---------------|--|-----------|-----|------|--|
| P   | LTR | DESCRIPTION   |  | DATE      | DWN | APVD |  |
| A   |     | ECO 05 006799 |  | 27APR06   | BSV | SM   |  |

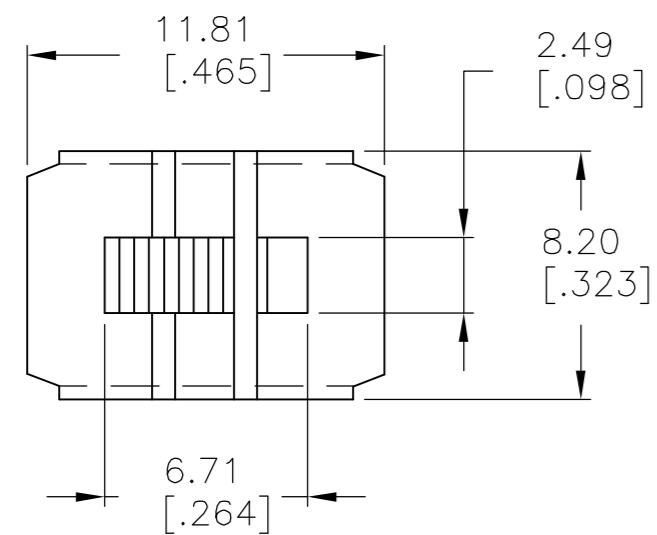

SPECIFICATIONS:  
 BREAK-BEFORE-MAKE

MATERIALS:  
 FRAME-STEEL, ZINC PLATE  
 ACTUATOR-PBT G30, BLACK  
 FIXED CONTACT/TERMINAL-COPPER ALLOY, SILVER OVER NICKEL PLATE  
 MOVING CONTACT-COPPER ALLOY, SILVER OVER NICKEL PLATE  
 COIL SPRING-STEEL WIRE  
 LEAF SPRING-COPPER ALLOY  
 TERMINAL BOARD-PHENOLIC, UL94HB

ELECTRICAL:  
 CONTACT RATING- 500 MILLIAMPS@125V AC  
 CONTACT RESISTANCE- 30 MILLIOHMS MAX (INITIAL), 60 MILLIOHMS AFTER TEST  
 INSULATION RESISTANCE- 500 MEGOHMS MIN AT SEA LEVEL  
 DIELECTRIC STRENGTH- 500 VAC RMS AT SEA LEVEL  
 LIFE EXPECTANCY- 10,000 CYCLES MIN, NO LOAD & 6,000 MIN AT RATED CURRENT

MECHANICAL:  
 ACTUATION FORCE- 350±200 GRAMS  
 TRAVEL- .106 (2.69 MM)

ENVIRONMENTAL:  
 OPERATING TEMPERATURE- -20°C TO +85°C  
 STORAGE TEMPERATURE- -40°C TO +100°C  
 RESISTANCE TO SOLDER HEAT- 260°C FOR 10 SEC PER 109-202, CONDITION B  
 SOLDERABILITY- PER EIA-364-56A, PROCEDURE 3, CONDITION B

- ALL MATERIALS AND FINISHES SHALL COMPLY WITH EU DIRECTIVE 2002/95/EC OF 27JAN2003 (ROHS)
- ANTI SOLDER WICK SEAL
- ALL PERFORMANCE SPECIFICATIONS WERE TESTED IN ACCORDANCE WITH JIS-C-5441 UNLESS OTHERWISE STATED.

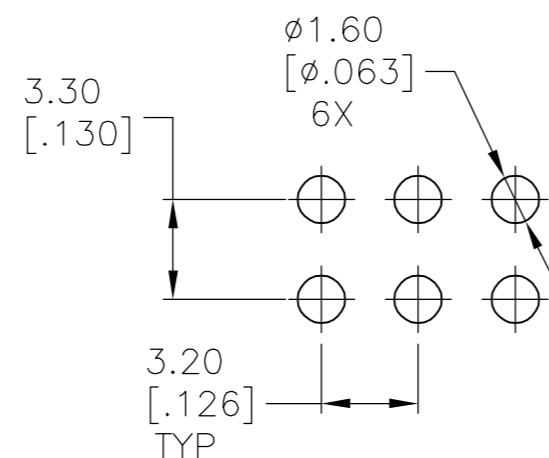
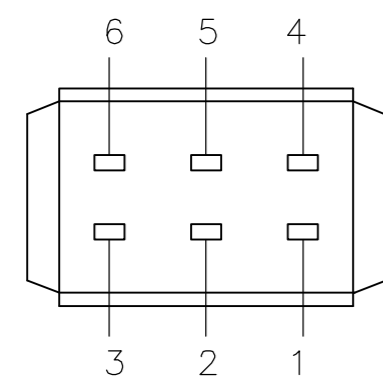
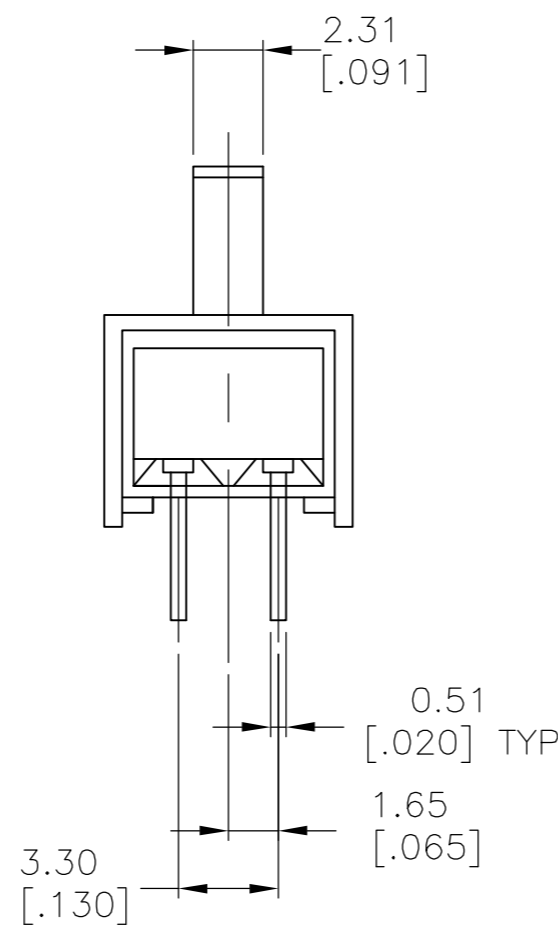
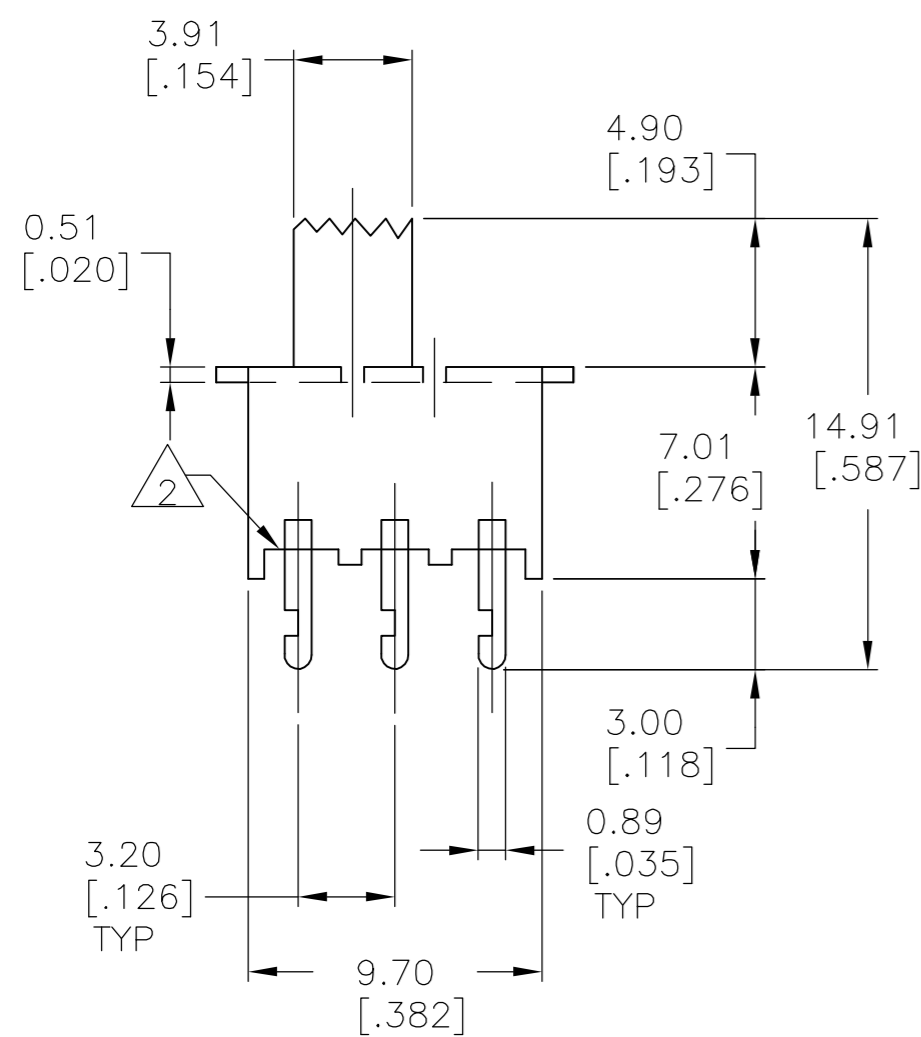

RECOMENDED HOLE LAYOUT  
 TOLERANCE ±.002 UNLESS OTHERWISE NOTED

|                   |            |                     |                     |
|-------------------|------------|---------------------|---------------------|
| 1-2<br>4-5        | 2-3<br>5-6 | SLS220104           | 1825079-1           |
| LEFT              | RIGHT      | ALCO<br>PART NUMBER | TYCO<br>PART NUMBER |
| ACTUATOR POSITION |            |                     |                     |

|  |  |                      |         |   |  |
|--|--|----------------------|---------|---|--|
| THIS DRAWING IS A CONTROLLED DOCUMENT. |  | DWN<br>BS VISWESWARA | 01MAR05 | Tyco Electronics Corporation<br>Harrisburg, Pa 17105-3608 |  |
| DIMENSIONS:<br>mm [INCHES]             |  | CHK<br>MS SARVER     |         | NAME  |  |
| TOLERANCES UNLESS OTHERWISE SPECIFIED: |  | APVD<br>-            |         | PRODUCT SPEC  |  |
| 0 PLC ± -                              |  |                      |         | APPLICATION SPEC  |  |
| 1 PLC ± -                              |  |                      |         | -   |  |
| 2 PLC ± -                              |  |                      |         | WEIGHT  |  |
| 3 PLC ± .010 [0.25]                    |  |                      |         | -   |  |
| 4 PLC ± -                              |  |                      |         | SIZE  |  |
| ANGLES ± -                             |  |                      |         | CAGE CODE   |  |
| FINISH                                 |  |                      |         | DRAWING NO  |  |
| -                                      |  |                      |         | RESTRICTED TO   |  |
|  |  |                      |         | -   |  |
|  |  |                      |         | SCALE   |  |
|  |  |                      |         | 4:1   |  |
|  |  |                      |         | SHEET   |  |
|  |  |                      |         | 1 OF 1  |  |
|  |  |                      |         | REV   |  |
|  |  |                      |         | A   |  |

1825079