

RECOMMENDED P.C.B. LAYOUT

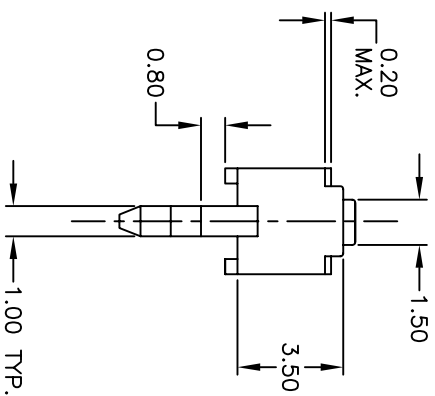
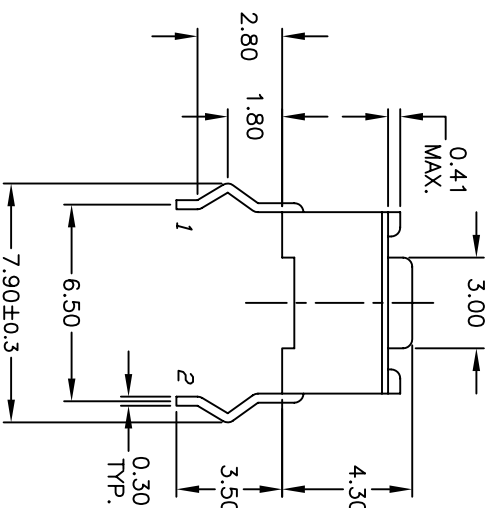
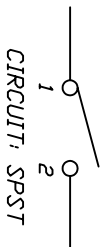
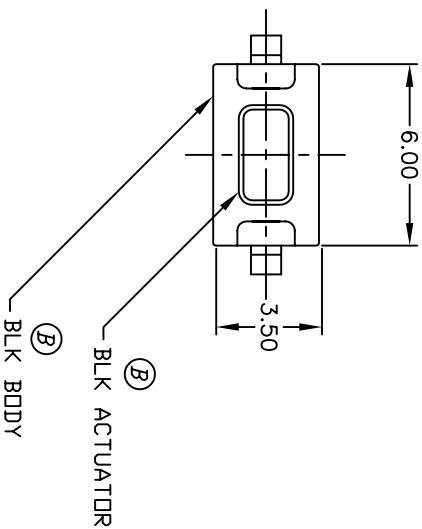

- NOTES:
1. ALL DIMENSIONS IN MM
 2. GENERAL TOLERANCE: X.X=±0.4
X.XX=±0.25
 3. TERM. NOS. FOR REFERENCE ONLY.
 4. RATINGS: 12VDC, 50mA
 5. OPERATING FORCE: 180±50gf
 6. TRAVEL: 0.25±0.1mm
 7. CONTACT RESISTANC: 100Ω Max.
 8. CONTACT MATERIAL: SILVER
 9. MECHANICAL/ELECTRICAL LIFE: 50,000 CYCLES
 10. PACKAGE: BULK
 11. 2002/95/EC (ROHS) COMPLIANT

REV.	ECN No.	DESCRIPTION	DATE	CHKD
D	16633	UPDATED NOTES	11/9/06	TN
C	13940	UPDATE TITLE TO ADD MATERIAL	4/19/04	AR
B	11519	ADD BLK BODY/ACTUATOR	5/31/01	CJB

		TITLE TL1107AF180WQ	
SCALE	4:1	DATE	11/9/2006
DR	TN	DWG	D310310
REV	D		

THE INFORMATION CONTAINED IN THIS DOCUMENT IS PROPRIETARY TO E-SWITCH AND IS NOT TO BE COPIED OR TRANSMITTED