

3.5 mm×2.9 mm SMD Light Touch Switches

Type: **EVPA**

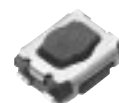

■ Features

- External dimensions : 3.5 mm×2.9 mm, Height 1.7 mm
- High operating force available
(Operating force : 5.0 N max.)
- Optional ground terminal

■ Recommended Applications

- Operation switches for portable electronic equipment
(Mobile phones, Digital still cameras, etc.)
- Operating switches for keyless entry systems

■ Explanation of Part Numbers

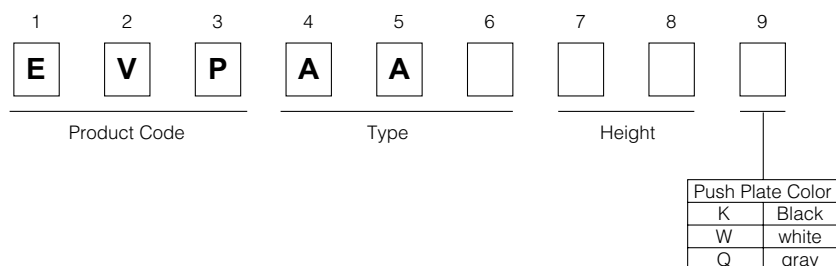

■ Specifications

| Type | | Snap action/Push-on type SPST |
|-------------------------------|---------------------------------|---|
| Electrical | Rating | 10 μ A 2 Vdc to 20 mA 15 Vdc (Resistive load) |
| | Contact Resistance | 100 m Ω max. |
| | Insulation Resistance | 100 M Ω min. (at 100 Vdc) |
| | Dielectric Withstanding Voltage | 250 Vac for 1 minute |
| | Bouncing | 10 ms max. (ON, OFF) |
| Mechanical | Operating Force | 1.0 N, 1.6 N, 2.4 N, 3.5 N, 5.0 N |
| | Travel | 0.15 mm±0.1 mm |
| Endurance | Operating Life | 1000000 cycles min. (1.0 N) 200000 cycles min. (1.6 N, 2.4 N, 3.5 N) 100000 cycles min. (5.0 N) |
| Operating Temperature | | −40 °C to +85 °C |
| Storage Temperature | | −40 °C to +85 °C (Bulk) −20 °C to +60 °C (Taping) |
| Minimum Quantity/Packing Unit | | 5000 pcs. Embossed Taping (Reel Pack) |
| Quantity/Cartron | | 25000 pcs. |

Note: Non washable

Design and specifications are each subject to change without notice. Ask factory for the current technical specifications before purchase and/or use.
Should a safety concern arise regarding this product, please be sure to contact us immediately.

Jan. 2008

■ Dimensions in mm (not to scale)

EVPAA

(Embossed Taping)

Thickness : 1.7 mm

With J-bent terminals

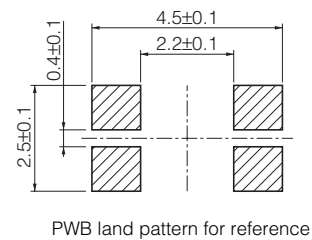
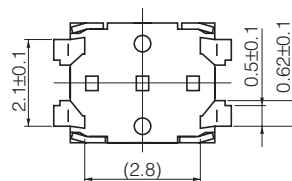
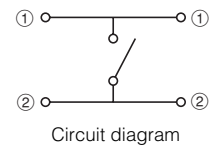
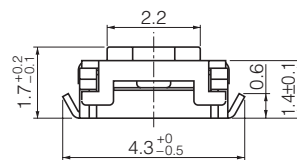
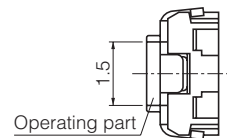
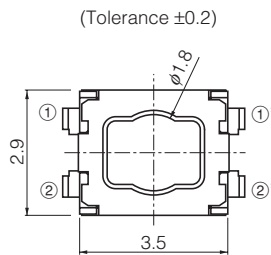
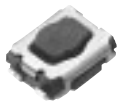

| Part Numbers | Ground Terminal | Operating Force | Push Plate Color | Operating Life |
|--------------|-----------------|-----------------|------------------|----------------|
| EVPAA002K | Without | 1.0 N | Black | 1000000 cycles |
| EVPAA102K | With | 1.0 N | Black | 1000000 cycles |
| EVPAA202K | Without | 1.6 N | Black | 200000 cycles |
| EVPAA302K | With | 1.6 N | Black | 200000 cycles |
| EVPAA402W | Without | 2.4 N | White | 200000 cycles |
| EVPAA502W | With | 2.4 N | White | 200000 cycles |
| EVPAA602W | Without | 3.5 N | White | 200000 cycles |
| EVPAA702W | With | 3.5 N | White | 200000 cycles |
| EVPAA802Q | Without | 5.0 N | Grey | 100000 cycles |
| EVPAA902Q | With | 5.0 N | Grey | 100000 cycles |

■ Recommended Reflow Soldering Conditions

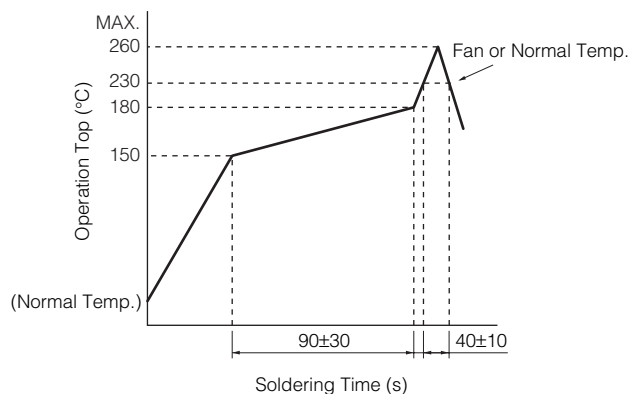

● Embossed Carrier Taping

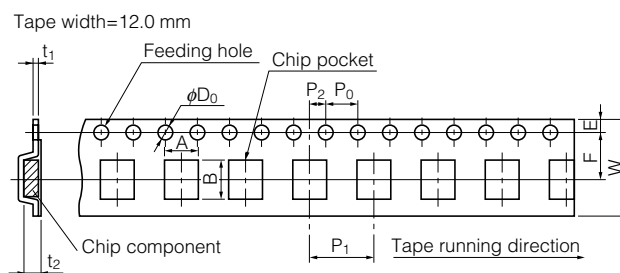

Unit: mm

| Part No. | Height | A | B | W | F | E | P1 | P2 | P0 | D0 Dia | t1 | t2 |
|----------|--------|---------|---------|----------|---------|-----------|---------|---------|---------|-----------------------------------|---------|-----------|
| EVPAA | 1.7 | 4.5±0.2 | 3.8±0.2 | 12.0±0.3 | 5.5±0.1 | 1.75±0.10 | 8.0±0.1 | 2.0±0.1 | 4.0±0.1 | 1.5 ^{+0.1} ₋₀ | 0.3±0.1 | 1.85±0.20 |

● Standard Reel Dimensions in mm (not to scale)

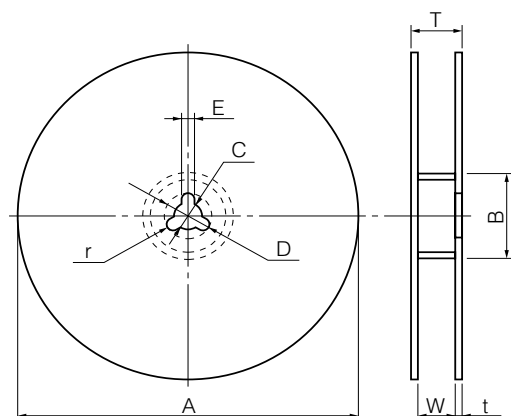

| Item | A | B | C | D | E |
|-----------|------------|-----------|-----------|-----------|---------|
| Rate (mm) | φ380.0±2.0 | φ80.0±1.0 | φ13.0±0.2 | φ21.0±0.8 | 2.0±0.5 |

| Item | W | T | t | r |
|-----------|----------|----------|---|---|
| Rate (mm) | 13.5±1.0 | 17.5±1.0 | — | — |

■ Recommended Shape of Test Pole

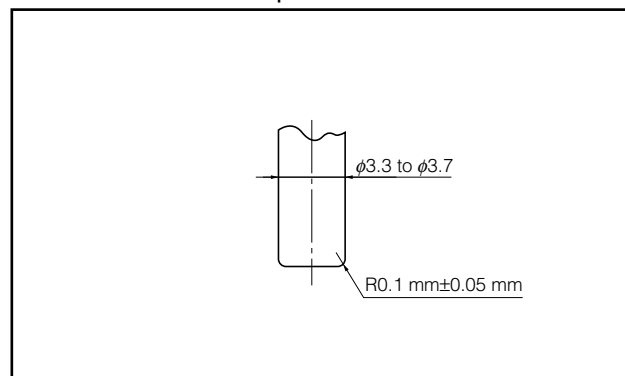

■ Recommended Operating Conditions

