

RECOMMEND P.C.B. LAYOUT

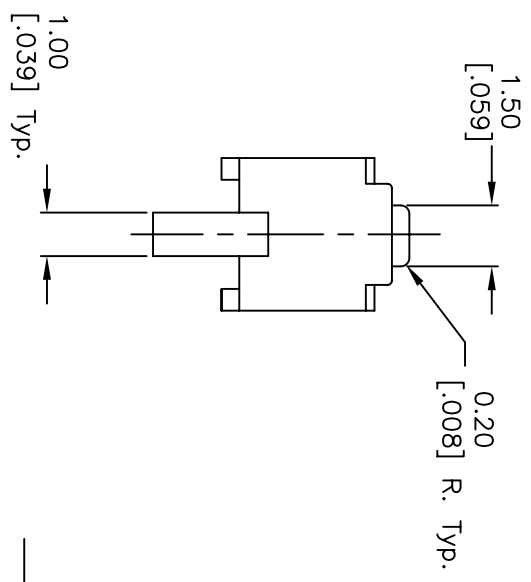
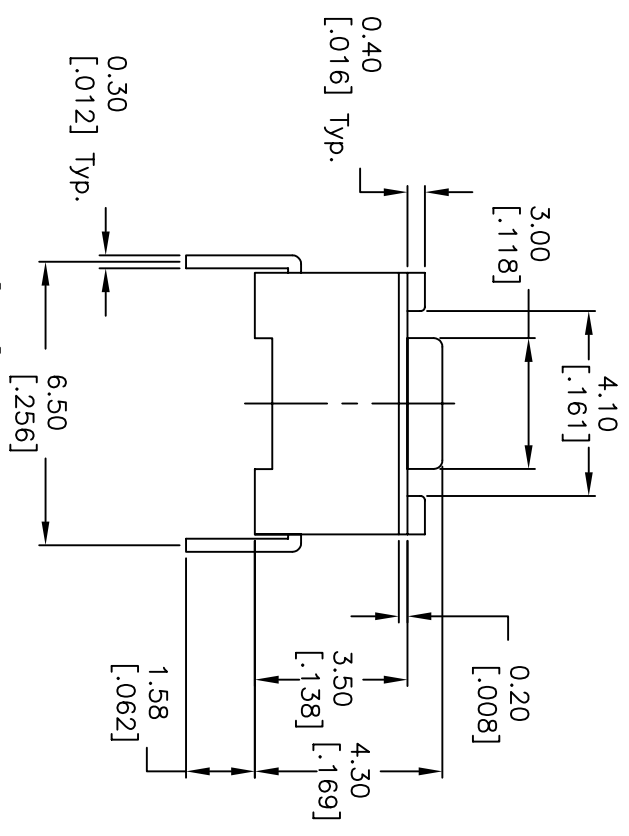

CIRCUIT: SPST  
CONTACT CONFIGURATION

- NOTES:
1. ALL DIMENSIONS IN MM [INCH]
  2. GENERAL TOLERANCE: 0.0=±0.4  
0.00=±0.25
  3. TERM. NOS. FOR REF. ONLY
  4. RATING: 50ma @12V DC
  5. TRAVEL: 0.25±0.1mm
  6. OPERATING FORCE: 260±50gf
  7. CONTACT RESISTANCE: 100m ohm max.
  8. MECHANICAL/ELECTRICAL LIFE: 30,000 CYCLES
  9. PACKAGE: BULK 1,000 PER BAG
  10. 2002/95/EC (ROHS) COMPLIANT

B	16616	UPDATED NOTES	11/7/06	TN
A	12723	RELEASED FOR PRODUCTION	1/13/03	CB
REV.	ECN NO.	DESCRIPTION	DATE	CHKD

TITLE		SCALE	DATE	DR	DWG	REV
E-SWITCH® TL1107AF260BQ		5:1	11/7/2006	TN	P010383	B

THE INFORMATION CONTAINED IN THIS DOCUMENT IS PROPRIETARY TO E-SWITCH AND IS NOT TO BE COPIED OR TRANSMITTED